

| | | | | |
|---------------------|-----------|---------------------------|--------------|-----------|
| F.A.I. RTE. | SECTION | COUNTY | TOTAL SHEETS | SHEET NO. |
| 57/64 | (41-3)HBK | JEFFERSON | 518 | 216 |
| STA. | | TO STA. | | |
| FED. ROAD DIST. NO. | | ILLINOIS FED. AID PROJECT | | |
| CONTRACT NO. 98963 | | | | |

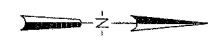

Copyright Hanson Professional Services Inc. 2007
HANSON
 Hanson Professional Services Inc.

03/21/2007, 11:24 AM
 I:\98 Jobs\98963\98963\Road\Sheet\04_Plan.dwg

| | | |
|----------|-----|----------|
| LAYOUT | RLT | 02/25/04 |
| DRAWN | REO | 04/27/04 |
| REVIEWED | MTW | 03/22/07 |

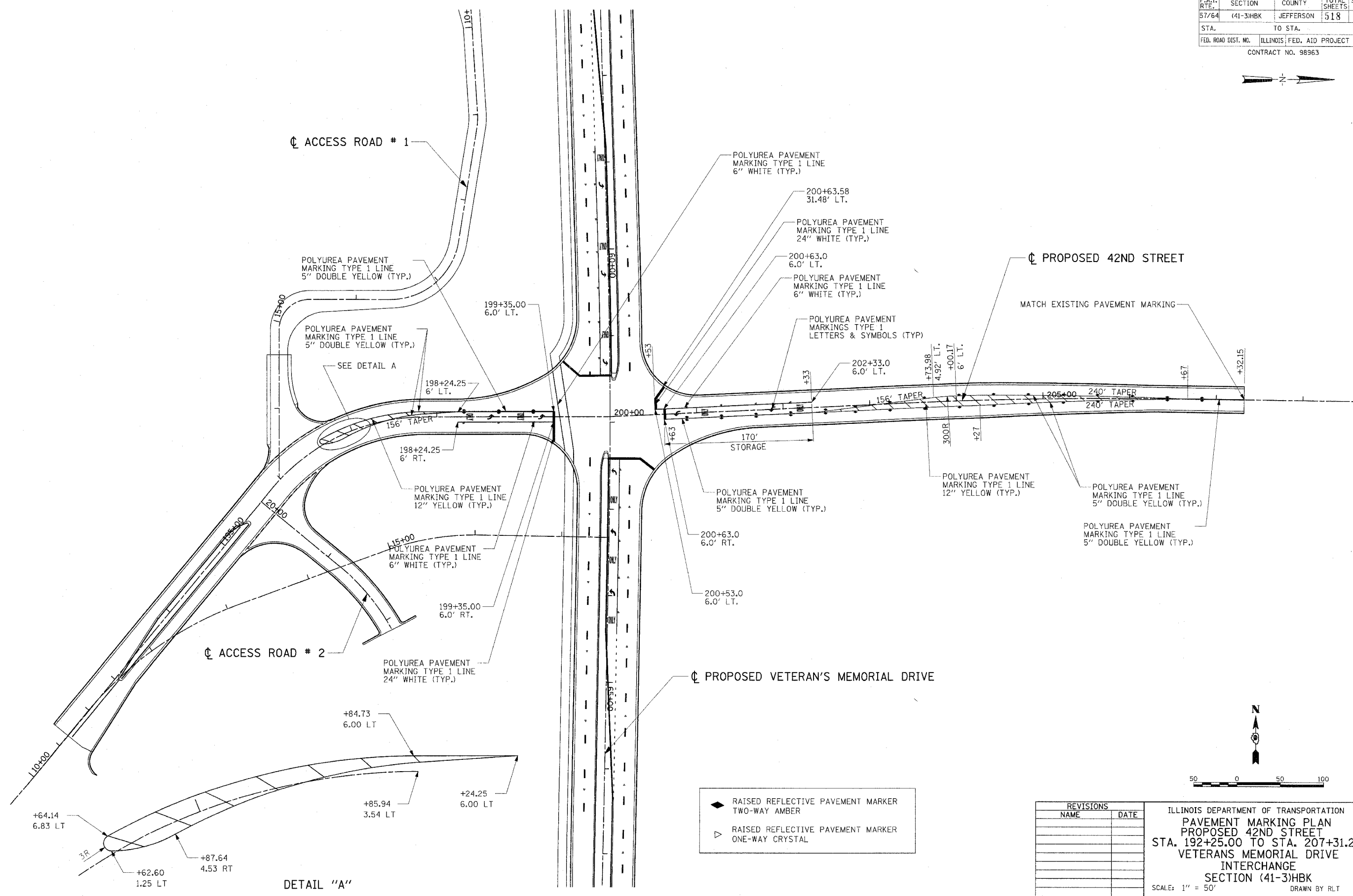

DETAIL "A"

- ◆ RAISED REFLECTIVE PAVEMENT MARKER TWO-WAY AMBER
- ▽ RAISED REFLECTIVE PAVEMENT MARKER ONE-WAY CRYSTAL

| REVISIONS | |
|-----------|------|
| NAME | DATE |
| | |
| | |
| | |
| | |
| | |
| | |
| | |
| | |
| | |
| | |

ILLINOIS DEPARTMENT OF TRANSPORTATION
PAVEMENT MARKING PLAN
PROPOSED 42ND STREET
STA. 192+25.00 TO STA. 207+31.25
VETERANS MEMORIAL DRIVE
INTERCHANGE
SECTION (41-3)HBK
 SCALE: 1" = 50'
 DATE 3-22-07
 DRAWN BY RLT
 CHECKED BY MTM

