

F.A.I. RTE.	SECTION	COUNTY	TOTAL SHEETS	SHEET NO.
57/64	(41-3)HBK	JEFFERSON	235	235
STA.		TO STA.		
FED. ROAD DIST. NO.		ILLINOIS	FED. AID PROJECT	

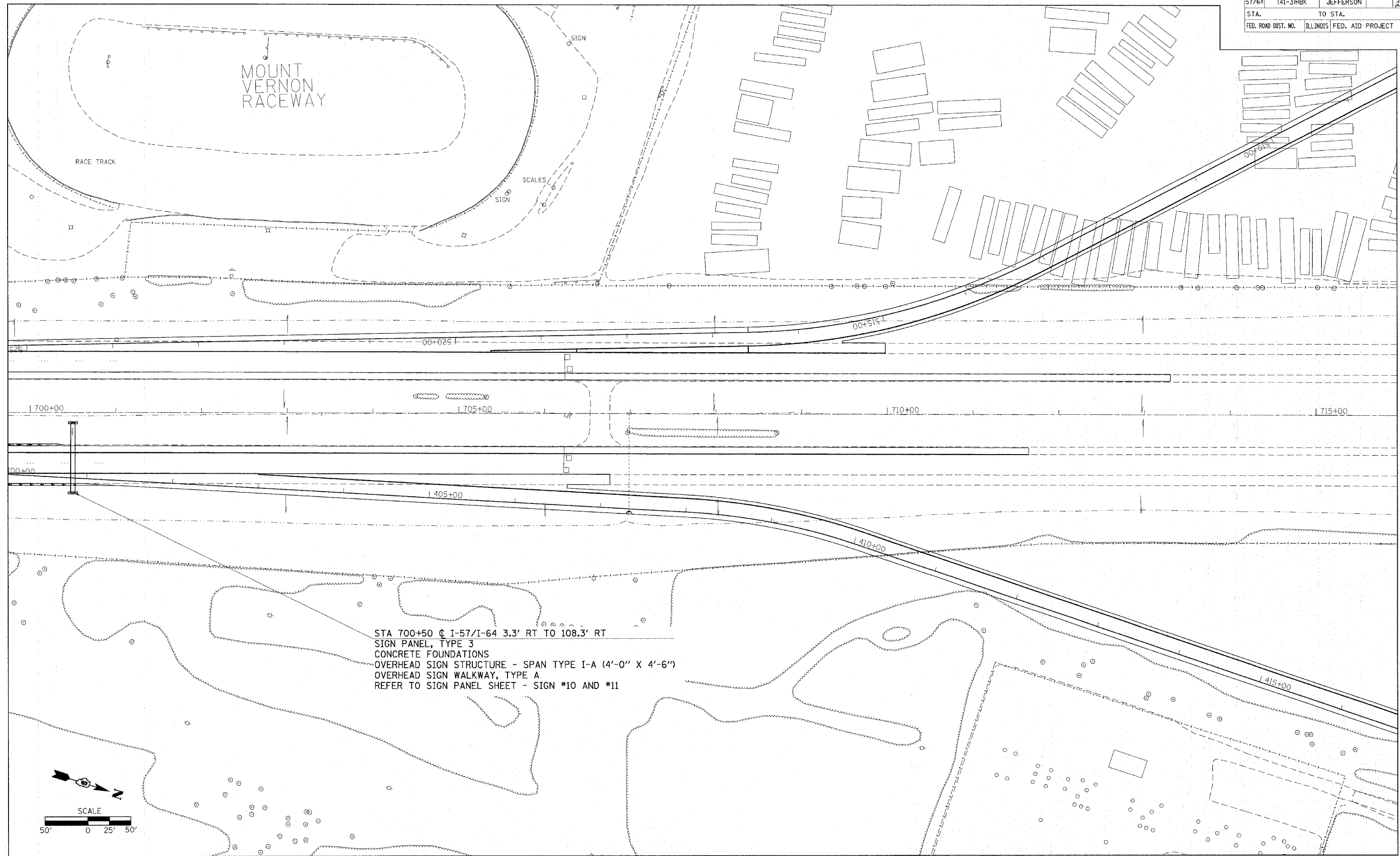

STA 700+50 @ I-57/I-64 3.3' RT TO 108.3' RT  
 SIGN PANEL, TYPE 3  
 CONCRETE FOUNDATIONS  
 OVERHEAD SIGN STRUCTURE - SPAN TYPE I-A (4'-0" X 4'-6")  
 OVERHEAD SIGN WALKWAY, TYPE A  
 REFER TO SIGN PANEL SHEET - SIGN #10 AND #11

5/11/2007  
 c:\projects\98963\98963.dwg  
 4/19/07 7:11 AM  
 jason.l...