

F.A.I. RTE.	SECTION	COUNTY	TOTAL SHEETS	SHEET NO.
57/64	41-3HBK	JEFFERSON	518	236
STA.		TO STA.		
FED. ROAD DIST. NO.		ILLINOIS FED. AID PROJECT		

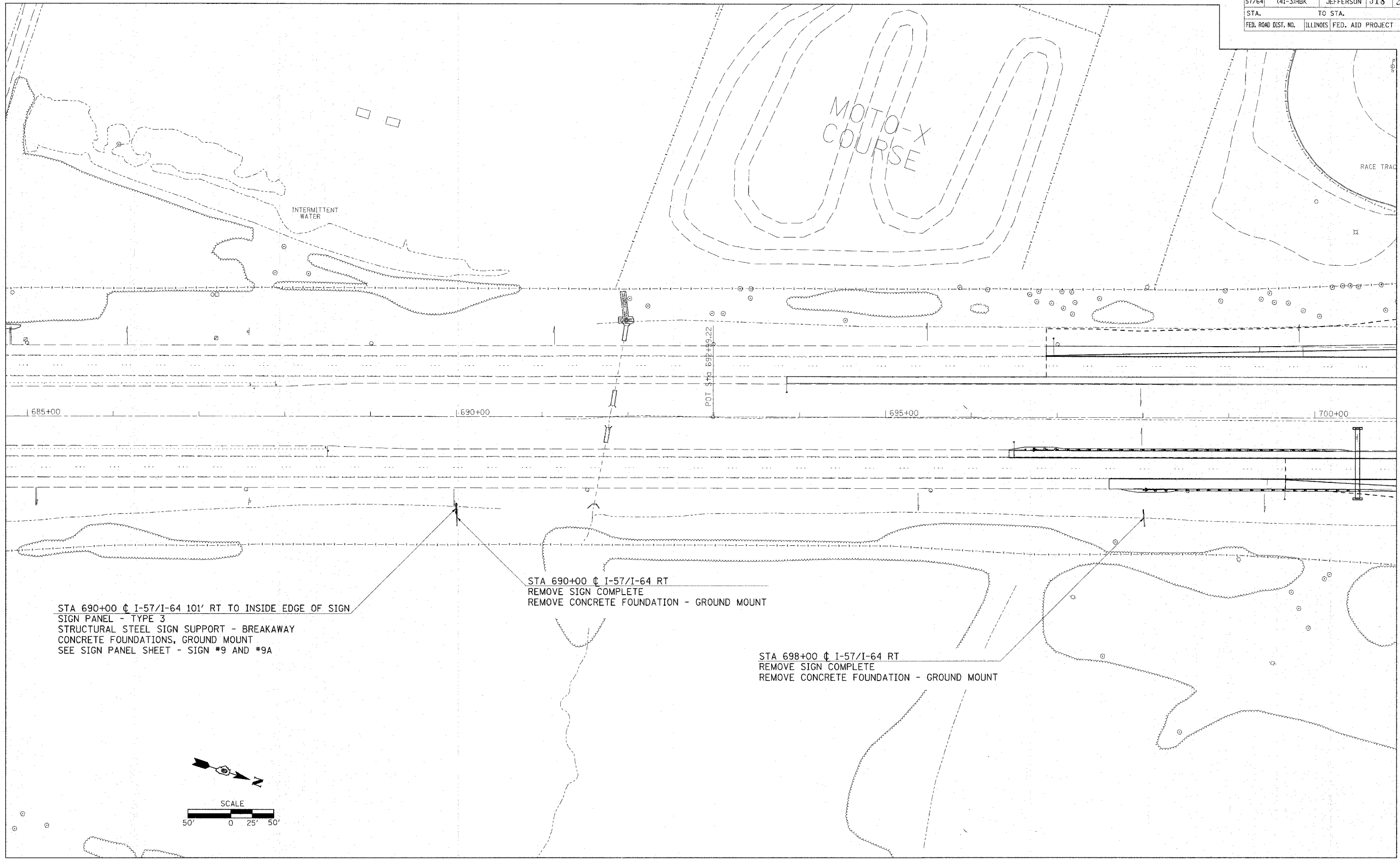

STA 690+00  $\oslash$  I-57/I-64 101' RT TO INSIDE EDGE OF SIGN  
SIGN PANEL - TYPE 3  
STRUCTURAL STEEL SIGN SUPPORT - BREAKAWAY  
CONCRETE FOUNDATIONS, GROUND MOUNT  
SEE SIGN PANEL SHEET - SIGN #9 AND #9A

STA 690+00  $\oslash$  I-57/I-64 RT  
REMOVE SIGN COMPLETE  
REMOVE CONCRETE FOUNDATION - GROUND MOUNT

STA 698+00  $\oslash$  I-57/I-64 RT  
REMOVE SIGN COMPLETE  
REMOVE CONCRETE FOUNDATION - GROUND MOUNT

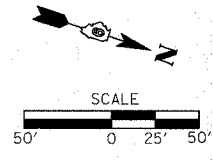

03 JUN 2007 09:05 AM  
58.0000' / IN.  
KST