

F.A.I. RTE.	SECTION	COUNTY	TOTAL SHEETS	SHEET NO.
57/64	(41-3)HBK	JEFFERSON		237
STA. TO STA.		FED. ROAD DIST. NO. ILLINOIS FED. AID PROJECT		

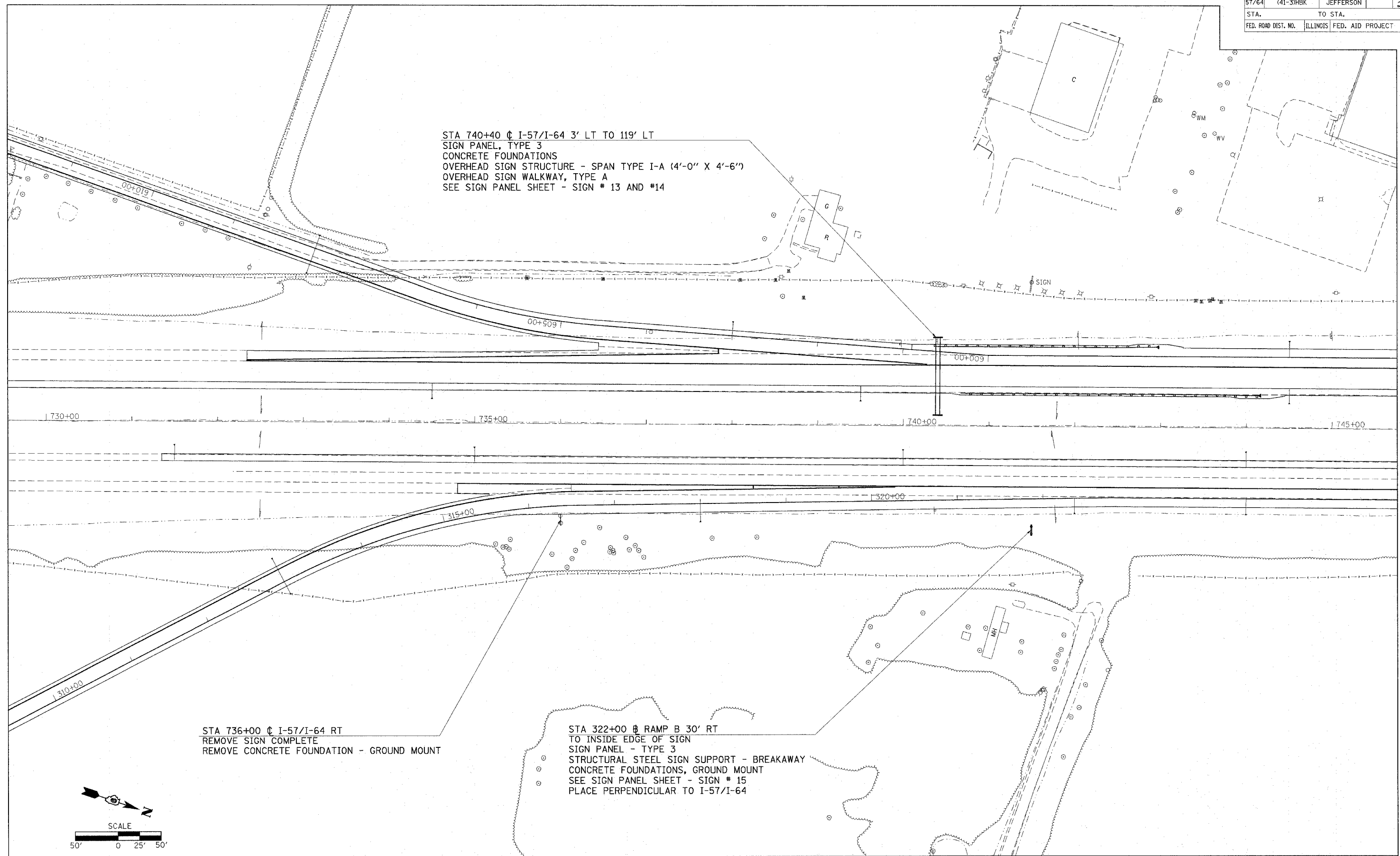

STA 740+40 @ I-57/I-64 3' LT TO 119' LT
 SIGN PANEL, TYPE 3
 CONCRETE FOUNDATIONS
 OVERHEAD SIGN STRUCTURE - SPAN TYPE I-A (4'-0" X 4'-6")
 OVERHEAD SIGN WALKWAY, TYPE A
 SEE SIGN PANEL SHEET - SIGN # 13 AND #14

STA 736+00 @ I-57/I-64 RT
 REMOVE SIGN COMPLETE
 REMOVE CONCRETE FOUNDATION - GROUND MOUNT

STA 322+00 @ RAMP B 30' RT
 TO INSIDE EDGE OF SIGN
 SIGN PANEL - TYPE 3
 STRUCTURAL STEEL SIGN SUPPORT - BREAKAWAY
 CONCRETE FOUNDATIONS, GROUND MOUNT
 SEE SIGN PANEL SHEET - SIGN # 15
 PLACE PERPENDICULAR TO I-57/I-64

5/11/2007
 c:\projects\98963\98963.dwg
 4:49:00 / JL
 rasmilist