

| | | | | |
|---------------------|---------------------------|-----------|--------------------|-----------|
| F.A.I. RTE. | SECTION | COUNTY | TOTAL SHEETS | SHEET NO. |
| 57/64 | (41-3)HBK | JEFFERSON | 18 | 280 |
| STA. | TO STA. | | | |
| FED. ROAD DIST. NO. | ILLINOIS FED. AID PROJECT | | CONTRACT NO. 98963 | |

Sheet 10 of 25

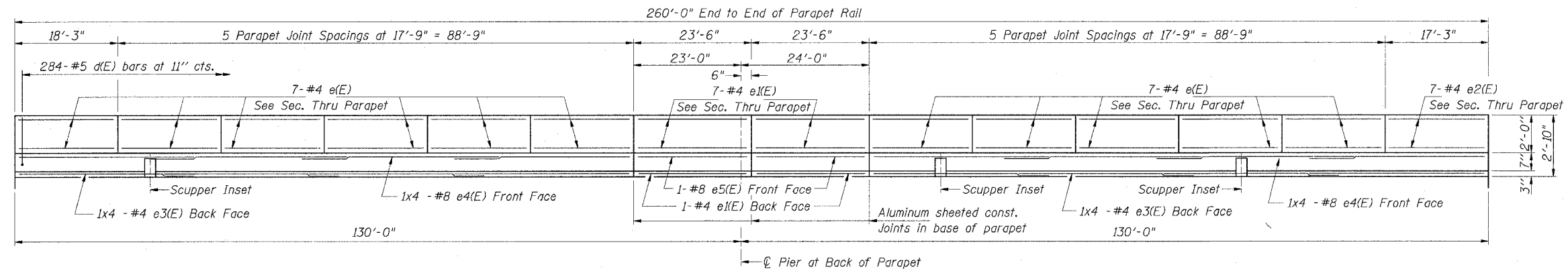

INSIDE ELEVATION - NORTH ROADWAY PARAPET
(All dimensions are measured along back face of parapet.)

* Cost included with Concrete Superstructure

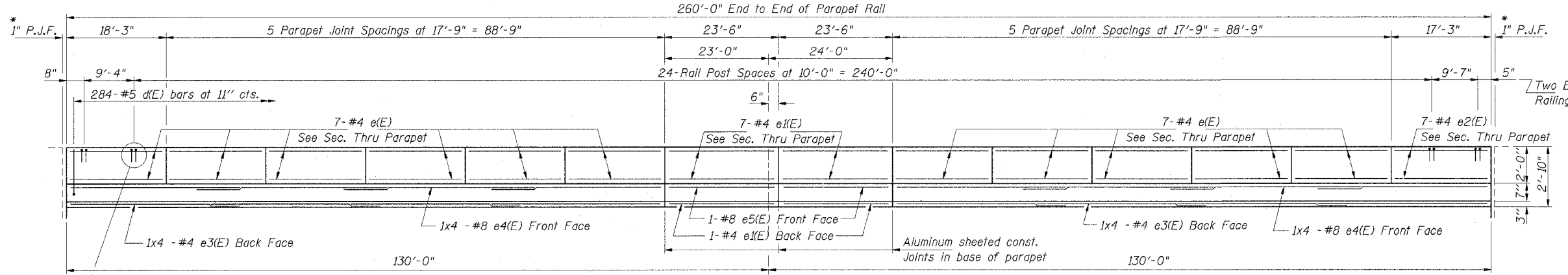

INSIDE ELEVATION - SOUTH ROADWAY PARAPET
(All dimensions are measured along back face of parapet.)

Two Element Parapet Bicycle Railing - Post Spaces

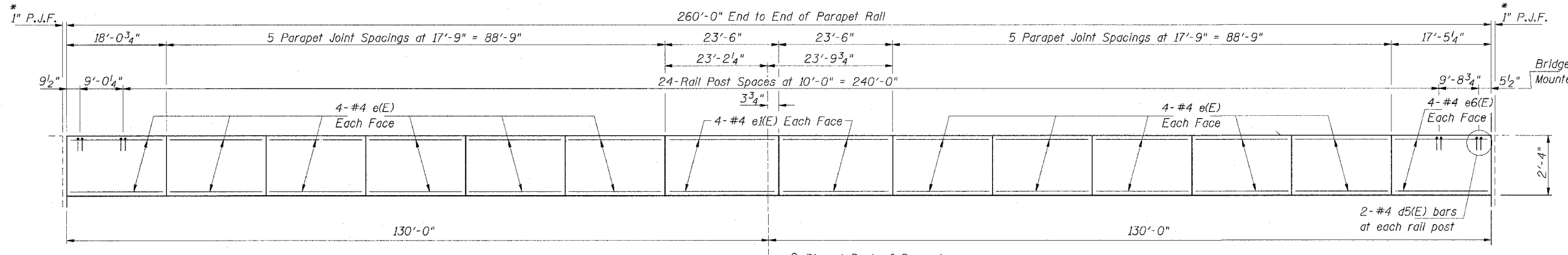

INSIDE ELEVATION - WALKWAY PARAPET
(All dimensions are measured along back face of parapet.)

Bridge Fence Railing Parapet Mounted - Rail Post Spaces

BAR LAPS
#4 = 1'-8"
#8 = 4'-6"

Note:
Space reinforcement to miss railing anchor bolts.

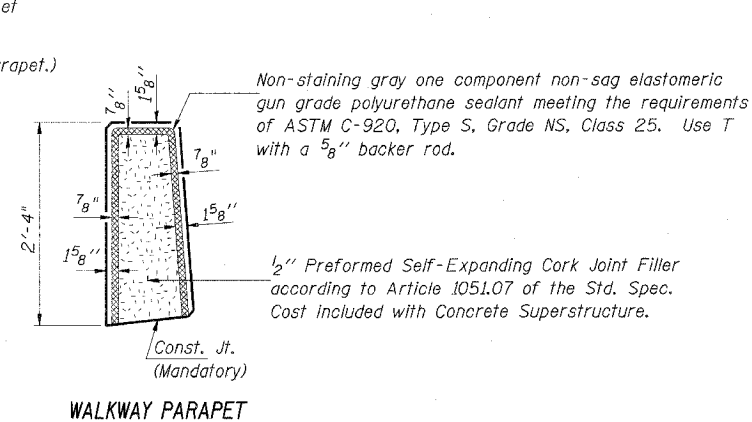
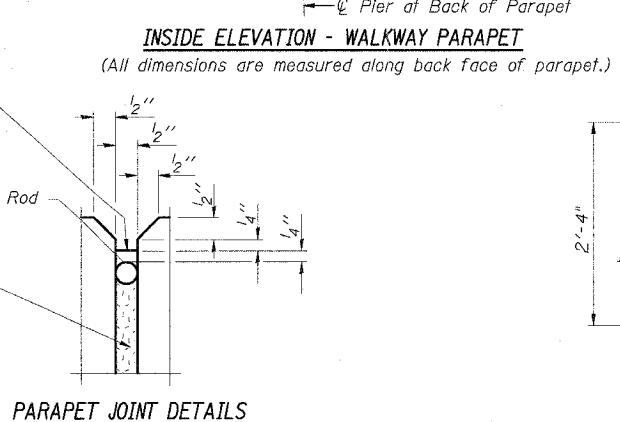
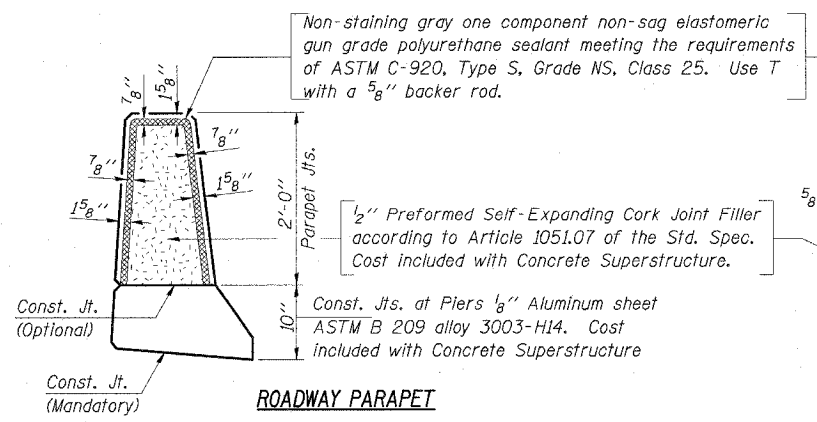

PARAPET DETAILS
VETERANS MEMORIAL DR. over F.A.I. ROUTES 57/64
SECTION (41-3)HBK
JEFFERSON COUNTY
STATION 49+72.27
STRUCTURE NO. 041-0108

March 2007 Submittal
03/20/2007 10:45 AM
I:\9810es\98s2019a\Struct\Sheet\Draw Plans\03-14-07-041-0108.dwg

| | | |
|----------|----------|----------|
| LAYOUT | MM | 03/27/07 |
| DRAWN | DHB | 03/27/07 |
| REVIEWED | TEH | 02/02/04 |
| DATE | 02/02/04 | |