

F.A.I. RTE.	SECTION	COUNTY	TOTAL SHEETS	SHEET NO.
57/64	141-3HBK	JEFFERSON	518	436
STA. +80,000 TO STA. +90,000				
FED. ROAD DIST. NO.		ILLINOIS	FED. AID PROJECT	

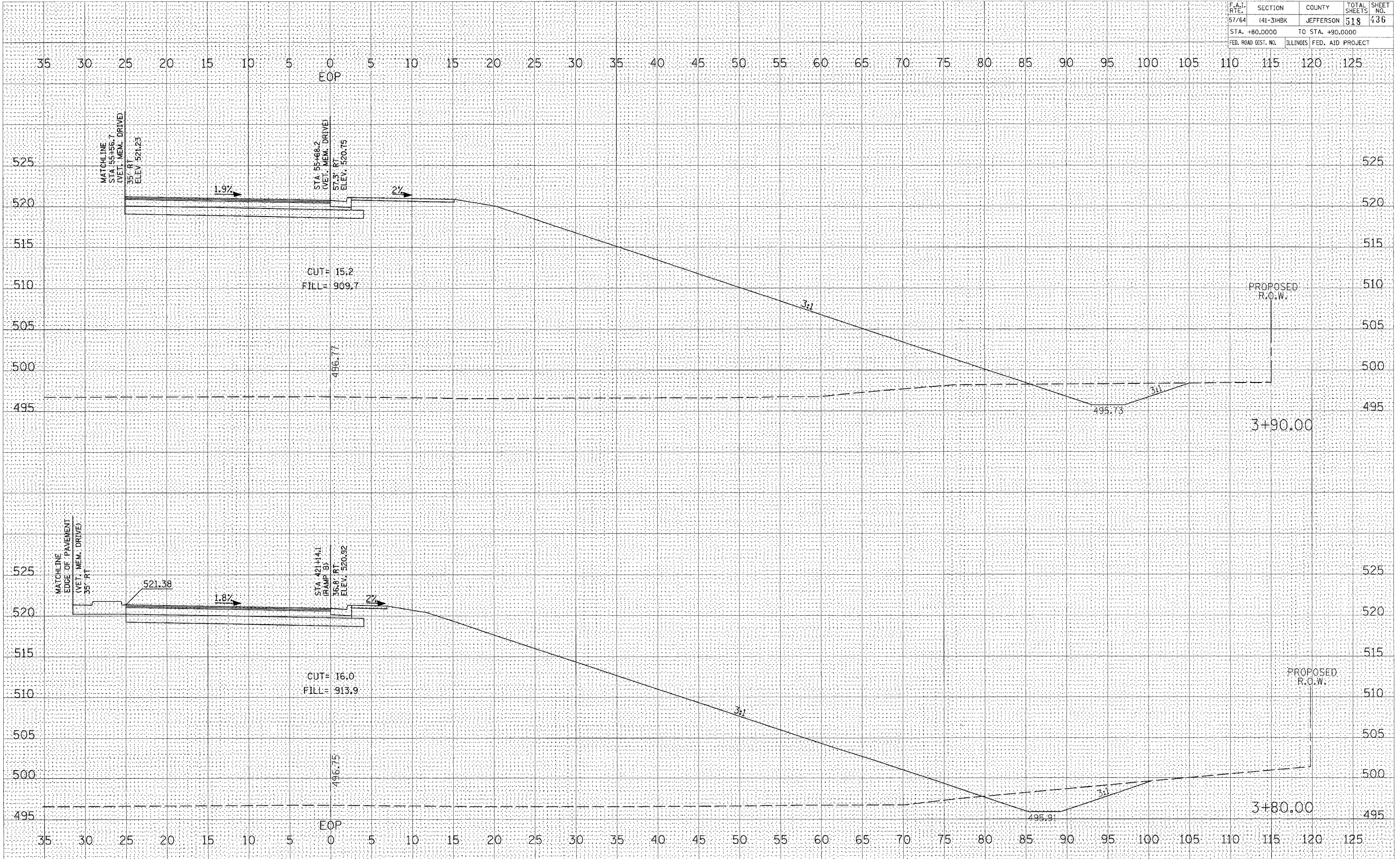

CROSS SECTIONS - RAMP B SE QUAD RADIUS

FINAL SURVEY DATE  
 SURVEYED BY  
 NOTE BOOK NO.  
 AREAS CHECKED

ORIGINAL SURVEY DATE  
 SURVEYED BY  
 NOTE BOOK NO.  
 AREAS CHECKED

PLOT DATE = 03/22/2007 11:59 AM  
 FILE NAME = I:\98963\98963\DOT RAMP B SE QUAD RADIUS\PLT1.DWG  
 PLOT SCALE = 5.0000 / IN.  
 USER NAME = ket