

CONTRACT NO. 98963			
F.A.I. RTE.	SECTION	COUNTY	TOTAL SHEET NO.
57/64	141-318K	JEFFERSON	518 437
STA. 1+00.0000		TO STA. 1+10.0000	
FED. ROAD DIST. NO.	ILLINOIS	FED. AID PROJECT	

DATE	BY
FINAL SURVEY	
SURVEYED	
NOTE BOOK	
NO.	
AREAS CHECKED	

DATE	BY
ORIGINAL SURVEY	
SURVEYED	
NOTE BOOK	
NO.	
AREAS CHECKED	

PLOT DATE = 8/3/2007 11:58 AM
 FILE NAME = I:\8181\8181\8181\DOT RAMP B SE QUAD RADIUS.DWG
 PLOT SCALE = 0.0008 / IN.
 USER NAME = kst

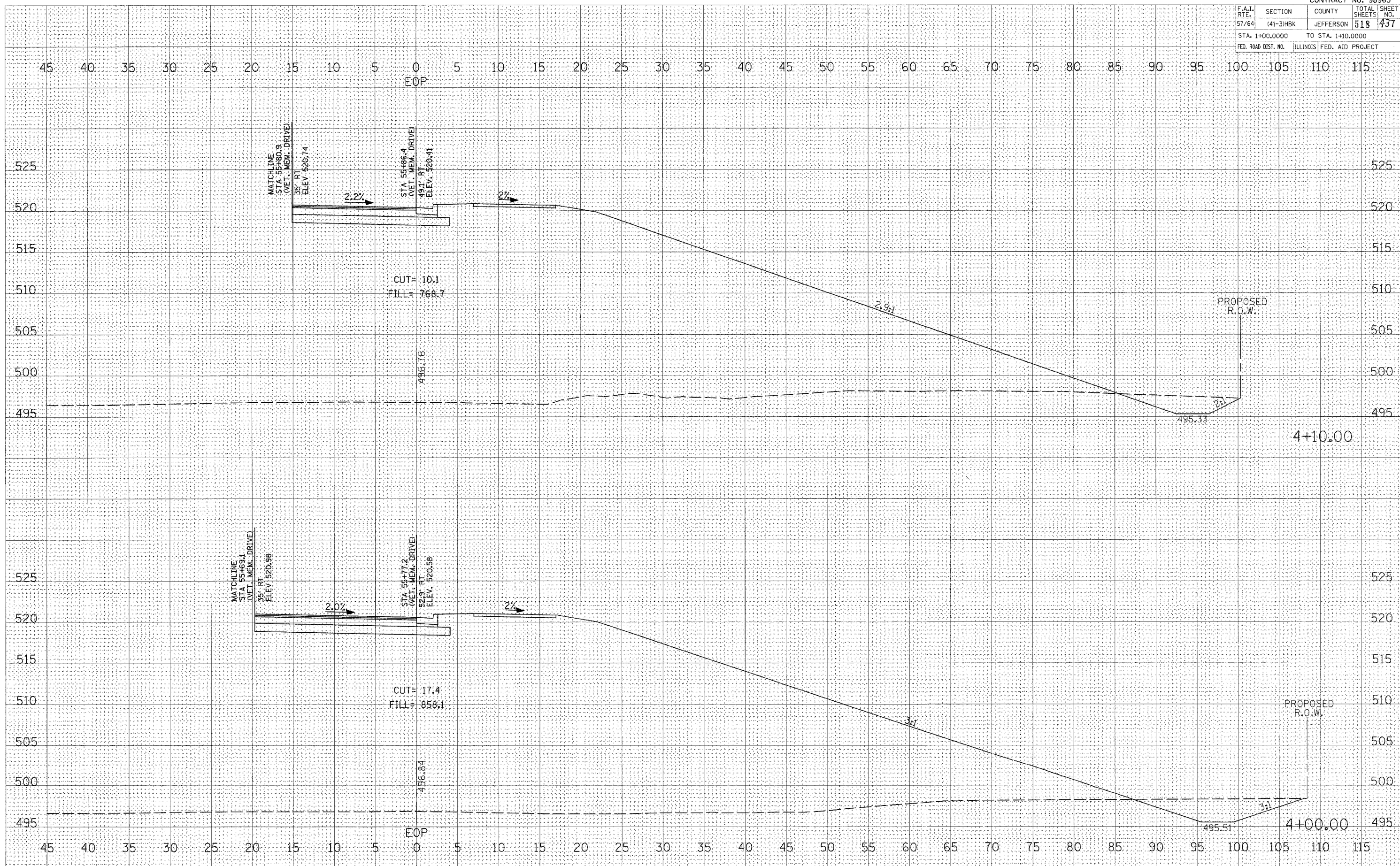

CROSS SECTIONS - RAMP B SE QUAD RADIUS