

STATE OF ILLINOIS
DEPARTMENT OF TRANSPORTATION
PLANS FOR PROPOSED

SURFACE TRANSPORTATION PROGRAM

FAS ROUTE 924 (LICK CREEK ROAD)
SECTION 05-00095-00-RS
PROJECT NO. RS-924 (122)
JOB NO. C-99-518-05

ROUTE	SECTION	COUNTY	TOTAL SHEETS	SHEET NO.
FAS 924	05-00095-00-RS	UNION	5	1
PROJECT NO. RS-924 (122)			CONTRACT NO. 99277	

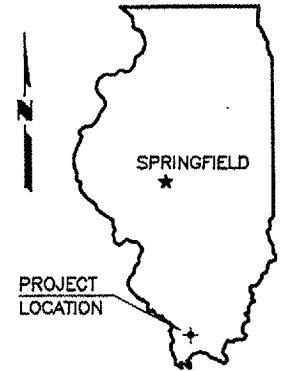

SUMMARY OF QUANTITIES

CODE NO.	PAY ITEM	UNIT	TOTAL
40200800*	AGGREGATE SURFACE COURSE, TYPE B	TON	50
40600100	BITUMINOUS MATERIALS (PRIME COAT)	GALLON	2,110
40600300	AGGREGATE (PRIME COAT)	TON	32
40600635	LEVELING BINDER (MACHINE METHOD), N70	TON	4,590
40603315	HOT-MIX ASPHALT SURFACE COURSE, MIX "C", N70	TON	5,060
44300100*	AREA REFLECTIVE CRACK CONTROL TREATMENT	SQ YD	112
48101200	AGGREGATE SHOULDERS, TYPE B	TON	1,660
67100100*	MOBILIZATION	L SUM	1
70300100	SHORT-TERM PAVEMENT MARKING	FOOT	5,092
70300220	TEMPORARY PAVEMENT MARKING - LINE 4"	FOOT	81,670
72000100	SIGN PANEL - TYPE 1	SQ FT	241.1
72800100	TELESCOPING STEEL SIGN SUPPORT	FOOT	711.5
△ 78001110	PAINT PAVEMENT MARKING - LINE 4"	FOOT	86,710
△ 78100100	RAISED REFLECTIVE PAVEMENT MARKER	EACH	343
△ 78100105	RAISED REFLECTIVE PAVEMENT MARKER (BRIDGE)	EACH	4

* SEE SPECIAL PROVISIONS
△ SPECIALTY ITEMS

UNION COUNTY

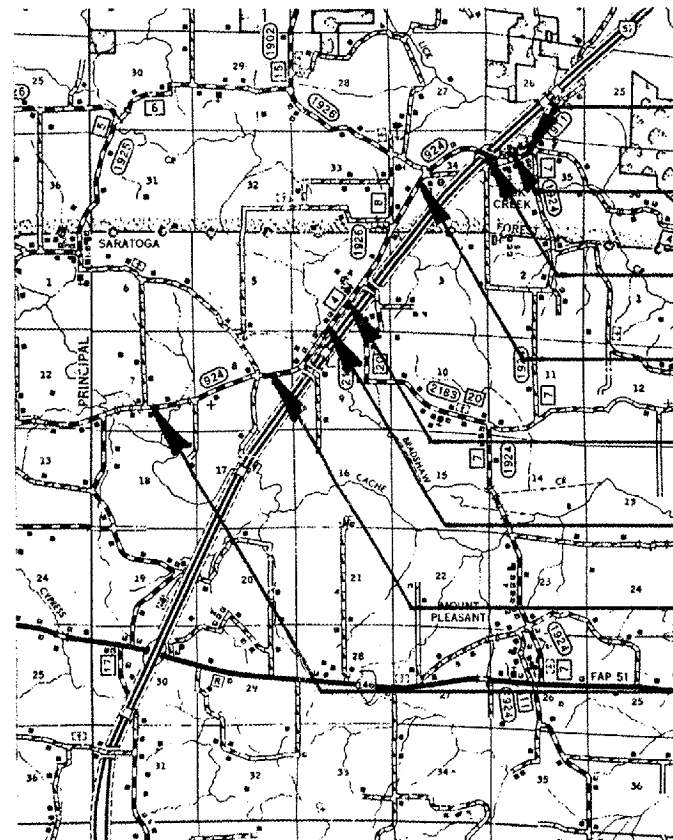

END IMPROVEMENT
STATION 539+80

EQ. STA. 526+00.00 BACK
= STA. 526+44.07 AHEAD

OMISSION
STA. 506+10 - STA. 518+70

EQ. STA. 467+50.70 BACK
= STA. 468+00.00 AHEAD

EQ. STA. 389+99.96 BACK
= STA. 390+17.40 AHEAD

EQ. STA. 368+83.90 BACK
= STA. 368+79.53 AHEAD

EQ. STA. 331+59.49 BACK
= STA. 331+65.50 AHEAD

BEGIN IMPROVEMENT
STATION 261+00

INDEX OF SHEETS

- COVER SHEET
- TYPICAL SECTIONS
- RESURFACING SCHEDULE
- TYPICAL SIDE ROAD & ENTRANCE DETAILS
- MISCELLANEOUS DETAILS
 - STANDARDS 701001-01 TRAFFIC CONTROL
 - 701006-02 TRAFFIC CONTROL
 - 701011-01 TRAFFIC CONTROL
 - 701301-02 TRAFFIC CONTROL
 - 701306-01 TRAFFIC CONTROL
 - 701311-02 TRAFFIC CONTROL
 - 701501-03 TRAFFIC CONTROL
 - 702001-06 TRAFFIC CONTROL DEVICES
 - 720001 SIGN PANEL MOUNTING DETAILS
 - 720006-01 SIGN PANEL ERECTION DETAILS
 - 780001-01 TYPICAL PAVEMENT MARKINGS
 - 781001-02 RAISED REFLECTIVE PAVEMENT MARKERS
 - BLR 24-1 MAILBOX TURNOUTS

CLASSIFICATION : COLLECTOR
ADT : 2035
DESIGN SPEED : 50 MPH

ILLINOIS DEPARTMENT OF TRANSPORTATION	
Approved	<i>April 5, 2007</i> <i>Bill R. Boyle</i> Union County Engineer
Passed	<i>April 11, 2007</i> <i>Dennis W. Hill</i> District 9 Engineer of Local Roads and Streets
Releasing for Bid Based on Limited Review	<i>April 11, 2007</i> <i>Mary C. Lane</i> Deputy Director of Highways, Region 5 Engineer

LOCATION MAP

SCALE: 1" = 2 MILES

NET LENGTH OF IMPROVEMENT = 26,507.55 FT. = 5.0204 MILES

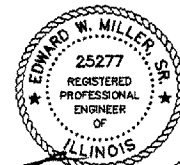

Edward W. Miller
Edward W. Miller
PROFESSIONAL ENGINEER
#062-025277
EXPIRES NOV. 30, 2007

CONTRACT NO. 99277

E. MILLER ENGINEERING, INC.
CONSULTING ENGINEERS
HARRISBURG, ILLINOIS