

HAROLD BEERS
N.W. 1/4, N.W. 1/4, SEC. 25, T. 8 S., R. 4 E., 3RD P.M.

J.L. SPRAGUE
N.E. 1/4, N.W. 1/4, SEC. 25, T. 8 S., R. 4 E., 3RD P.M.

F.A. RTE.	SECTION	COUNTY	TOTAL SHEETS	SHEET NO.
167	04-01225-00-BR	WILLIAMSON	16	3
STA. 12+00		TO STA. 18+50		
ROAD DIST.		ILLINOIS		
CONTRACT No. 99299				

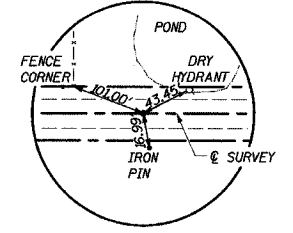
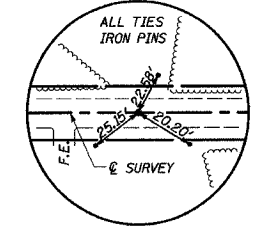

P.O.T. STA. 12+00.00
IRON PIN (FLUSH)

P.O.T. STA. 19+50.00
IRON PIN (FLUSH)

PLAN	SURVEYED	BY	DATE
	DESIGNED		
	CHECKED		
	NOTED		
	NO. OF WAY CHECKED		
	NO. OF FILE CHECKED		
	NO. OF FILE NAME		

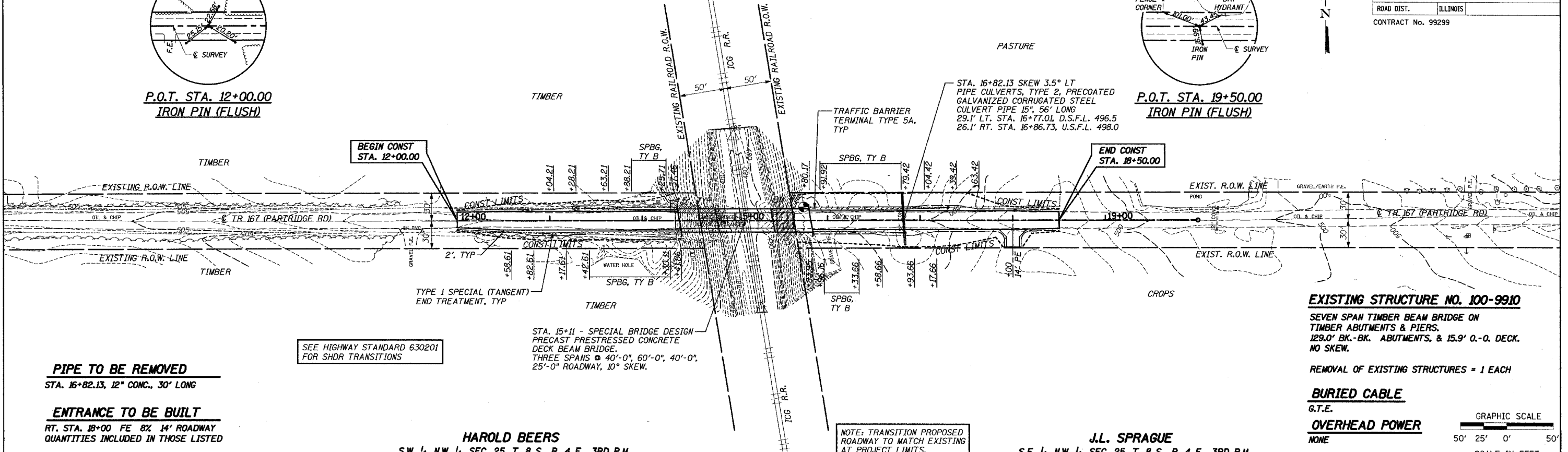

PIPE TO BE REMOVED
STA. 16+82.13, 12" CONC., 30' LONG

ENTRANCE TO BE BUILT
RT. STA. 18+00 FE 8X 14' ROADWAY
QUANTITIES INCLUDED IN THOSE LISTED

SEE HIGHWAY STANDARD 630201
FOR SHDR TRANSITIONS

STA. 15+11 - SPECIAL BRIDGE DESIGN
PRECAST PRESTRESSED CONCRETE
DECK BEAM BRIDGE.
THREE SPANS @ 40'-0", 60'-0", 40'-0",
25'-0" ROADWAY, 10° SKEW.

NOTE: TRANSITION PROPOSED
ROADWAY TO MATCH EXISTING
AT PROJECT LIMITS.

EXISTING STRUCTURE NO. 100-9910
SEVEN SPAN TIMBER BEAM BRIDGE ON
TIMBER ABUTMENTS & PIERS.
129.0' BK.-BK. ABUTMENTS, & 15.9' O.-O. DECK.
NO SKEW.

REMOVAL OF EXISTING STRUCTURES = 1 EACH

BURIED CABLE
G.T.E.

OVERHEAD POWER
NONE

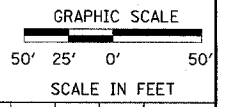

PROFILE	SURVEYED	BY	DATE
	DESIGNED		
	CHECKED		
	NOTED		
	NO. OF WAY CHECKED		
	NO. OF FILE CHECKED		
	NO. OF FILE NAME		

