

| REVISIONS | | |
|-----------|----|------|
| NUMBER | BY | DATE |
| | | |
| | | |
| | | |

0 1 2
 THIS BAR IS EQUAL TO 2" AT FULL SCALE (34X22).

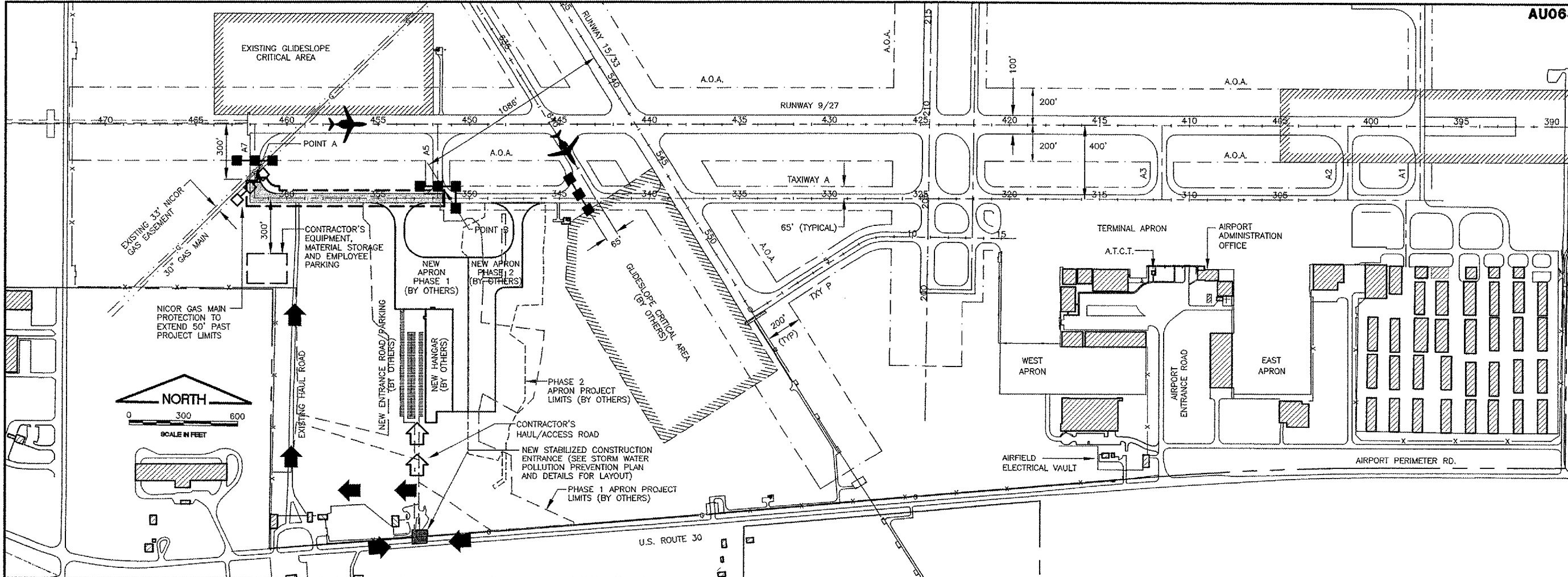

**AURORA MUNICIPAL AIRPORT
 AURORA, ILLINOIS
 REHABILITATE AND STRENGTHEN TAXIWAY ALPHA-WEST END
 PER AC 150/5370-2E (LATEST EDITION)**

LEGEND

- NEW P.C.C. PAVEMENT
- AIR OPERATIONS AREA (A.O.A.)
- AIRCRAFT MOVEMENT AREAS
- BARRICADES WITH FLASHING RED LIGHTS AND SIGNS "DO NOT ENTER" AND "AIRCRAFT MOVEMENT AREA" (SEE GENERAL NOTE 11 ON PREVIOUS SHEET)
- BARRICADES WITH FLASHING RED LIGHTS FOR GAS MAIN PROTECTION
- CONTRACTOR'S ACCESS/HAUL ROAD
- CONTRACTOR'S ACCESS/HAUL ROAD (BY OTHERS)
- LIMITS OF WORK
- LIMITS OF WORK (BY OTHERS)

**DESIGN AIRCRAFT APPROACH CATEGORY: D
 DESIGN AIRPORT GROUP: III**

GROUND CONTROL FREQUENCY: 121.70
 AIR CONTROL FREQUENCY: 120.60
 MAXIMUM ANTICIPATED HEIGHT OF CONSTRUCTION EQUIPMENT: 20'
 CLOSEST CONSTRUCTION POINT TO RUNWAY 9/27 - POINT A
 LATITUDE: 41°46'09.54" N (NAD 83)
 LONGITUDE: 88°29'08.88" W
 EXISTING ELEVATION: 695.97
 CLOSEST CONSTRUCTION POINT TO RUNWAY 15/33 - POINT B
 LATITUDE: 41°46'09.20" (NAD 83)
 LONGITUDE: 88°28'53.19"
 EXISTING ELEVATION: 696.55

CONTRACTOR SHALL PLAN AND PERFORM HIS WORK SO AS NOT TO INTERFERE OR HINDER THE PROGRESS, WORK OR HAUL ROAD ACCESS OF OTHER CONTRACTORS (SEE SPECIAL PROVISIONS SECTION 30-05). THE PRIME CONTRACTOR WILL BE RESPONSIBLE TO COORDINATE CONSTRUCTION ACTIVITIES AND ACCESS BETWEEN ALL ON-SITE CONTRACTORS SUBCONTRACTORS. IT IS ANTICIPATED THE FOLLOWING PROJECTS AND MAY BE UNDER CONSTRUCTION CONCURRENTLY WITH THIS PROJECT:

- RELOCATE RUNWAY 9 LOCALIZER.
- CONSTRUCT SOUTHWEST QUADRANT APRON - PHASE 1.
- CONSTRUCT SOUTHWEST QUADRANT APRON - PHASE 2.
- CONSTRUCT RUNWAY 33 INSTRUMENT LANDING SYSTEM.
- CONSTRUCT SOUTHWEST QUADRANT HANGAR.
- CONSTRUCT SOUTHWEST QUADRANT ENTRANCE ROAD AND PARKING.

| WORK AREA | ALLOWABLE WORK PERIODS | OPERATIONAL STATUS/ RESTRICTIONS |
|-----------------------|------------------------|---|
| PROPOSED IMPROVEMENTS | NO RESTRICTIONS | AIRFIELD PAVEMENTS OPEN EXCEPT FOR TAXIWAY ALPHA WEST END CLOSED AS SHOWN |

SUGGESTED SEQUENCE OF CONSTRUCTION

- MARK AIR OPERATIONS AREA (A.O.A.).
- PLACE BARRICADES AS SHOWN OR AS DIRECTED BY THE ENGINEER.
- PLACE BARRICADES FOR GAS MAIN PROTECTION.
- CONSTRUCT PROPOSED IMPROVEMENTS.
- CLEAN PAVEMENTS AND REMOVE BARRICADES.
- OPEN TAXIWAY.

© Copyright CMT, Inc.
CMT
 CRAWFORD, MURPHY & TILLY, INC.
 CONSULTING ENGINEERS
 License No. 784-000613

| | |
|------------------------|---------------|
| DESIGN BY: | DKP |
| DRAWN BY: | JRO |
| CHECKED BY: | ARM |
| APPROVED BY: | DKP |
| DATE: | 04/20/07 |
| JOB No: | 04285-05 |
| ILLINOIS PROJECT: | ARR-3514 |
| A.I.P. PROJECT: | 3-17-0003-B32 |
| FINAL SUBMITTAL | |

SHEET 5 OF 15 SHEETS