

MAY 01, 2007 4:28 PM RAW
 I:\AIRPORTS\MT.VERNON\81907TXD\AIRPORT\PROJECTS\151MRK.DWG - 32+50 to 46+50

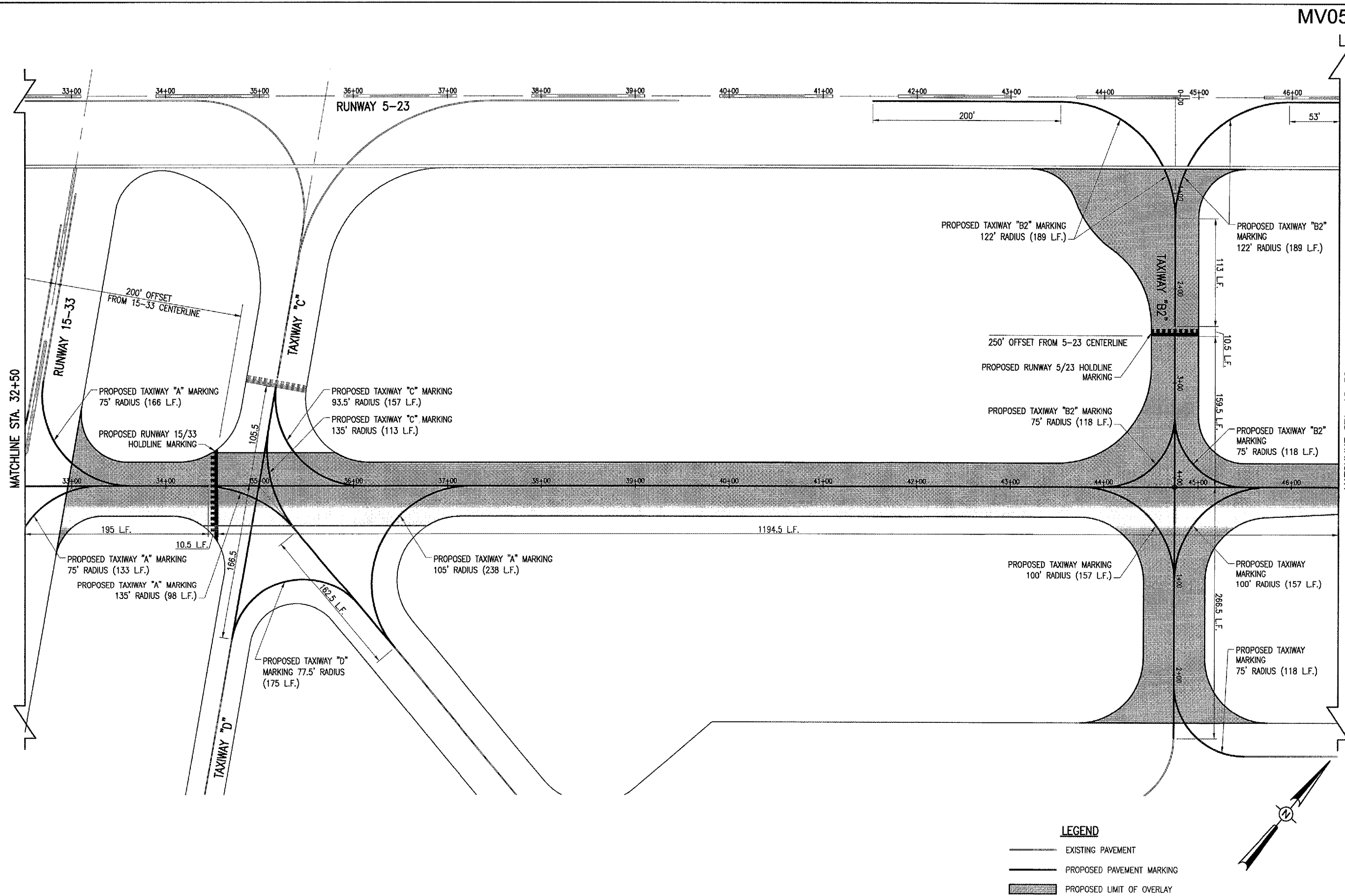

- LEGEND**
- EXISTING PAVEMENT
 - PROPOSED PAVEMENT MARKING
 - PROPOSED LIMIT OF OVERLAY

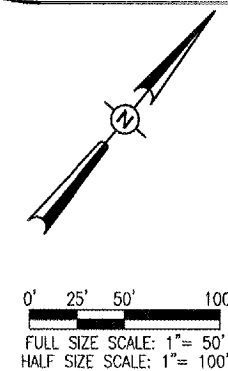

MV055

MATCHLINE STA. 32+50

MATCHLINE STA. 46+50

DATE	REVISION	BY

MT. VERNON AIRPORT

 MT. VERNON, ILLINOIS
 I.L. PROJ.: MWV-3693 A.I.P. PROJ.: 3-17-0074-816

LAYOUT	CCC	03/16/07
DRAWN	CCC	03/16/07
REVIEWED	RAW	04/12/07

I.E. Project No. 81907TXD
 Filename: R-151MRK.DWG
 Scale: 1" = 50'
 Date: 04/12/07

HANSON

 Hanson Professional Services Inc.
 1525 South Sixth Street
 Springfield, Illinois 62703-2886
 Offices Nationwide

PFC (0.1') OVERLAY
 OF TAXIWAYS
 PROPOSED PAVEMENT
 MARKING PLAN
 STA. 32+50 TO STA. 46+50