

QUAD CITY INTERNATIONAL AIRPORT  
 RUNWAY 31 EXTENSION - PAVING  
 ILL. MLI-3689, QU005  
 SHEET 7 OF 58

LEGEND:

- EDGE LIGHT
- GUIDANCE SIGN
- ELECTRICAL CABLE
- STORM SEWER OR UNDERDRAIN
- INLET
- OUTLET
- STORM MANHOLE
- SANITARY MANHOLE
- DRAINAGE DITCH
- CONDUIT OR DUCT BANK
- PROPOSED PAVEMENT
- PROPOSED CONSTRUCTION, SEEDING, AND GRADING LIMITS
- EARTHWORK MATCH LINES
- PROPOSED PAVEMENT REMOVAL

PROJECT CONTROL POINTS				
NUMBER	LOCATION	ELEV.	REMARK	
CP-3	STA. 86+99.84, RT. 400.23' N1739318.5560, E2206561.5768	578.39	SPK	
CP-4	STA. 82+77.01, RT. 706.75' N1739333.6190, E2206039.6030	580.12	SPK	
CP-5	STA. 84+87.59, RT. 0.12' N1739765.0785, E2206637.3701	579.77		

TEMPORARY BENCH MARKS		
T.B.M.	ELEV.	DESCRIPTION
TBM-A	578.57	CHIS. □ ON CONC TRANSFORMER PAD, TXWY K, STA. 377+71.67, RT. 369.06'
TBM-B	578.95	CHIS. □ ON NE COR OF CONC SIGN BASE, RNWY 31, STA. 82+34.96, RT. 250.41'
TBM-C	580.78	ALUMINUM DISC IN CONC ○ RNWY 31 END, RNWY 31, STA. 83+49.85, LT. 0.00'
TBM-D	575.61	CHIS. □ ON NE COR OF CONC SIGN BASE, RNWY 31, STA. 83+98.14, RT. 246.07'

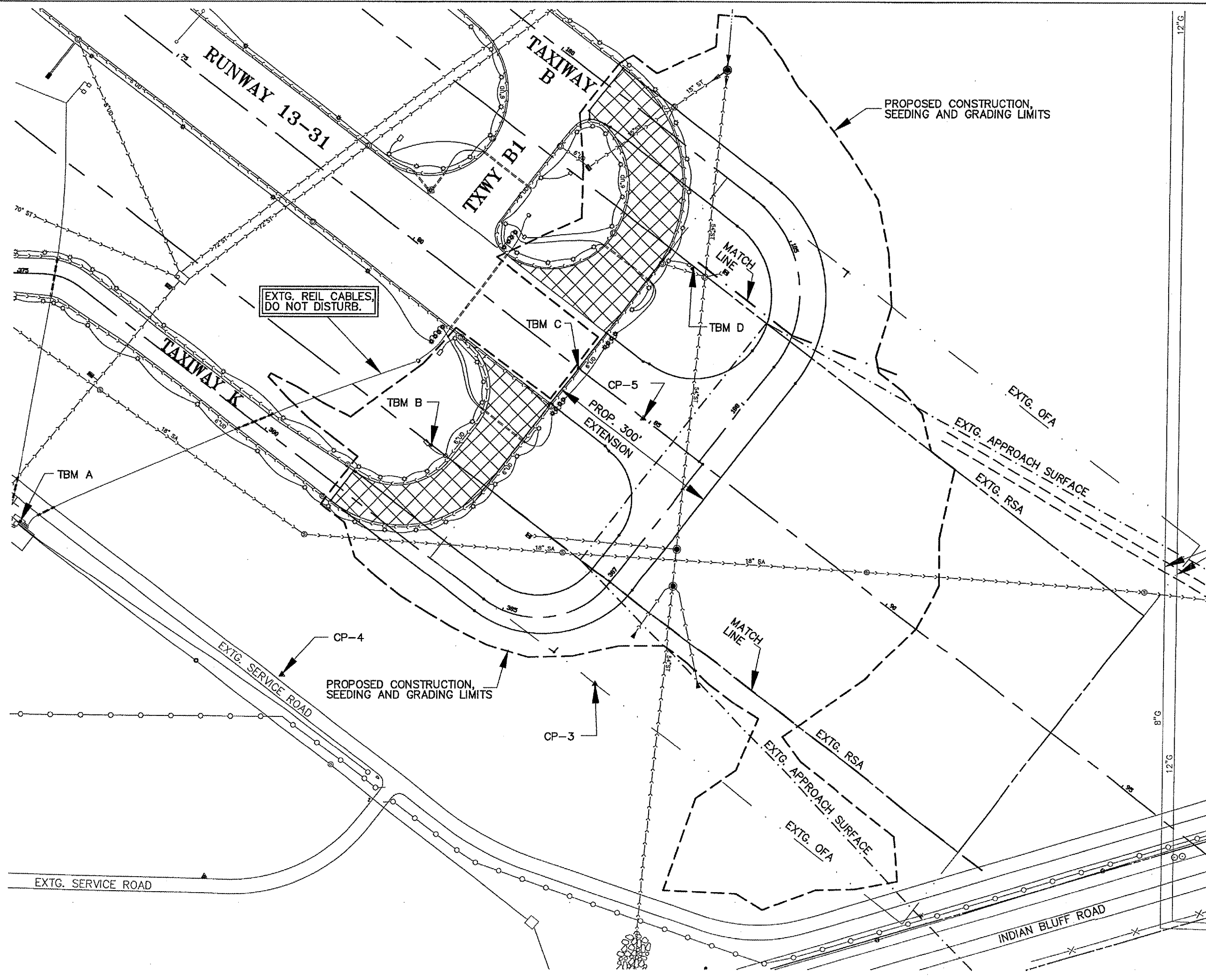

PROTECT EXISTING HIGH PRESSURE GAS MAINS WITH STEEL PLATES, EARTH, AND ROCK AS REQUIRED.

PROPOSED TEMPORARY HAUL ROAD

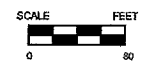
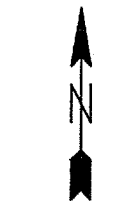

G:\AIRPORT\A06T024 R31 EXTN, P\MTAREA.dwg, 5/16/2007 10:55:06 AM, jeffm