

**UTILITY NOTE**

THE LOCATION OF UNDERGROUND UTILITIES AS INDICATED ON THE PLANS HAS BEEN OBTAINED FROM EXISTING RECORDS. NEITHER THE OWNER NOR THE ENGINEER ASSUMES ANY RESPONSIBILITY WHATSOEVER IN RESPECT TO THE ACCURACY, COMPLETENESS, OR SUFFICIENCY OF THE INFORMATION. THERE IS NO GUARANTEE, EITHER EXPRESSED OR IMPLIED, THAT THE LOCATIONS, SIZE AND TYPE OF MATERIAL OF EXISTING UNDERGROUND UTILITIES INDICATED ARE REPRESENTATIVE OF THOSE TO BE ENCOUNTERED IN THE CONSTRUCTION.

IT SHALL BE THE CONTRACTOR'S RESPONSIBILITY TO DETERMINE THE ACTUAL LOCATION OF ALL SUCH FACILITIES, INCLUDING SERVICE CONNECTIONS TO UNDERGROUND UTILITIES. PRIOR TO CONSTRUCTION, THE CONTRACTOR SHALL NOTIFY THE UTILITY COMPANY OF HIS OPERATIONAL PLANS. THE CONTRACTOR SHALL MAKE ARRANGEMENTS FOR DETAILED INFORMATION AND ASSISTANCE IN LOCATING UTILITIES. IN THE EVENT AN UNEXPECTED UTILITY INTERFERENCE IS ENCOUNTERED DURING CONSTRUCTION, THE CONTRACTOR SHALL IMMEDIATELY NOTIFY THE UTILITY COMPANY, THE AIRPORT MANAGER AND THE ENGINEER. ANY SUCH MAINS AND/OR SERVICES DISTURBED BY THE CONTRACTOR'S OPERATIONS SHALL BE RESTORED IMMEDIATELY AT HIS EXPENSE TO THE SATISFACTION OF THE AIRPORT MANAGER, THE UTILITY COMPANY AND THE ENGINEER.

- NOTES:**
- FLAGGERS IN CONTACT WITH THE FAA GROUND CONTROL WILL BE REQUIRED FOR ACCESS ACROSS ACTIVE AIRFIELD PAVEMENTS.
  - CONTRACTOR NOT ALLOWED WITHIN 200 FEET OF RUNWAY 14L/32R CENTERLINE.
  - AIRFIELD ACCESS, HAUL ROUTES AND FLAGGER REQUIREMENTS TO BE AS SHOWN IN THE CONSTRUCTION ACTIVITY PLANS.
  - POINTS 1 AND 2 REPRESENT THE CONSTRUCTION LIMITS CLOSEST TO RUNWAY 14L/32R.
  - TAXIWAY B, FROM TAXIWAY B1 TO THE APPROACH OF RUNWAY 4 AND RUNWAY 18/36 TO BE CLOSED DURING CONSTRUCTION OF AIRPORT PERIMETER ROAD IN THIS LOCATION. PLACE HIGH PROFILE BARRICADES AT LOCATIONS INDICATED.
  - CONTRACTOR TO USE THE EXISTING CONSTRUCTION STORAGE AREA AT THE APRON SITE. SEE CONSTRUCTION ACTIVITY PLAN NOTES AND DETAILS.
  - CONTRACTOR TO DISPOSE OF MILLINGS AT LOCATION SHOWN. SEE DETAIL ON GENERAL NOTES AND DETAILS SHEET.
  - CONTRACTOR ALLOWED ACCESS BEYOND THIS LOCATION ONLY WHEN DISPOSING OF MILLINGS.
  - THE CONTRACTOR WILL BE ALLOWED TO USE THIS STAGING AREA DURING THE PORTIONS OF PHASE 3 THAT REQUIRE ACCESS THROUGH THE WEST GATE.

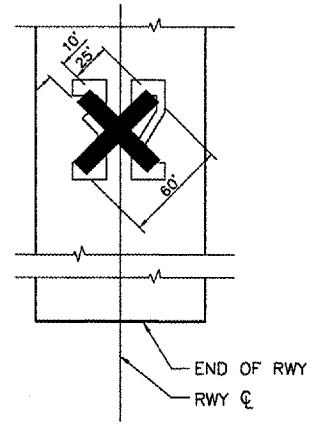

**CLOSED RWY MARKER DETAIL**  
N.T.S.

K:\Champaign\030590302 Apron Rehab 2\Draw\5  
FILE: SITE.dwg  
UPDATE BY: Sean Smith  
PLOT DATE: 4/28/2007 4:06 PM  
CMI-SitePlanGeo

**REVISIONS**

NUMBER	BY	DATE

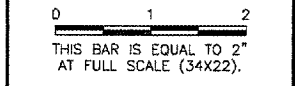

**UNIVERSITY OF ILLINOIS  
WILLARD AIRPORT**

**REHABILITATE AIR CARRIER RAMP, PHASE 2  
SITE PLAN**

© Copyright CMT, Inc.  
**CMT**  
CRAWFORD, MURPHY & TILLY, INC.  
CONSULTING ENGINEERS  
License No. 084-000610

DESIGN BY:	SMS
DRAWN BY:	CMT
CHECKED BY:	<i>SMS</i>
APPROVED BY:	<i>SMS</i>
DATE:	4/27/2007
JOB No:	0305903
CMI-3663 3-17-0016-XX	
SHEET 03 OF 49 SHEETS	