

REMOVAL SECTION - TAXIWAY A6 AT TAXIWAY A
 N.T.S. (II)

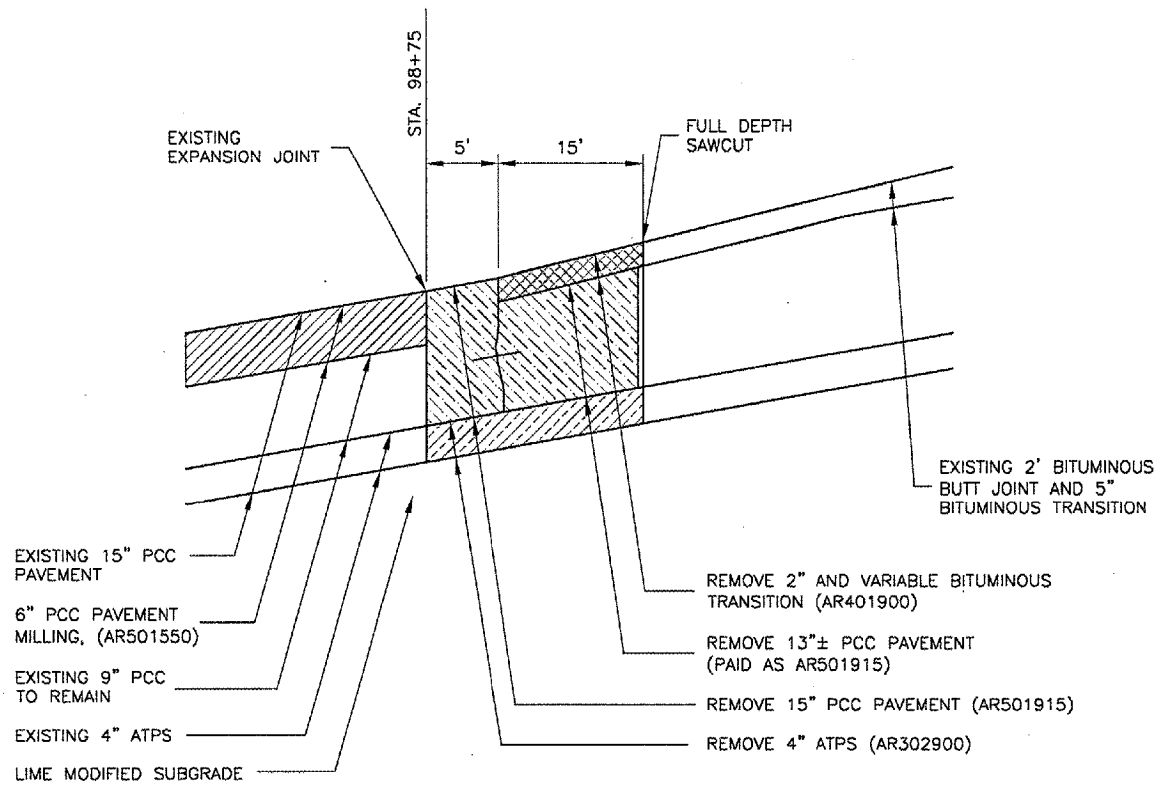

REMOVAL SECTION - TAXIWAY A7 AT TAXIWAY A
 N.T.S. (JJ)

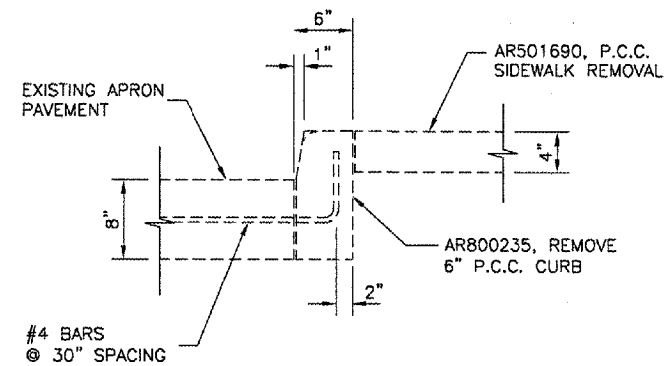

NOTE:
 ANY DAMAGE TO EXISTING PAVEMENT ADJACENT TO THE REMOVAL LOCATION TO BE REPAIRED BY THE CONTRACTOR TO THE SATISFACTION OF THE AIRPORT AT NO EXPENSE TO THE CONTRACT.

CURB ADJACENT TO CONCOURSE
 TYPICAL DETAIL
 N.T.S.

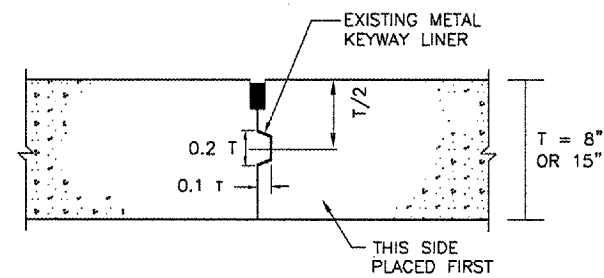

EXISTING TYPE C KEYED JOINT DETAIL

SYMBOL ———

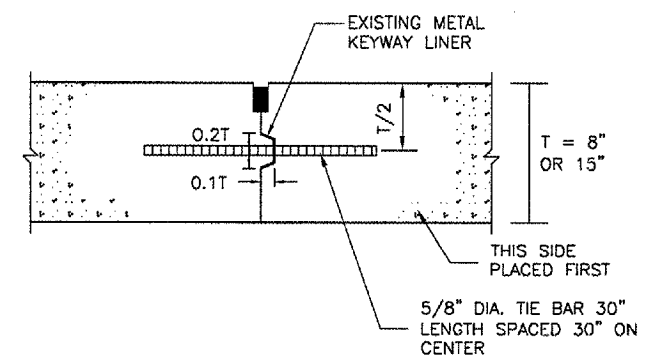

EXISTING TYPE E HINGED (KEYED) JOINT DETAIL

SYMBOL —+—+—+—

EXISTING KEYED JOINT DETAILS
 N.T.S.

REVISIONS		
NUMBER	BY	DATE

0 1 2
 THIS BAR IS EQUAL TO 2" AT FULL SCALE (34X22).

UNIVERSITY OF ILLINOIS
 WILLARD AIRPORT
 REHABILITATE AIR CARRIER RAMP, PHASE 2
 PAVEMENT REMOVAL DETAILS SHEET 3

© Copyright CMT, Inc.
CMT
 CRAWFORD, MURPHY & TILLY, INC.
 CONSULTING ENGINEERS
 License No. 184-000613

DESIGN BY: SMS
 DRAWN BY: CMT
 CHECKED BY: *SMS*
 APPROVED BY: *SMS*
 DATE: 4/27/2007
 JOB No: 0305903

CMI-3663
 3-17-0016-XX