

REVISIONS		
NUMBER	BY	DATE

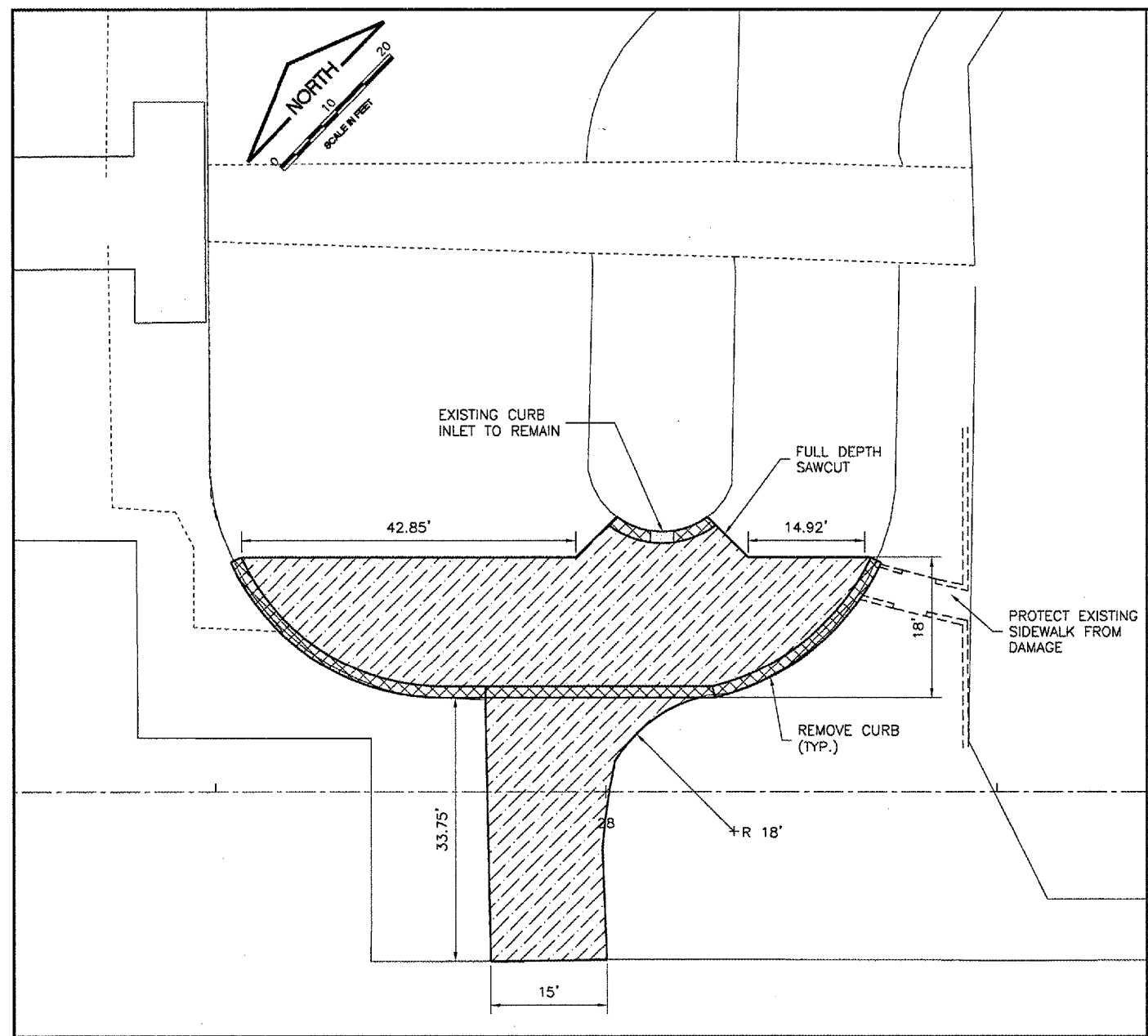
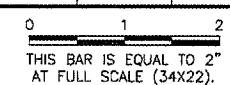

① REMOVAL DETAIL

REMOVAL LEGEND

- REMOVE 8" PCC PAVEMENT AND 4" ATPS (AR501908 AND AR302900)
- REMOVE COMBINED CURB & GUTTER - AR754904

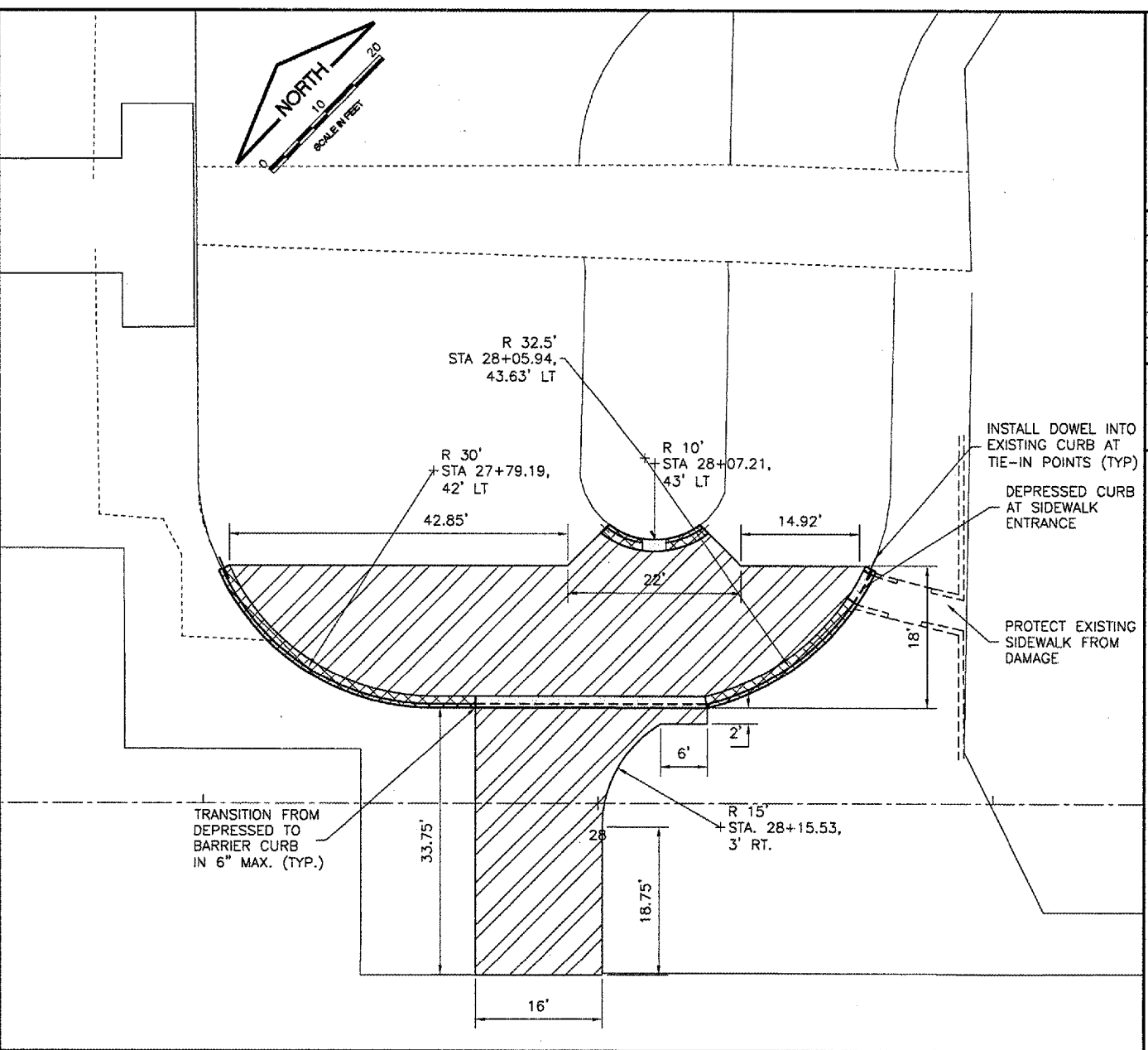

② REPLACEMENT DETAIL

REMOVAL LEGEND

- NEW AR501508 8" PCC PAVEMENT AND AR209510 8" CRUSHED AGGREGATE BASE
- NEW COMBINED CURB & GUTTER, TYPE B-6.12
- NEW DEPRESSED COMBINED CURB & GUTTER, TYPE B-6.12

REPLACEMENT NOTES:

1. MATCH INTO EXISTING CURB AT EXISTING FLOWLINE AND B.O.C. ELEVATIONS.
2. SEE JOINTING PLAN FOR JOINT SPACING AND LAYOUT.
3. MISCELLANEOUS EARTHWORK REQUIRED FOR NEW GEOMETRY TO BE CONSIDERED INCIDENTAL TO 8" PCC REMOVAL.
4. MATCH NEW CURB TO EXISTING CURB INLET.
5. SEE SIDEWALK & CURB AND LIMO & TAXI DRIVE STAKING PLAN FOR NEW PAVEMENT ELEVATIONS.

UNIVERSITY OF ILLINOIS  
 WILLARD AIRPORT  
 REHABILITATE AIR CARRIER RAMP, PHASE 2  
 PROJECT IMPROVEMENTS - TAXI AND  
 LIMOUSINE WAITING AREA

© Copyright CMT, Inc.  
**CMT**  
 CRAWFORD, MURPHY & TILLY, INC.  
 CONSULTING ENGINEERS  
 License No. 984-000613



DESIGN BY:	SMS
DRAWN BY:	-----
CHECKED BY:	<i>SMB</i>
APPROVED BY:	<i>SMS</i>
DATE:	4/27/2007
JOB No:	0305903

CMI-3663  
 3-17-0016-XX