

| REVISIONS |    |      |
|-----------|----|------|
| NUMBER    | BY | DATE |
|           |    |      |
|           |    |      |
|           |    |      |

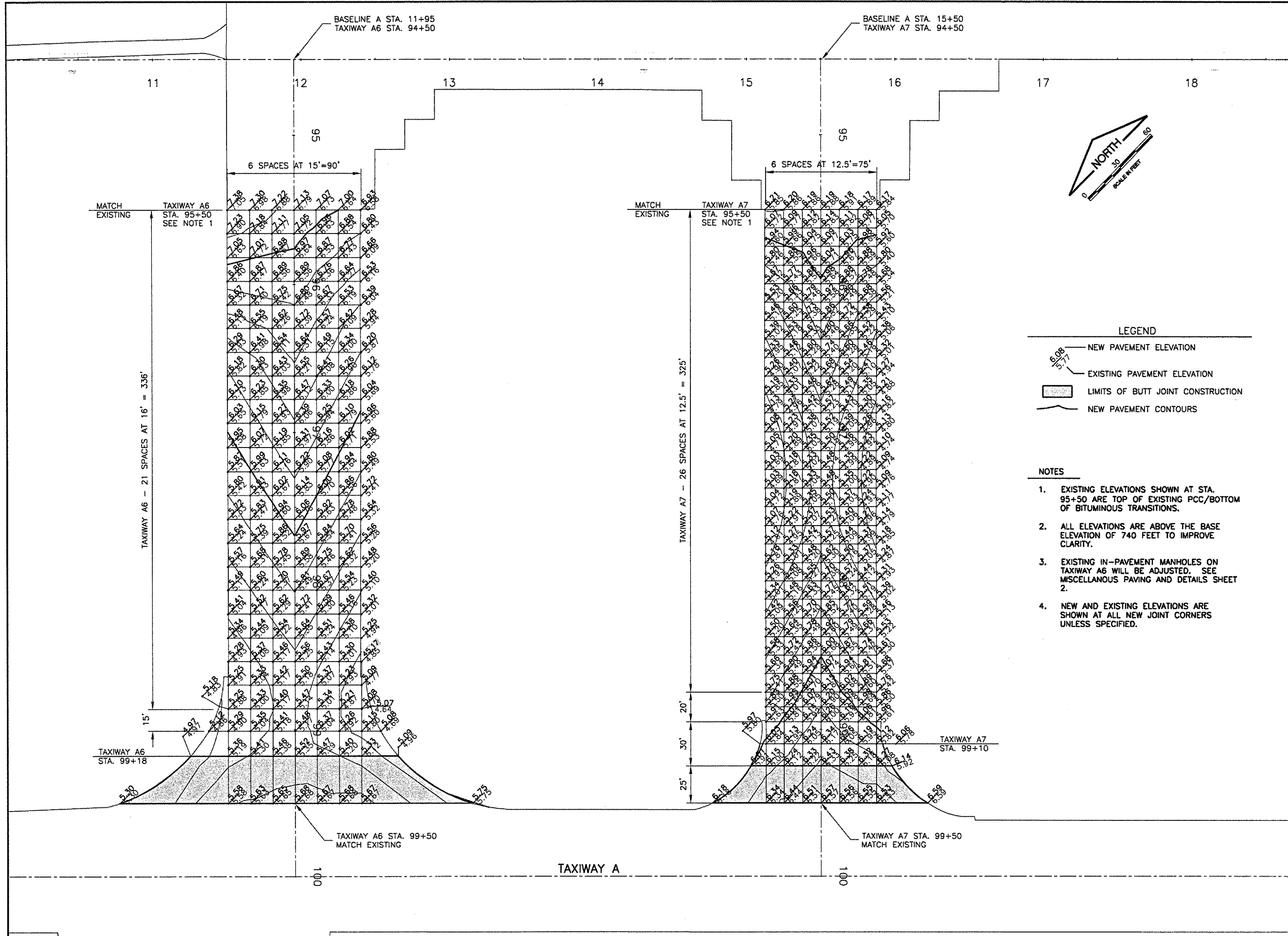
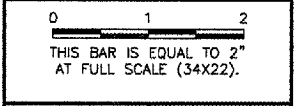

**LEGEND**

- NEW PAVEMENT ELEVATION
- EXISTING PAVEMENT ELEVATION
- LIMITS OF BUTT JOINT CONSTRUCTION
- NEW PAVEMENT CONTOURS

- NOTES**
- EXISTING ELEVATIONS SHOWN AT STA. 95+50 ARE TOP OF EXISTING PCC/BOTTOM OF BITUMINOUS TRANSITIONS.
  - ALL ELEVATIONS ARE ABOVE THE BASE ELEVATION OF 740 FEET TO IMPROVE CLARITY.
  - EXISTING IN-PAVEMENT MANHOLES ON TAXIWAY A6 WILL BE ADJUSTED. SEE MISCELLANEOUS PAVING AND DETAILS SHEET 2.
  - NEW AND EXISTING ELEVATIONS ARE SHOWN AT ALL NEW JOINT CORNERS UNLESS SPECIFIED.

**UNIVERSITY OF ILLINOIS  
 WILLARD AIRPORT**

**REHABILITATE AIR CARRIER RAMP, PHASE 2  
 STAKING PLAN 2 - TAXIWAYS**

**CMT**  
 CRAWFORD, MURPHY & TILLY, INC.  
 CONSULTING ENGINEERS  
 License No. 784-000813

|                          |            |
|--------------------------|------------|
| DESIGN BY:               | SMS        |
| DRAWN BY:                | CMT        |
| CHECKED BY:              | <i>SMS</i> |
| APPROVED BY:             | <i>SMS</i> |
| DATE:                    | 4/27/2007  |
| JOB No:                  | 0305903    |
| CMI-3663<br>3-17-0016-XX |            |
| SHEET 29 OF 49 SHEETS    |            |