

CONSTRUCTION PLANS FOR OVERLAY OF GENERAL AVIATION APRON REHABILITATION MARION-HERRIN, WILLIAMSON COUNTY, ILLINOIS DATE : FEBRUARY 20, 2007

INDEX OF SHEETS

1. COVER SHEET
2. SAFETY PLAN
3. TYPICAL SECTIONS & CONCRETE DETAILS
4. GENERAL LAYOUT - OVERLAY PLAN
5. GENERAL LAYOUT - PATCHING
6. PAVEMENT MARKING PLAN

SUMMARY OF QUANTITIES				
ITEM NO.	DESCRIPTION	UNIT	EST. QUANTITY	AS-BUILT QUANTITY
AR150510	ENGINEERING FIELD OFFICE	EA.	1	
AR152410	UNCLASSIFIED EXCAVATION	C.Y.	80	
AR209510	CRUSHED AGGREGATE BASE	TON	50	
AR401810	BITUMINOUS SURFACE COURSE	TON	3,756	
AR401850	BITUMINOUS PAVEMENT MILLING (VARIABLE DEPTH)	S.Y.	39,023	
AR401830	BITUMINOUS SURFACE TEST SECTION	EA.	1	
AR501510	10" PCC PAVEMENT	S.Y.	101	
AR603510	BITUMINOUS TACK COAT	GAL.	3,902	
AR620520	PAVEMENT MARKING WATERBORNE	S.F.	3,476	

ILLINOIS PROJECT No. MWA-3657
A.I.P. PROJECT No. 3-17-0065-??

RECURRING SPECIAL PROVISIONS			
The following RECURRING SPECIAL PROVISIONS indicated by an "X" are Applicable to this contract and are included by reference:			
Check Sheet No.	Item No.		Page No.
1	AR101680	Refurbish 36" Beacon	155
2	AR108000	Apron Lighting	160
3	AR119000	Airport Obstruction Lighting (Not Included)	166
4	AR127000	Airport Navaid Installation (Not Included)	167
X 5	AR150510	Engineer's Field Office	168
6	AR150560	Temporary Threshold	170
7	AR152540	Soil Stabilization Fabric	173
8	AR156000	Erosion Control	175
9	AR156513	Separation Fabric	180
10	AR156540	Riprap	182
11	AR201001	Bituminous Base Course - Method I	185
12	AR201002	Bituminous Base Course - Method II	193
13	AR201003	Bituminous Base Course - Method I, Superpave	209
14	AR201004	Bituminous Base Course - Method II, Superpave	217
15	AR201661	Clean & Seal Bituminous Cracks	230
16	AR201663	Sand Mix Crack Repair	233
17	AR201671	Crack Control Fabric	235
18	AR302000	Asphalt Treated Permeable Subbase	237
19	AR401001	Bituminous Surface Course - Method I	245
X 20	AR401002	Bituminous Surface Course - Method II	253
21	AR401003	Bituminous Surface Course - Method I, Superpave	269
22	AR401004	Bituminous Surface Course - Method II, Superpave	277
23	AR401640	Bituminous Pavement Grooving	280
X 24	AR401650	Bituminous Pavement Milling	283
25	AR401655	Buff Joint Construction	285
26	AR401800	Remove Bituminous Pavement	297
X 27	AR501001	Portland Cement Concrete - Pavement Method I	299
28	AR501002	Portland Cement Concrete - Pavement Method II	316
29	AR501003	Portland Cement Concrete - Pavement Method III	338
30	AR501115	Crack and Seal Pavement	362
31	AR501540	PCC Pavement Grooving	365
32	AR501550	PCC Pavement Milling	368
33	AR501900	Remove PCC Pavement	370
34	AR510500	Tie-down/Ground Rod	372
35	AR605000	Silicone Joint Sealing Filler	373

LATITUDE 37° 45' 15"
LONGITUDE 89° 00' 45"
ELEVATION 471.00

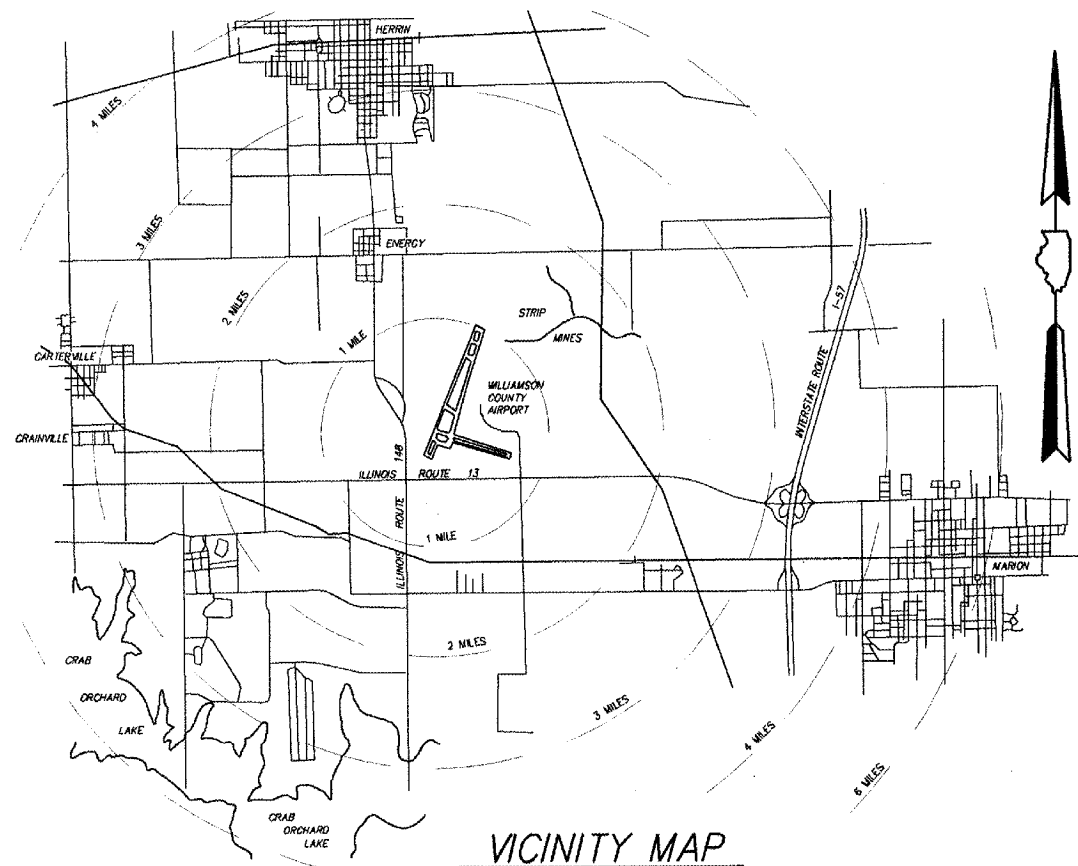

BOARD MEMBERS

- CHAIRMAN : CARL PLANINC
MEMBERS : BERNARD A. PAUL
DARREN PULLEY
RICHARD PISONI
SECRETARY : CRAIG PILLATSCH
AIRPORT MANAGER : DOUGLAS KIMMEL



EXPIRES : NOVEMBER 30, 2007

NOTE REGARDING SPECIAL PROVISIONS
THIS PROJECT HAS NO SPECIAL PROVISIONS. ALL WORK SHALL COMPLY WITH THE STANDARD SPECIFICATIONS FOR CONSTRUCTION ON AIRPORTS (JANUARY 1985) AS AMENDED BY THE SUPPLEMENTAL SPECIFICATIONS AND RECURRING SPECIAL PROVISIONS.

PLANS PREPARED BY:		WILLIAMSON COUNTY AIRPORT AUTHORITY	
CLARIDA & ZIEGLER ENGINEERING COMPANY P.O. Box 937, 306 South Court Street Marion, Illinois 62958			
REGISTERED PROFESSIONAL ENGINEER OF ILLINOIS NO. 24022	APPROVED: <i>Carl Planinc</i> CHAIRMAN	DATE: _____	2007
SUBMITTED: <i>Harold G. Clarida</i> ENGINEER HAROLD G. CLARIDA	APPROVED: <i>Craig Pillatsch</i> SECRETARY	DATE: _____	2007
DATE: _____	2007	DATE: _____	2007

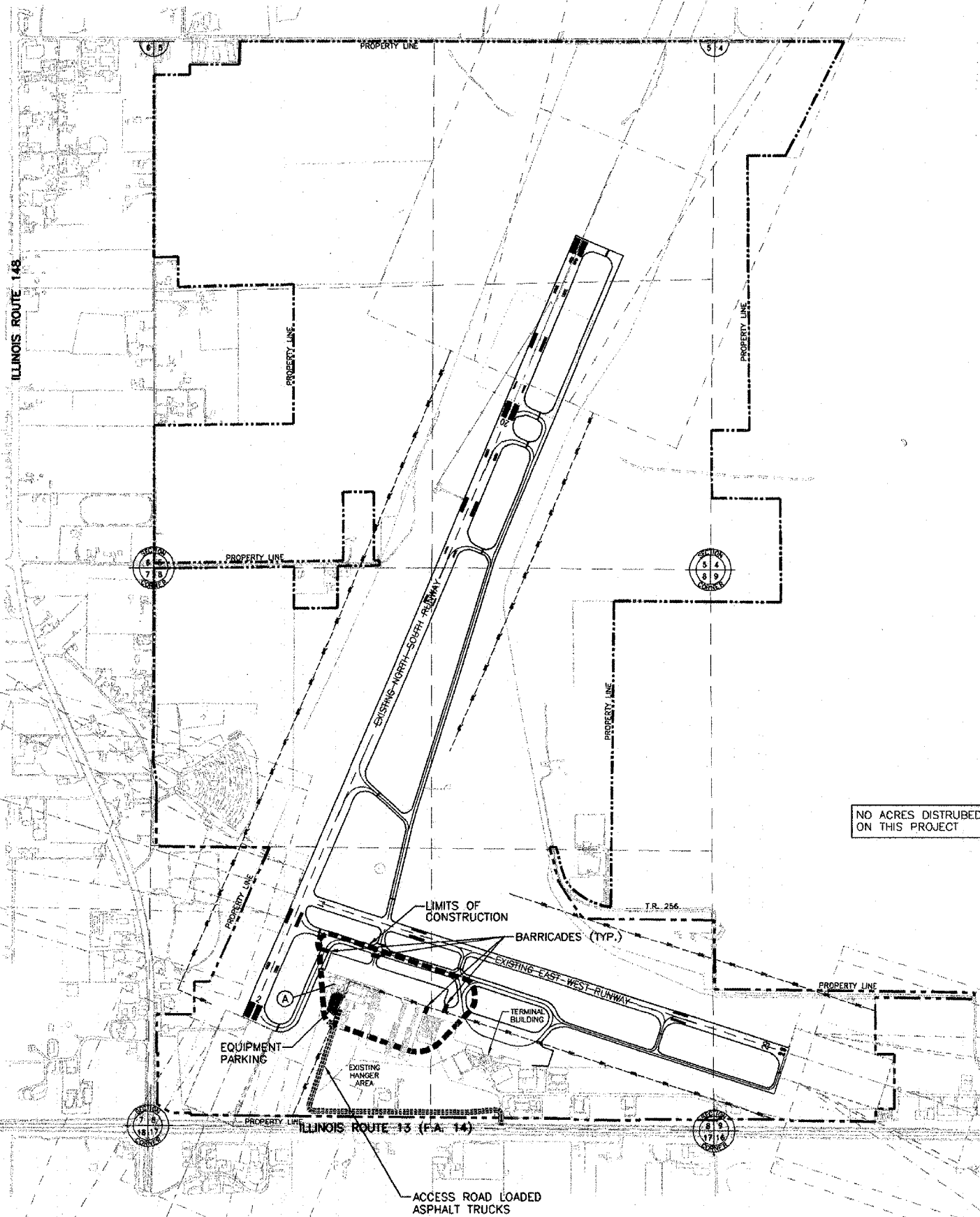

SCALE : 1" = 600'

GENERAL NOTES

1. THE CONTRACTOR SHALL THOROUGHLY CLEAN ALL CONSTRUCTION AREAS WHEN THE PROJECT IS COMPLETED.
2. ALL AREAS UTILIZED BY THE CONTRACTOR FOR EQUIPMENT PARKING AND STORAGE SHALL BE KEPT CLEAN, MAINTAINED AND REPAIRED TO THE SATISFACTION OF THE ENGINEER. NO ADDITIONAL COMPENSATION WILL BE MADE TO THE CONTRACTOR FOR THIS WORK.
3. EXISTING TURF AREAS DISTURBED BY THE CONTRACTORS OPERATIONS SHALL BE RESTORED BY HIM AT HIS EXPENSE TO THE SATISFACTION OF THE ENGINEER.
4. THE CONTRACTOR SHALL WORK ONLY IN THE LIMITS SHOWN ON THE PLANS.
5. HEIGHT OF CONSTRUCTION EQUIPMENT MAXIMUM IS ANTICIPATED TO BE 25' WHICH IS A SEMI-TRAILER IN THE UP POSITION.

POINT SCHEDULE

POINT No.	LONGITUDE	LATITUDE	ELEVATION
(A)	89°00'55.6"	37°44'55.9"	455.48

ILLINOIS PROJECT NO. MWA-3562
A.I.P. PROJECT NO. 3-17-0065-XX

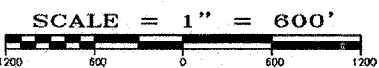

ILLINOIS PROJECT NO. MWA-3657
A.I.P. PROJECT NO. ?-??-????-??

STATE OF ILLINOIS PROFESSIONAL DESIGN FIRM LICENSE NO. 184-000872

REVISIONS	
DATE	NO.

© 2007 ALL RIGHTS RESERVED

CLARIDA & ZIEGLER ENGINEERING CO.
308 South Court St, P.O. Box 937
Marion, Illinois 62959
Phone - (618)993-6411, Fax - (618)993-6750

CONSTRUCTION SAFETY PLAN
GENERAL AVIATION APRON REHABILITATION
WILLIAMSON COUNTY REGIONAL AIRPORT
MARION - HERRIN, ILLINOIS

Date 01/18/2007 DR. By P.L.D. CK'D By C.M.
Scale 1" = 600' Job No. 06153 Sheet No. 2 of 6

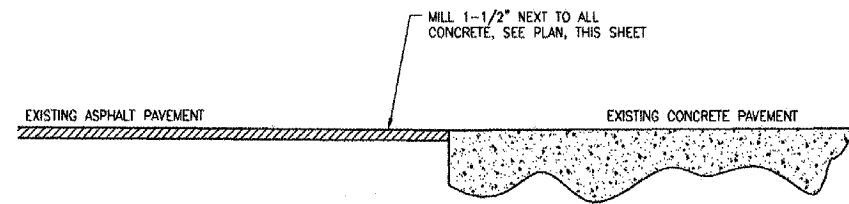

MILLING DETAIL

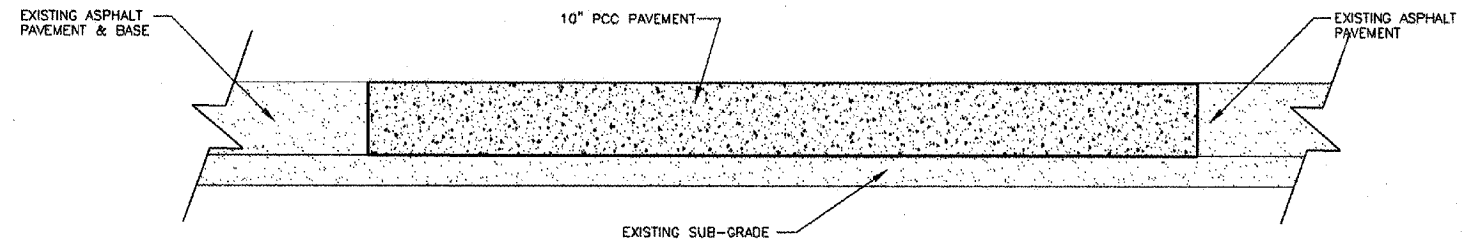

TYPICAL SECTION FOR FUEL TRUCK PAD
GA RAMP 10\"/>

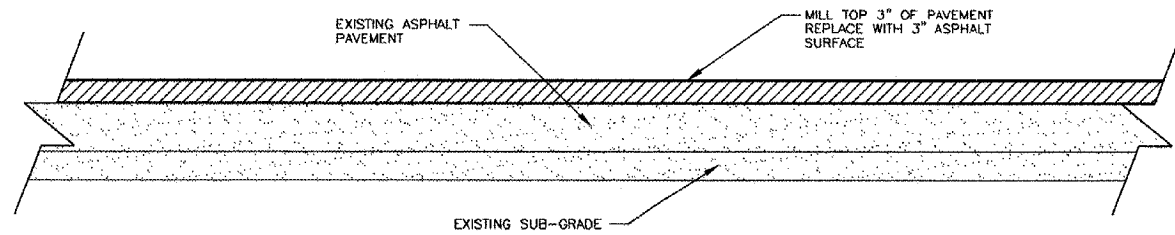

TYPICAL SECTION FOR AREAS TO BE MILLED
GA RAMP 3\"/>

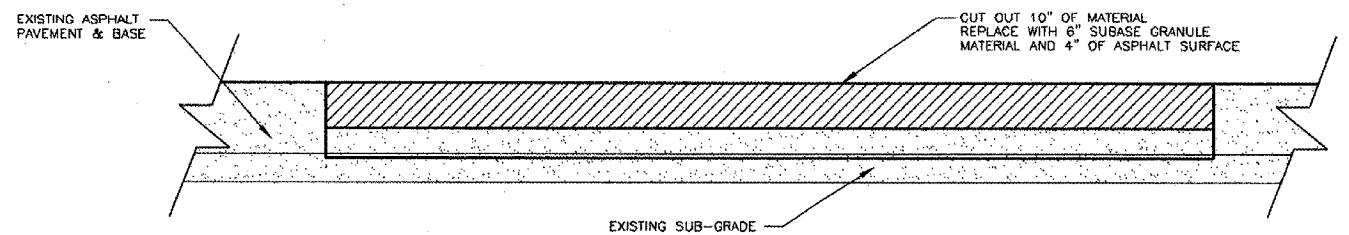

TYPICAL SECTION FOR AREAS TO BE PATCHED
GA RAMP 6\"/>

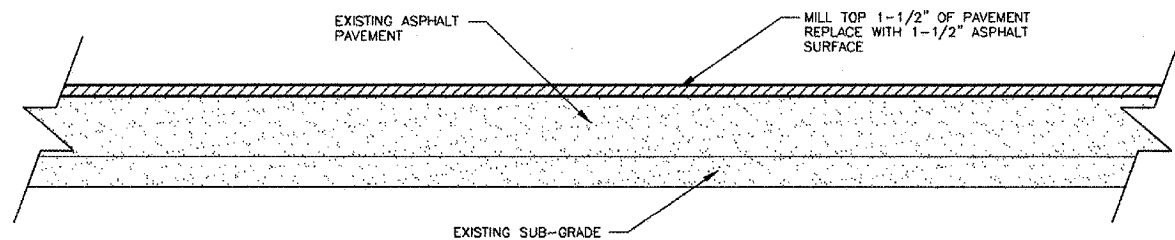

TYPICAL SECTION FOR AREAS TO BE MILLED
GA RAMP 1-1/2\"/>

ILLINOIS PROJECT NO. MWA-3657
A.I.P. PROJECT NO. 7-??-7777-??

STATE OF ILLINOIS PROFESSIONAL DESIGN FIRM LICENSE NO. 184-000872

© 2007 ALL RIGHTS RESERVED

REVISIONS	
DATE	NO.



**CLARIDA & ZIEGLER
ENGINEERING CO.**
308 South Court St. P.O. Box 937
Marion, Illinois 62959
Phone - (618)993-6411, Fax - (618)993-6750

TYPICAL SECTIONS & CONCRETE DETAILS
GENERAL AVIATION APRON REHABILITATION
WILLIAMSON COUNTY REGIONAL AIRPORT
MARION - HERRIN, ILLINOIS

Date 01/18/2007 DR. By P.L.D. CKD By C.M.

EXISTING 5000' x 100' RUNWAY S 72° 18' 42" E

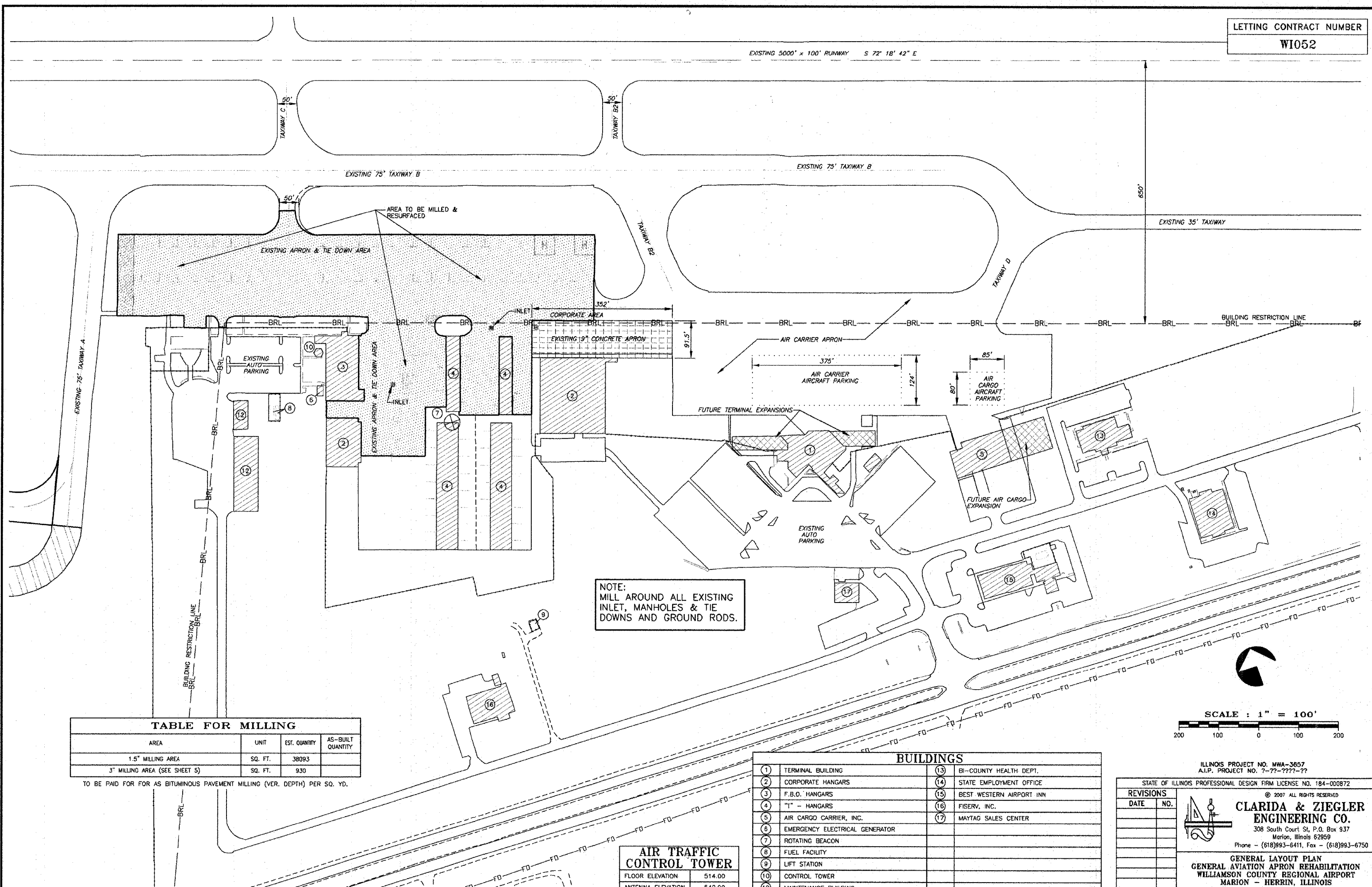

NOTE:
MILL AROUND ALL EXISTING
INLET, MANHOLES & TIE
DOWNS AND GROUND RODS.

AREA	UNIT	EST. QUANTITY	AS-BUILT QUANTITY
1.5" MILLING AREA	SQ. FT.	38093	
3" MILLING AREA (SEE SHEET 5)	SQ. FT.	930	

TO BE PAID FOR FOR AS BITUMINOUS PAVEMENT MILLING (VER. DEPTH) PER SQ. YD.

FLOOR ELEVATION	514.00
ANTENNA ELEVATION	542.00

(1) TERMINAL BUILDING	(13) BI-COUNTY HEALTH DEPT.
(2) CORPORATE HANGARS	(14) STATE EMPLOYMENT OFFICE
(3) F.B.O. HANGARS	(15) BEST WESTERN AIRPORT INN
(4) "T" - HANGARS	(16) FISERV, INC.
(5) AIR CARGO CARRIER, INC.	(17) MAYTAG SALES CENTER
(6) EMERGENCY ELECTRICAL GENERATOR	
(7) ROTATING BEACON	
(8) FUEL FACILITY	
(9) LIFT STATION	
(10) CONTROL TOWER	
(12) MAINTENANCE BUILDING	

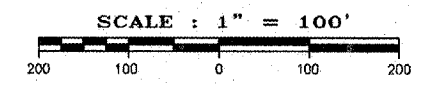

ILLINOIS PROJECT NO. MWA-3657
A.I.P. PROJECT NO. 7-??-????-??

STATE OF ILLINOIS PROFESSIONAL DESIGN FIRM LICENSE NO. 184-000872

© 2007 ALL RIGHTS RESERVED

CLARIDA & ZIEGLER ENGINEERING CO.
308 South Court St, P.O. Box 937
Marion, Illinois 62959
Phone - (618)993-6411, Fax - (618)993-6750

GENERAL LAYOUT PLAN
WILLIAMSON COUNTY REGIONAL AIRPORT
MARION - HERRIN, ILLINOIS

Date 01/18/2007 DR By P.L.D. CKD By G.M.

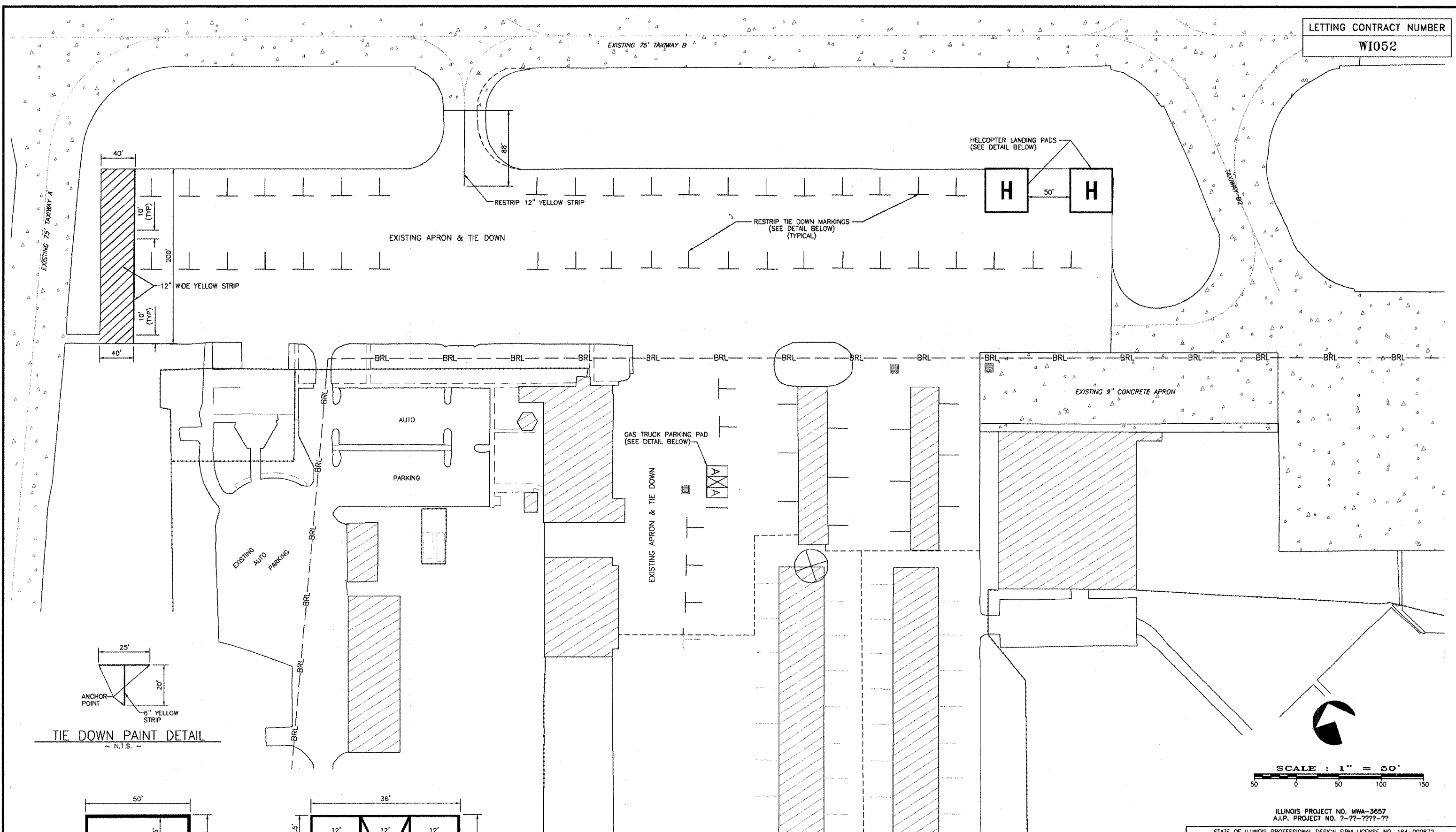

TIE DOWN PAINT DETAIL
~ N.T.S. ~

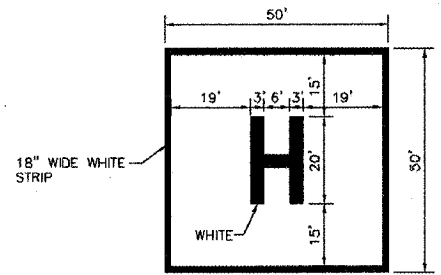

HELICOPTER PAD PAINT DETAIL
~ N.T.S. ~

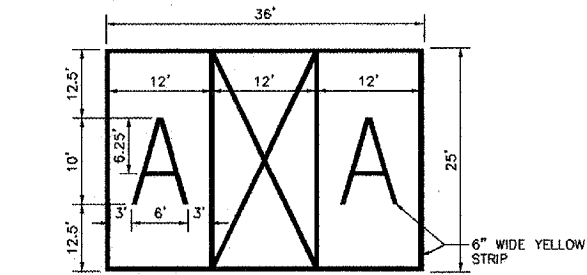

GAS TRUCK PARKING PAD PAINT DETAIL
~ N.T.S. ~

MARKING QUANTITIES			
DESCRIPTION	UNIT	EST. QUANTITY	AS-BUILT QUANTITY
YELLOW	SQ. FT.	2600	
WHITE	SQ. FT.	876	

REVISIONS	
DATE	NO.

CLARIDA & ZIEGLER
ENGINEERING CO.
308 South Court St, P.O. Box 937
Morton, Illinois 62959
Phone - (618)993-6411, Fax - (618)993-6750

PAINT MARKING PLAN
WILLIAMSON COUNTY REGIONAL AIRPORT
MARION - HERRIN, ILLINOIS

Date 01/18/2007 DR. By P.L.D. CK'D By C.M.