

BENCHMARK "A" NORTHWEST CORNER OF CONCRETE HEADWALL LOCATED AT STA. 99+56  
ASSUMED ELEV = 786.41

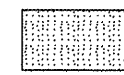

 PROPOSED BRICK SIDEWALK

**BASELINE COORDINATES**

STA. 200+00  
N: 1,651,152.19  
E: 2,309,703.54

STA. 202+00  
N: 1,651,352.19  
E: 2,309,703.54

STA. 500+00  
N: 1,651,182.86  
E: 2,309,703.54

STA. 501+00  
N: 1,651,182.86  
E: 2,309,603.54

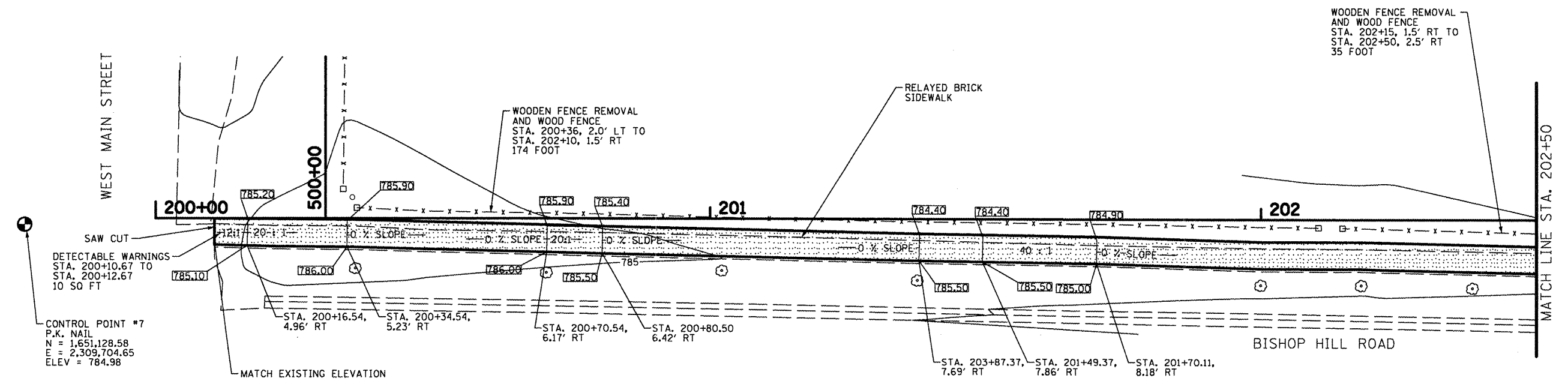

FILE NAME =  
#FILE#

USER NAME = #USER#  
PLOT SCALE = #SCALE#  
PLOT DATE = #DATE#

DESIGNED - R.H.D.	REVISED -
DRAWN - S.D.J.	REVISED -
CHECKED - R.H.D.	REVISED -
DATE - 3/28/12	REVISED -

STATE OF ILLINOIS  
DEPARTMENT OF TRANSPORTATION

PLAN SHEET VILLAGE SQUARE STA. 200+00-202+50 & 500+00-501+50  
BISHOP HILL STATE HISTORIC SITE  
SCALE: 1" = 30' SHEET NO. 7 OF 9 SHEETS STA. 200+00 TO STA. 203+00

SECTION	COUNTY	TOTAL SHEETS	SHEET NO.
VARIOUS	HENRY	9	7
		CONTRACT NO. 46224	
ILLINOIS FED. AID PROJECT			

JOB NO. 260-08-U VASCORCELLES ENGINEERING CORP. DESIGN FIRM REGISTRATION NUMBER J4-F-000107