

- ① COMPACTED SUBGRADE
- ② GEOTEXTILE
- ③ AGGREGATE BASE, 4" (CA11)
- ④ BEDDING SAND, 1" (FA 1 OR 2)
- ⑤ AGGREGATE IN OPENINGS (CA11)
- ⑥ OPEN CELL PAVER BLOCKS (CONCRETE)
- ⑦ GRASS SEED FOR TOP SOIL
- ⑧ EDGE RESTRAINT
- ⑨ COMPACTED SOIL AT PERIMETER

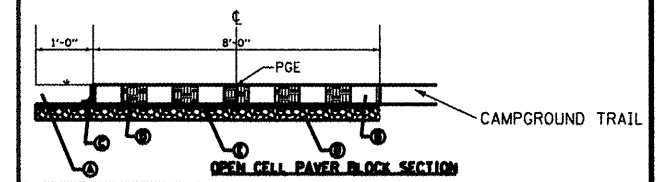

- ① PROPOSED TOPSOIL FURNISH AND PLACE, VARIABLE DEPTH
- ② OPEN CELL PAVER BLOCKS (CONCRETE)
- ③ PAVER BLOCK EDGE RESTRAINT
- ④ AGGREGATE (CA11), 6"
- ⑤ BEDDING SAND (FA 1 OR 2), 1"

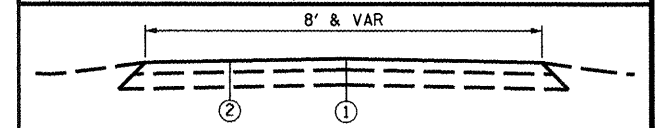

CAMPGROUND TRAIL

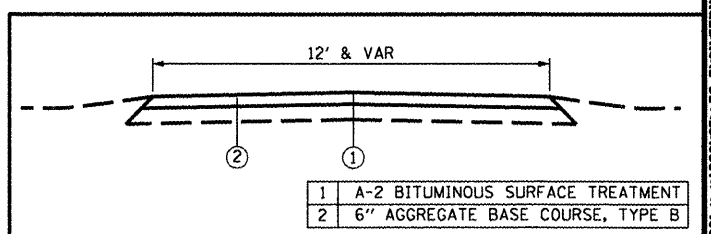
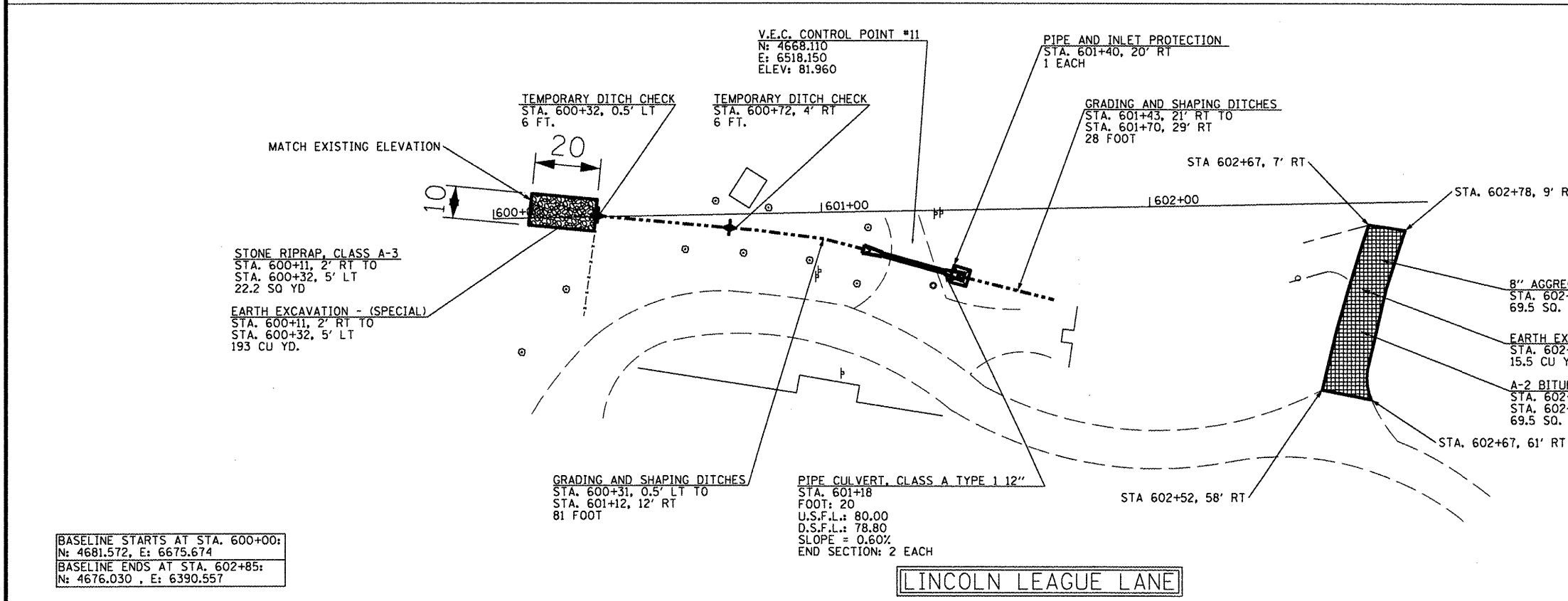

LINCOLN LEAGUE LANE

FILE NAME =
#FILE#

USER NAME = #USER#
PLOT SCALE = #SCALE#
PLOT DATE = #DATE#

DESIGNED - R.M.D.
DRAWN - J.T.T.
CHECKED - R.M.D.
DATE - 4/4/2012

REVISED -
REVISED -
REVISED -
REVISED -

STATE OF ILLINOIS
DEPARTMENT OF TRANSPORTATION

LINCOLN'S NEW SALEM
CAMPGROUND TRAIL / LINCOLN LEAGUE LANE

SCALE: 1" = 20'
SHEET NO. 7 OF 9 SHEETS
STATIONING VARIES

SECTION	COUNTY	TOTAL SHEETS	SHEET NO.
LINCOLN'S NEW SALEM	MEHARD	9	7
CONTRACT NO. 46234			
ILLINOIS FED. AID PROJECT			

JOB NO. 250-061-VASCONCELLES ENGINEERING CORP. DESIGN FIRM REGISTRATION NUMBER 184-002107