

NOTES

1. ELEVATIONS ARE SHOWN AT 25' INTERVALS AND ARE FOR INFORMATION ONLY. THE CONTRACTOR SHALL VERIFY ALL ELEVATIONS PRIOR TO CONSTRUCTION.
2. TRANSVERSE CONTRACTION JOINTS ARE TYPICALLY SPACED AT 15'. REFER TO IDOT STANDARDS 420001, 420101, 420106, 420201 AND 420401 FOR JOINT DETAILS AND SPACING.

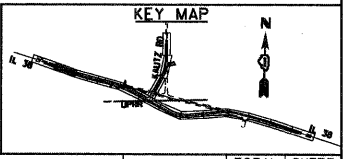
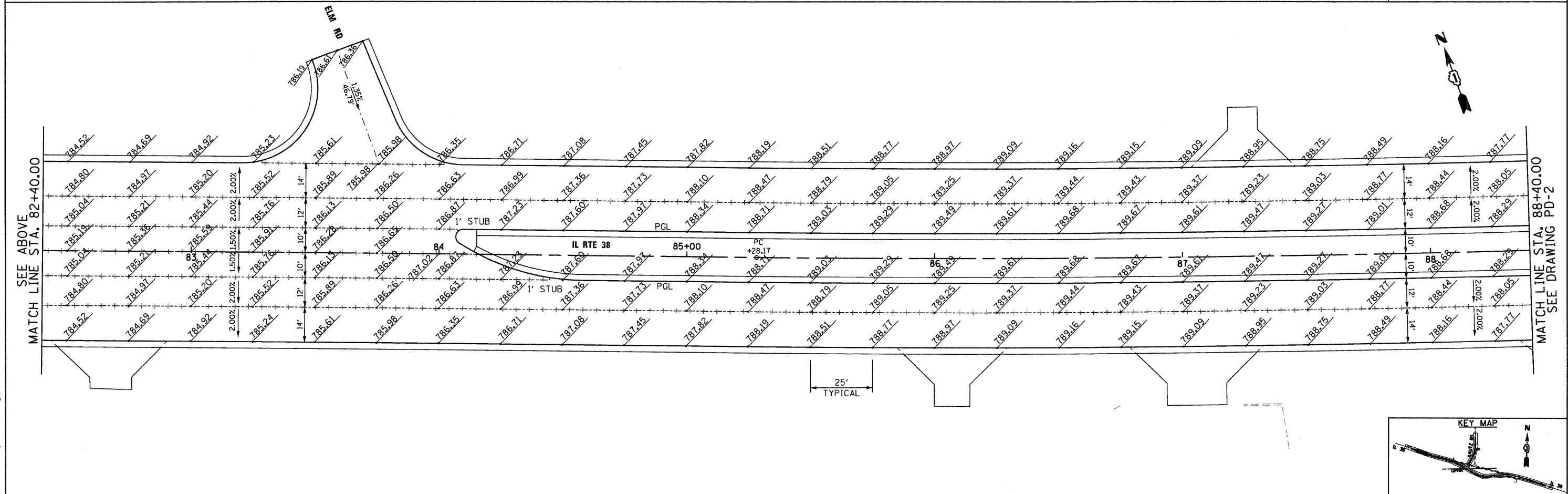
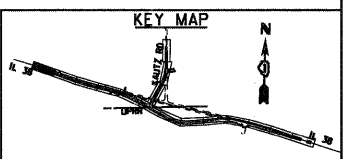

McDonough Associates Inc.
Engineers / Architects
130 East Randolph Street Chicago, Illinois 60601

FILE NAME =	USER NAME = EricG
D168122-SHT-PAVEMENT-DETAILS01.dgn	

PLOT SCALE = 1/2"=20'	DESIGNED - JTF
PLOT DATE = 12/9/2011	DRAWN - JTF
	CHECKED - EJG
	DATE - 12/09/11

REVISD -	REVISD -
REVISD -	REVISD -
REVISD -	REVISD -

**STATE OF ILLINOIS
DEPARTMENT OF TRANSPORTATION**

IL 38 PAVEMENT DETAILS

SCALE: 1"=20' SHEET NO. 1 OF 7 SHEETS STA. BEGIN TO STA. 88+40

F.A.P. RTE. 347	SECTION LY (HB & VB)	COUNTY DUPAGE/KANE	TOTAL SHEETS 421	SHEET NO. 115
PD-1		CONTRACT NO. 60122		
FED. ROAD DIST. NO. 1 ILLINOIS FED. AID PROJECT				