

- LEGEND**
- SEEDING, CLASS 2A  
- TOPSOIL, 4"
  - SEEDING, CLASS 4A (MODIFIED)  
- TOPSOIL (SEE NOTE)
  - SEEDING, CLASS 4B (MODIFIED)  
- TOPSOIL (SEE NOTE)
  - SODDING, SALT TOLERANT  
- COURSE SAND PLACEMENT 2"  
- TOPSOIL, 24"
  - EROSION CONTROL BLANKET
  - (A) MEDIAN PLANTINGS, SEE  
LANDSCAPE DETAIL SHEETS

**TOPSOIL NOTE:**  
 PROVIDE 18" TOPSOIL AND A 2" SAND LAYER IN CLASS 4A (MODIFIED) AND 4B (MODIFIED) SEEDING AREAS ON EMBANKMENT FORESLOPES FROM STATIONS 100+00 TO 120+00, AND FROM STATION 1100+00 TO 1110+00. IN ALL OTHER LOCATIONS OF CLASS 4 (MODIFIED) AND 4B (MODIFIED) SEEDING, PROVIDE 4" TOPSOIL.

- NOTES:**
1. PLAN VIEW BREAKS BETWEEN SEEDING TYPES ARE APPROXIMATE.
  2. MULCH METHOD 2 SHALL BE USED AT ALL SEEDING LOCATIONS NOT PROTECTED BY EROSION CONTROL BLANKET. HATCHING HAS BEEN OMITTED FOR CLARITY.

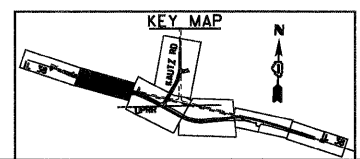
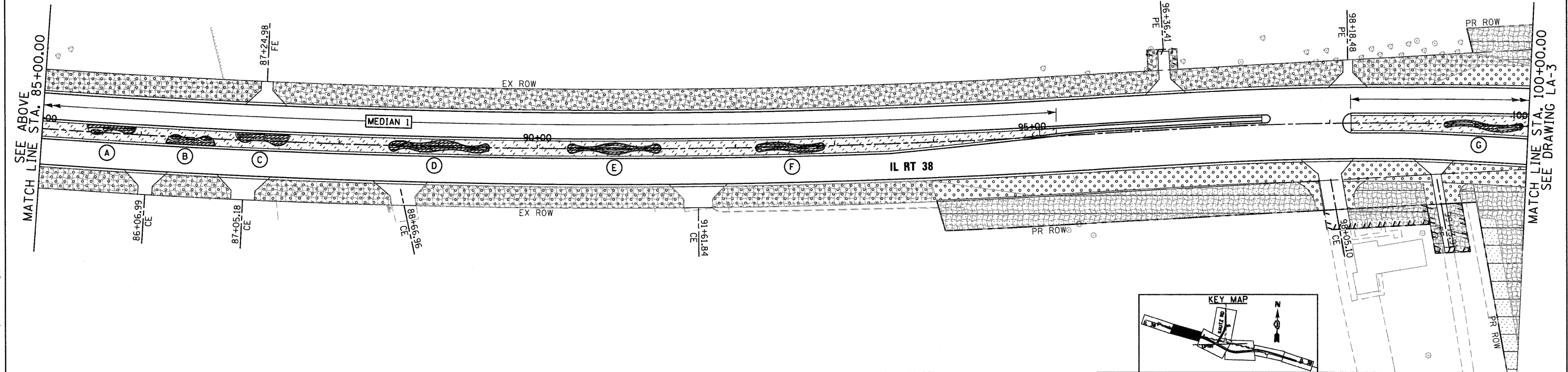
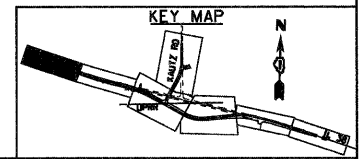

FILE NAME = 0168122-SHT-LN0SCP02.dgn	USER NAME = E-rvcG	DESIGNED - JTF	REVISED -	<b>STATE OF ILLINOIS DEPARTMENT OF TRANSPORTATION</b>	<b>LANDSCAPE PLAN</b>			F.A.P. RTE. 347	SECTION LY (HB & VB)	COUNTY DUPAGE/KANE	TOTAL SHEETS 421	SHEET NO. 132
	PLOT SCALE = 1:50	CHECKED - E.JG	REVISED -		SCALE: 1"=50'	SHEET NO. 1 OF 5 SHEETS	STA. BEGIN TO STA. 100+00	<b>LA-2</b>		CONTRACT NO. 60122		
	PLOT DATE = 12/9/2011	DATE - 12/09/11	REVISED -		FED. ROAD DIST. NO. 1   ILLINOIS   FED. AID PROJECT							