

QUANTITY
 4 (100) LINE = 64.1 ft. (19.7 m)
 21.1 sq. ft. (1.97 sq. m)

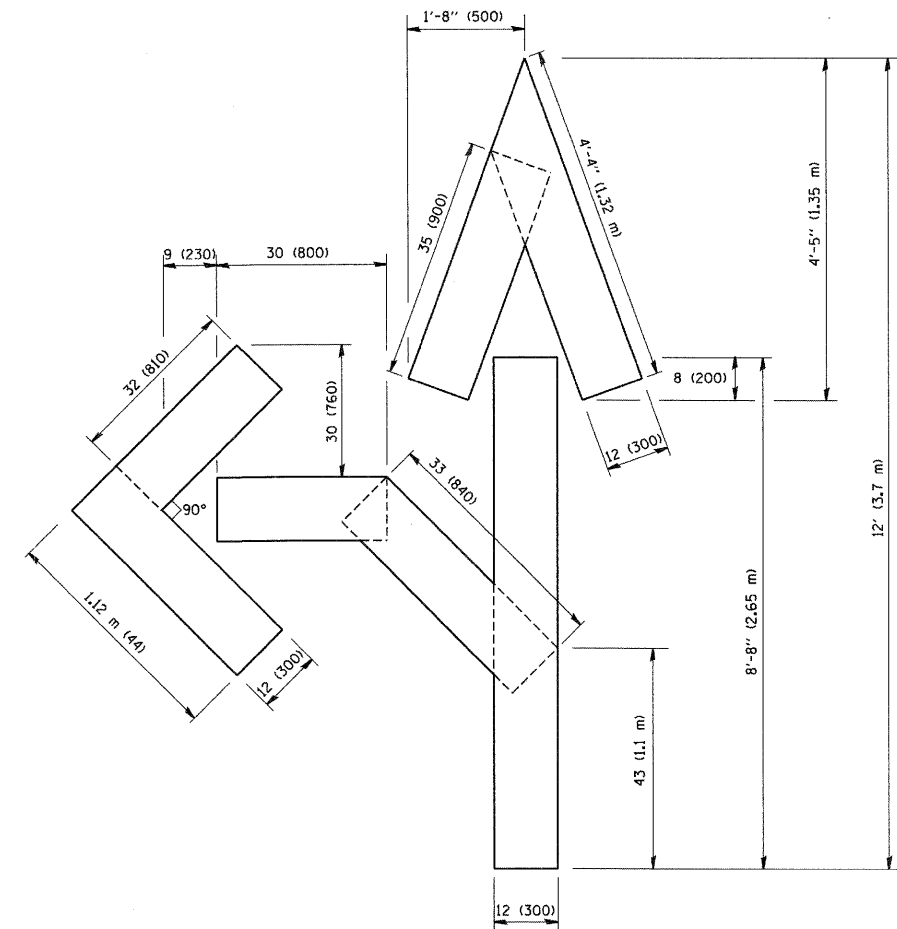

QUANTITY
 4 (100) LINE = 82.5 ft. (25.3 m)
 27.5 sq. ft. (2.53 sq. m)

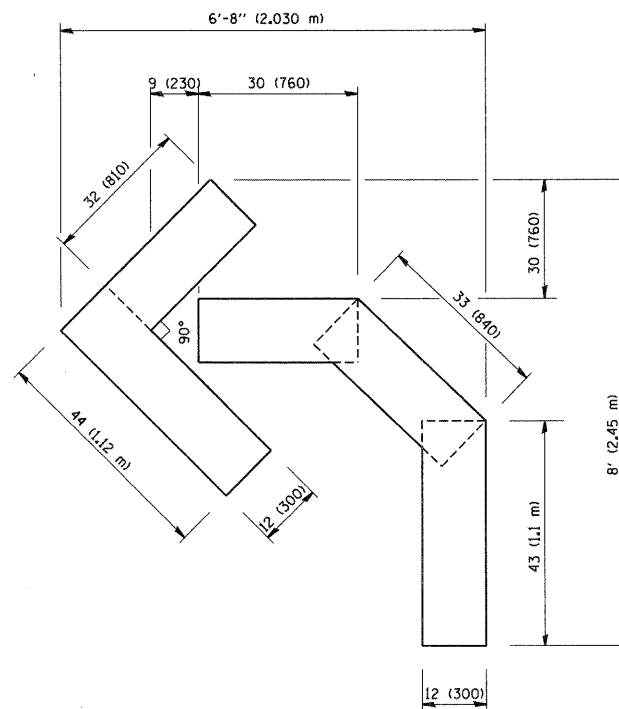

QUANTITY
 4 (100) LINE = 45.5 ft. (13.9 m)
 15.2 sq. ft. (1.39 sq. m)

All dimensions are in inches (millimeters) unless otherwise shown.

FILE NAME = W:\diststd\22x34\tcl6.dgn	USER NAME = geglienabt	DESIGNED -	REVISED -T. RAMMACHER 06-05-96	STATE OF ILLINOIS DEPARTMENT OF TRANSPORTATION	PAVEMENT MARKING LETTERS AND SYMBOLS FOR TRAFFIC STAGING		F.A.P. RTE.	SECTION	COUNTY	TOTAL SHEETS	SHEET NO.	
	PLOT SCALE = 50.0000' / IN.	DRAWN -	REVISED -T. RAMMACHER 11-04-97		SCALE: NONE	SHEET NO. 1 OF 1 SHEETS	STA.	TO STA.	347	LY (HB & VB)	DUPAGE/KANE	421
PLOT DATE = 1/4/2008	DATE - 09-18-94	CHECKED -	REVISED -T. RAMMACHER 03-02-98									
			REVISED -E. GOMEZ 08-28-00									

TC-16 CONTRACT NO. 60122
 FED. ROAD DIST. NO. 1 [ILLINOIS] FED. AID PROJECT