

U.S. ROUTE 30 (LINCOLN HIGHWAY)
 STA 493+00 TO STA 500+00
 PROPOSED IMPROVEMENT
 STAGE 1

PROP. HMA SURFACE COURSE,
 MIX "D", N50
 PROP. SUB-BASE GRANULAR
 MATERIAL, TYPE B, 4" (TYP.)

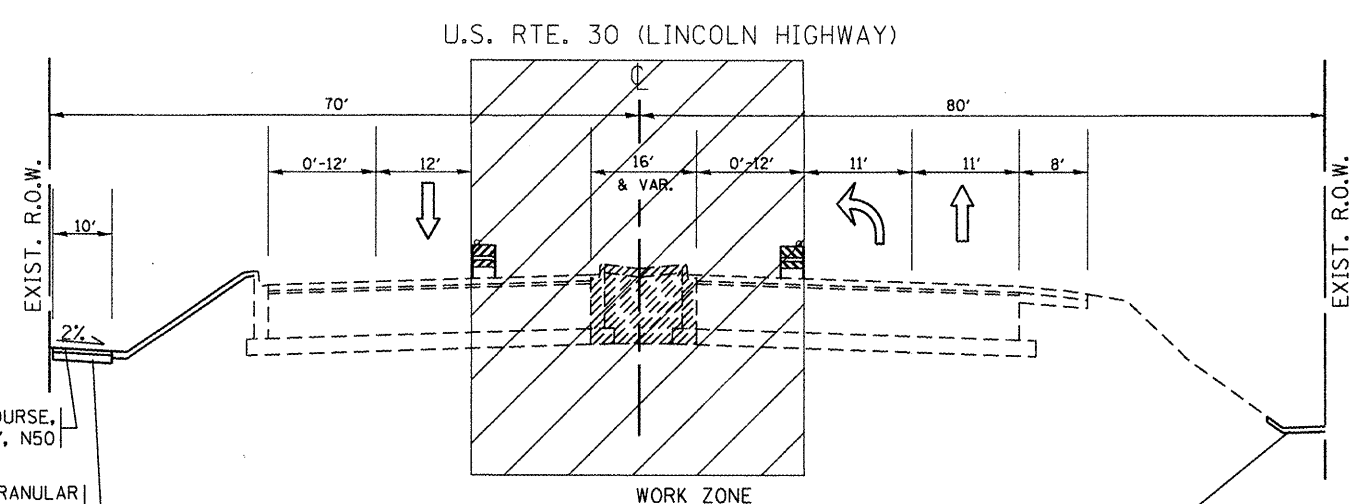

U.S. ROUTE 30 (LINCOLN HIGHWAY)
 STA 493+00 TO STA 500+00
 PROPOSED IMPROVEMENT
 STAGE 3

PROP. GRADING AND SHAPPING DITCHES

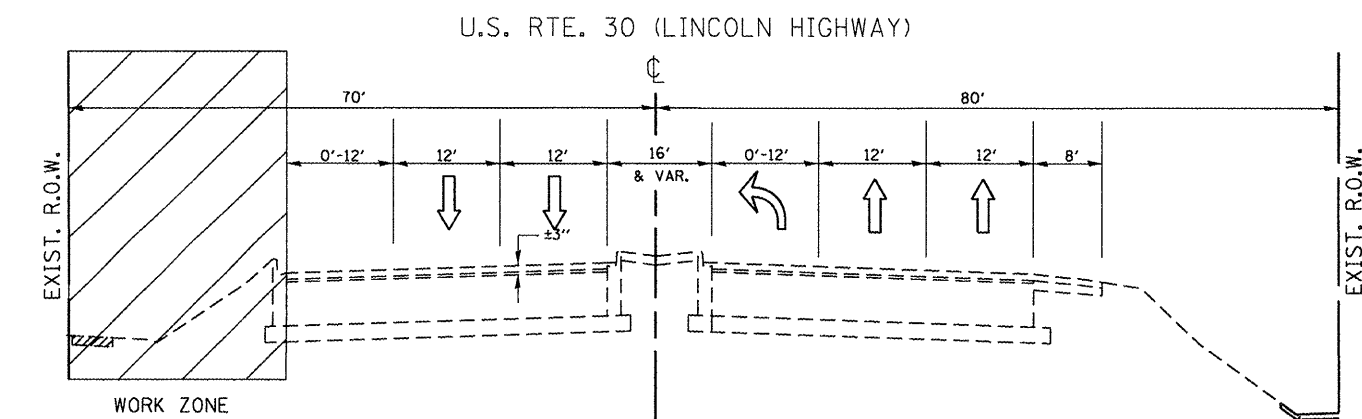

U.S. ROUTE 30 (LINCOLN HIGHWAY)
 STA 493+00 TO STA 500+00
 PROPOSED IMPROVEMENT
 STAGE 2

PROP. GRADING AND SHAPPING DITCHES

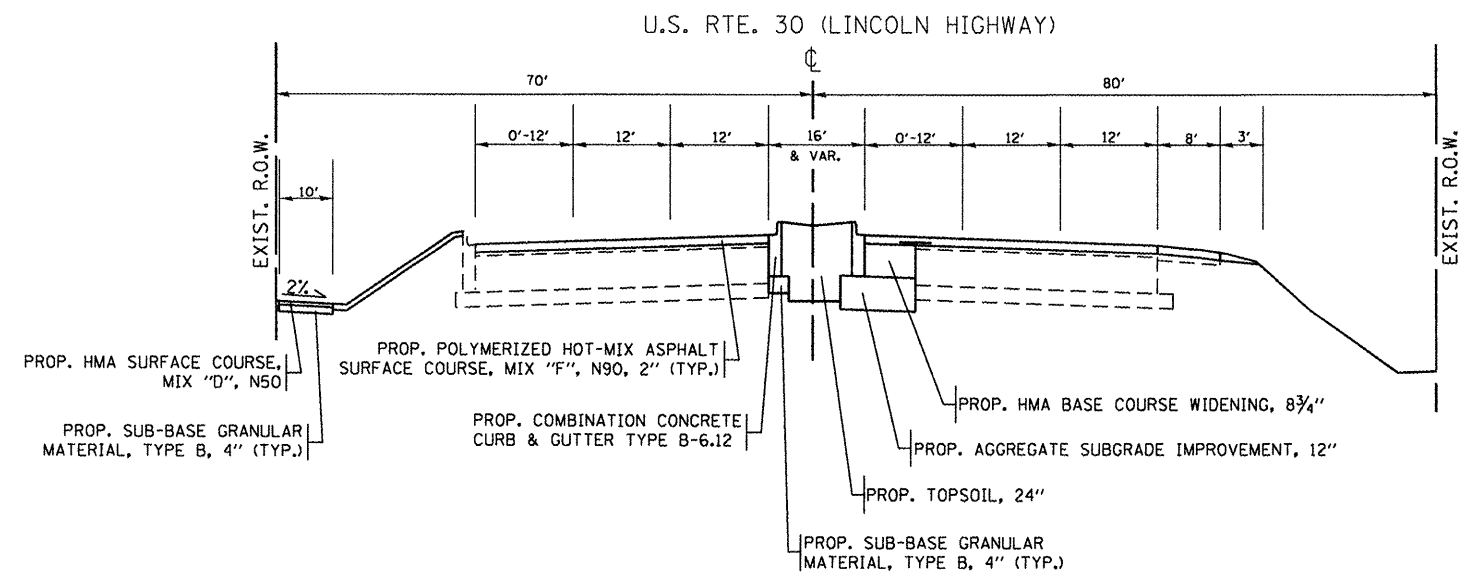

U.S. ROUTE 30 (LINCOLN HIGHWAY)
 STA 493+00 TO STA 500+00
 PROPOSED IMPROVEMENT
 STAGE 4

PROP. HMA SURFACE COURSE,
 MIX "D", N50
 PROP. SUB-BASE GRANULAR
 MATERIAL, TYPE B, 4" (TYP.)
 PROP. POLYMERIZED HOT-MIX ASPHALT
 SURFACE COURSE, MIX "F", N90, 2" (TYP.)
 PROP. COMBINATION CONCRETE
 CURB & GUTTER TYPE B-6.12
 PROP. HMA BASE COURSE WIDENING, 8 3/4"
 PROP. AGGREGATE SUBGRADE IMPROVEMENT, 12"
 PROP. TOPSOIL, 24"
 PROP. SUB-BASE GRANULAR
 MATERIAL, TYPE B, 4" (TYP.)

Rev. Sheet 6-1-12

FILE NAME =	USER NAME = mdyjg	DESIGNED -	REVISED -
cr:\pw\work\p\wdo\t\mdyjg\dms\2836\PI5688	8-staging-Design.dgn	DRAWN -	REVISED -
	PLDT SCALE = 100.0000' / 1in.	CHECKED -	REVISED -
	PLDT DATE = 4/26/2012	DATE -	REVISED -

**STATE OF ILLINOIS
 DEPARTMENT OF TRANSPORTATION**

SUGGESTED STAGING AND TRAFFIC CONTROL TYPICAL SECTION US 30 AT CENTRAL AVE.			
SCALE:	SHEET NO.	OF SHEETS	STA. TO STA.

F.A.P. RTE.	SECTION	COUNTY	TOTAL SHEETS	SHEET NO.
353	23-N-4	COOK	68	19
ILLINOIS FED. AID PROJECT				CONTRACT NO. 60L21