

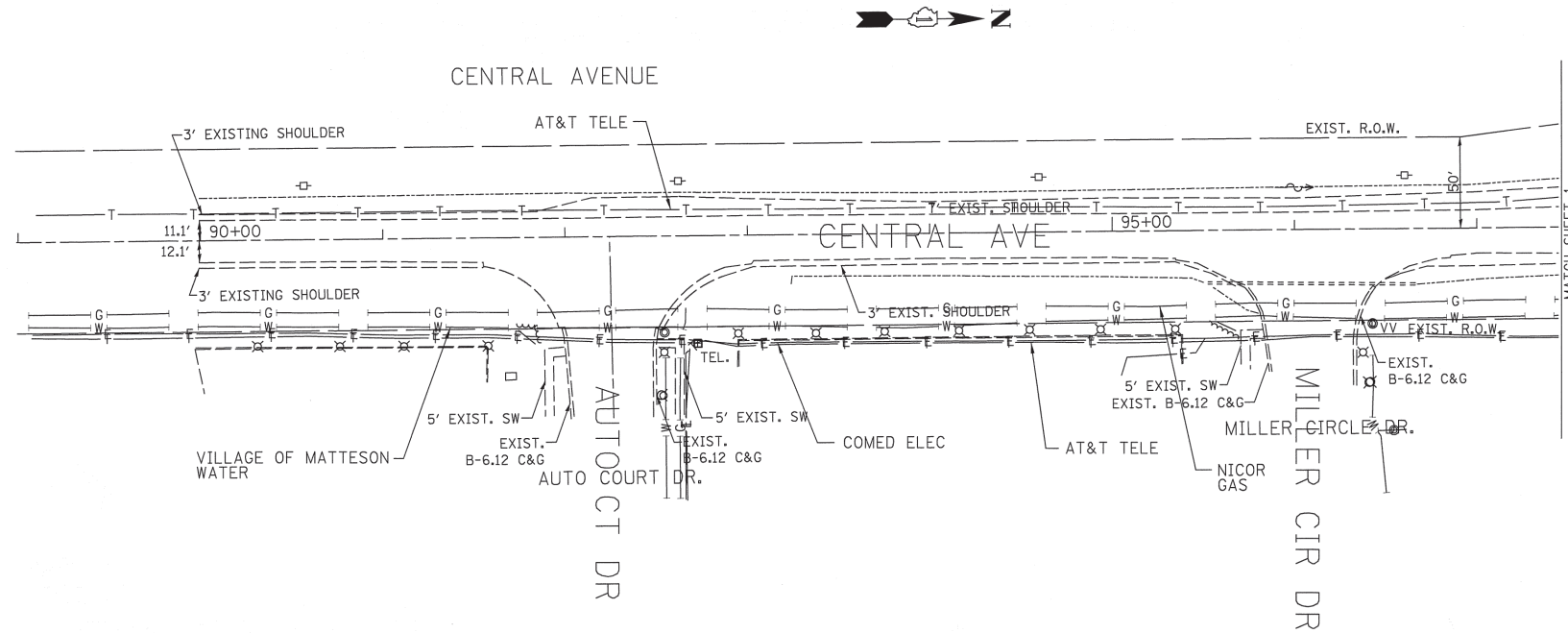

UTILITY OWNERS	
COMED	= ELECTRIC
AT&T	= TELEPHONE
COMCAST	= FIBER OPTIC
COMCAST	= CATV
NICOR	= GAS
VILLAGE OF MATTESON	= WATER



— A — A —	AERIAL UTILITY UNKNOWN
— CTV — CTV —	CABLE TV
— T — T —	TELEPHONE
— G — G —	GAS
— E — E —	ELECTRIC
— W — W —	WATER
— FO — FO —	FIBER OPTIC
— S — S —	SEWER
⊕	TBE TEST HOLE

Utilities shown on these plans as depicted in the legend have been investigated by Cardno TBE in accordance with SUE Industry Standards. All other information shown has been provided to Cardno TBE by others. Cardno TBE's SUE field investigation was performed 7/07/11 through 8/05/11. Changes to utilities after 8/05/11 may have been made and therefore may result in variances from this plan. Consideration should be given to updating this plan if deemed advisable prior to final design and construction.

ALL UTILITIES SHOWN QUALITY LEVEL "B" UNLESS NOTED OTHERWISE.

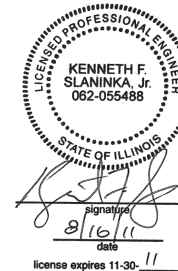

TBE Job No. IL09510443
SUE Plan Pages: 3 of 4

Utility Quality Level "A" : Test Hole
Utility Quality Level "B" : Designating
Utility Quality Level "C" : Research with Survey
Utility Quality Level "D" : Records Research

DESIGNED	EG	REVISED
DRAWN	KLC	REVISED
CHECKED	KFS	REVISED
DATE	8/15/11	REVISED

STATE OF ILLINOIS
DEPARTMENT OF TRANSPORTATION

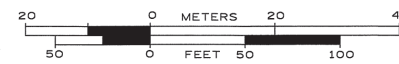

US RT. 30 at Central Avenue in
Matteson, IL

F.A.P. RTE.	SECTION	COUNTY	TOTAL SHEETS	SHEET NO.
353	23-N-4	Cook	68	25B
FED. ROAD DIST. NO. ILLINOIS IDOT Project No.			Contract No. 60L21	