

VILLAGE OF STICKNEY | TOWN OF CICERO  
 WEST SIDE OF CICERO AVE.

CHICAGO MOTOR SPEEDWAY/  
 SPORTSMANS PARK

**NOTE:**  
 THE ENVIRONMENTAL FIRM IS REQUIRED TO CONTINUOUSLY MONITOR FOR WORKER PROTECTION AND SOIL CONTAMINATION AT SEVERAL AREAS. SEE SPECIAL PROVISION AND SUPPLEMENTAL SPECIFICATIONS FOR DETAILS.

IL. RTE. 50 (CICERO AVENUE)



**END PROJECT**  
**STA. 544+44.44**

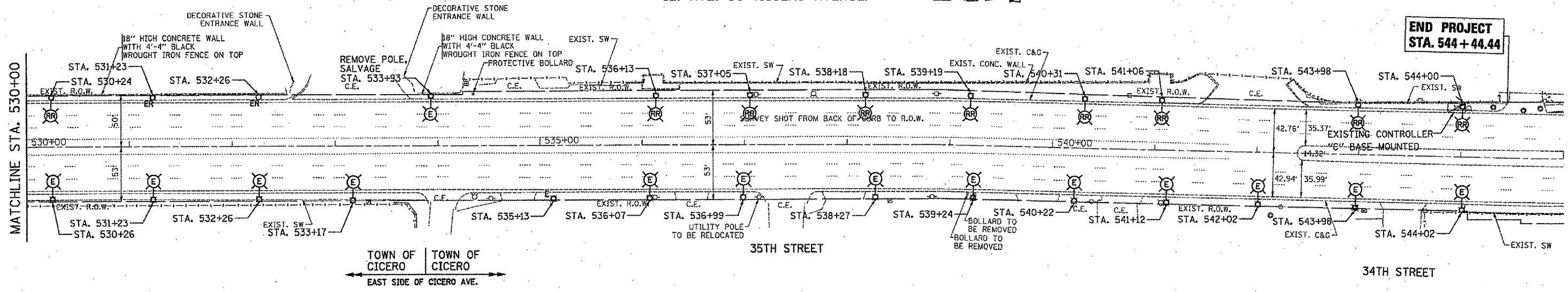

TOWN OF CICERO | TOWN OF CICERO  
 EAST SIDE OF CICERO AVE.

FILE NAME * #FILES#	USER NAME * #USER#	DESIGNED - MK	REVISED -	<b>STATE OF ILLINOIS DEPARTMENT OF TRANSPORTATION</b>	<b>IL RTE. 50 (CICERO AVE.) - (34TH STREET TO PERSHING ROAD) EXISTING LIGHTING PLAN</b>			F.A.P. RTE. 350	SECTION 2010-050-I	COUNTY COOK	TOTAL SHEETS 44	SHEET NO. 18
	PLOT SCALE = #SCALE#	DRAWN - YJ	REVISED -		SCALE: 1" = 50'	SHEET NO. OF SHEETS	STA. 530+00.00 TO STA. 545+00.00	CONTRACT NO. 60L26				
	PLOT DATE = #DATE#	CHECKED - GR	REVISED -		ILLINOIS FED. AID PROJECT							
		DATE - 10/14/11	REVISED -									