

F.A.P. RTE.	SECTION	COUNTY	TOTAL SHEETS	SHEET NO.
348	3127-2-SB-1	COOK	19	1
		ILLINOIS	CONTRACT NO. 60M71	

STATE OF ILLINOIS  
DEPARTMENT OF TRANSPORTATION  
DIVISION OF HIGHWAYS

FOR INDEX OF SHEETS, SEE SHEET NO. 2

**PROPOSED  
HIGHWAY PLANS**

F.A.P. ROUTE 348 (HARLEM AVE)  
OVER MIDLOTHIAN CREEK  
SECTION 3127-2-SB-1  
BRIDGE DECK OVERLAY  
STRUCTURE NO. 016-0963  
COOK COUNTY

C-91-156-11

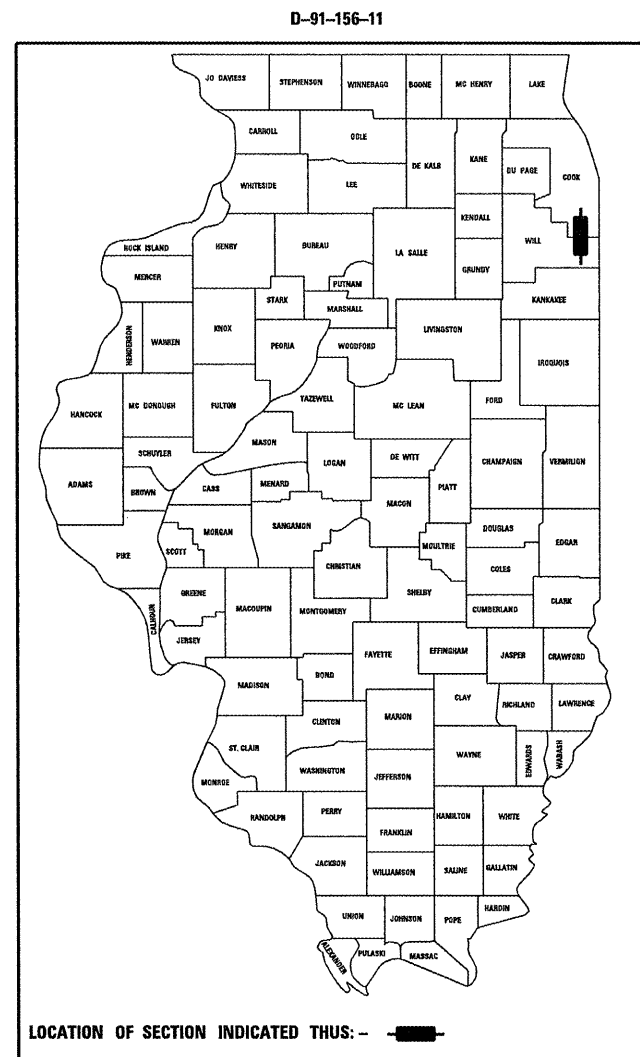

EXISTING ADT = 36100 (2009)  
SPEED LIMIT = 40 MPH

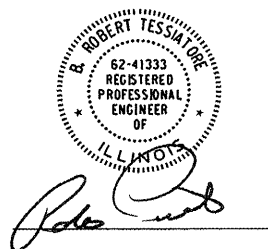

ROBERT TESSIATORE  
DATE: 3/30/2012  
EXP.: 11/30/2013  
SHEET: 1-6

PROJECT IS IN THE VILLAGE OF TINLEY PARK.

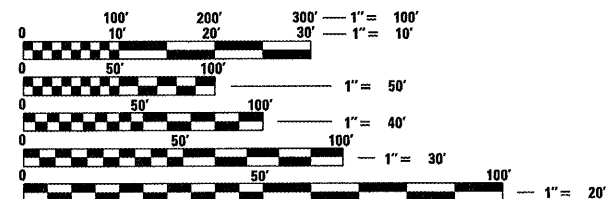

FULL SIZE PLANS HAVE BEEN PREPARED USING STANDARD ENGINEERING SCALES. REDUCED SIZED PLANS WILL NOT CONFORM TO STANDARD SCALES. IN MAKING MEASUREMENTS ON REDUCED PLANS, THE ABOVE SCALES MAY BE USED.

J.U.L.I.E.  
JOINT UTILITY LOCATION INFORMATION FOR EXCAVATION  
1-800-892-0123  
OR 811

PROJECT ENGINEER: ROBERT BORO 847-705-4237  
PROJECT MANAGER: ISSAM RAYYAN 847-705-4178

CONTRACT NO. 60M71

ORLAND TOWNSHIP  
SEC 25 - SE 1/4  
R12E

BREMEN TOWNSHIP  
SEC 30 - SW 1/4  
R13E

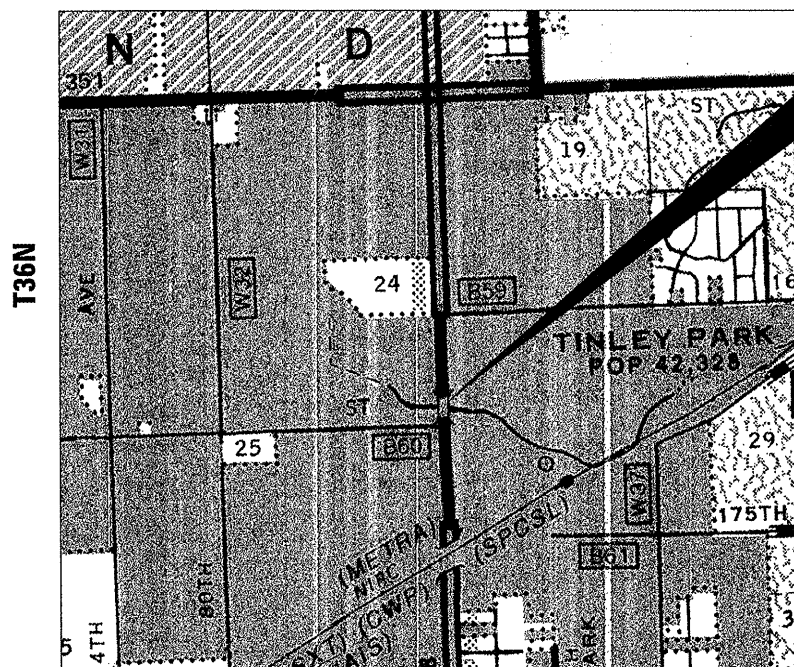

BRIDGE REPAIR  
SN: 016-0963  
BEGIN STA 285+92  
END STA 287+08

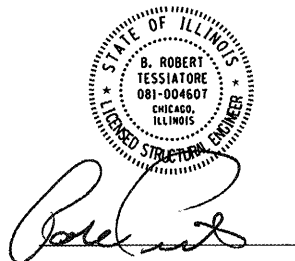

ROBERT TESSIATORE  
DATE: 3/30/2012  
EXP.: 11/30/2012  
SHEET: 8-12

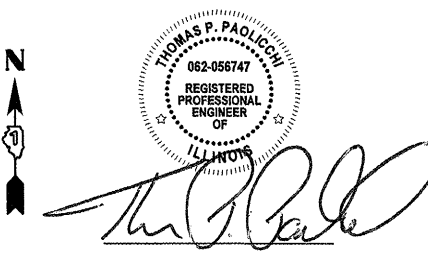

THOMAS P. PAOLICCHI, P.E.  
DATE: 3/30/2012  
EXP.: 11/30/2013  
SHEET: 7

STATE OF ILLINOIS  
DEPARTMENT OF TRANSPORTATION  
DIVISION OF HIGHWAYS

SUBMITTED APRIL 3 20 12  
Diane O'Keefe / ASW  
DEPUTY DIRECTOR OF HIGHWAYS, REGION ENGINEER

May 11 20 12  
John D. Brammell, P.E./pc  
ENGINEER OF DESIGN AND ENVIRONMENT

May 11 20 12  
William R. Frey, Jr.  
DIRECTOR OF HIGHWAYS, CHIEF ENGINEER

PRINTED BY THE AUTHORITY  
OF THE STATE OF ILLINOIS



GROSS LENGTH = 113 FT. = 0.021 MILE  
NET LENGTH = 113 FT. = 0.021 MILE