

ALIGNMENT DATA

121	N 870746.07 E 19618.70
122	N 873087.80 E 19673.34
123	N 873188.31 E 19674.13
124	N 874555.65 E 19503.02

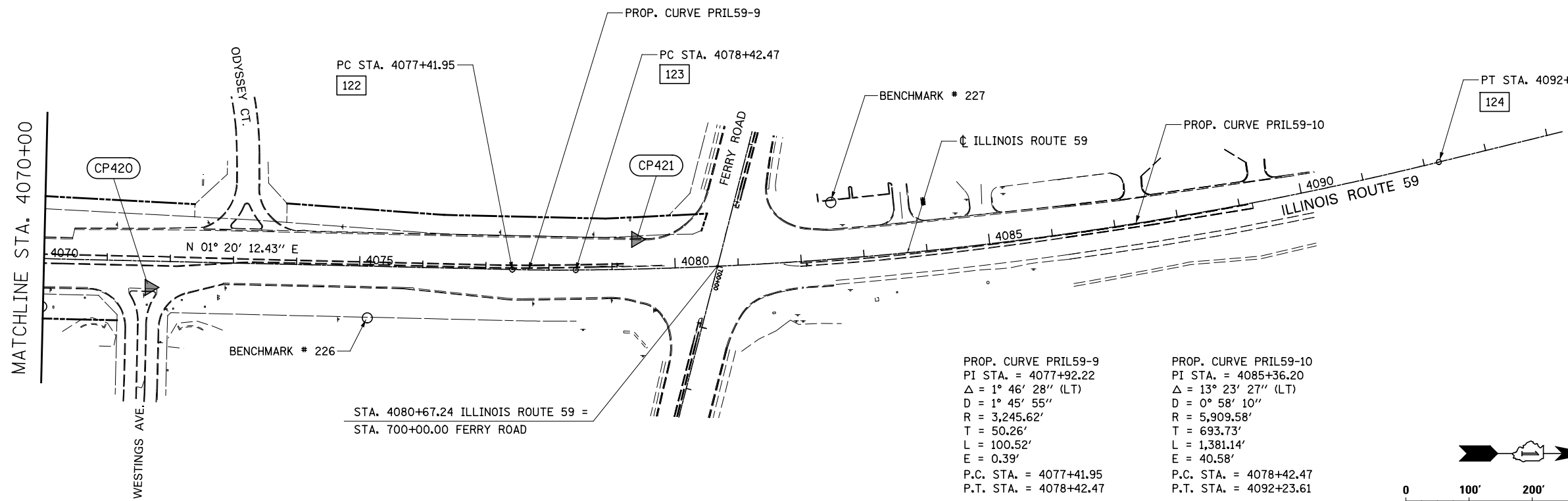

PROP. CURVE PRIL59-9
 PI STA. = 4077+92.22
 $\Delta = 1^\circ 46' 28''$ (LT)
 $D = 1^\circ 45' 55''$
 $R = 3,245.62'$
 $T = 50.26'$
 $L = 100.52'$
 $E = 0.39'$
 P.C. STA. = 4077+41.95
 P.T. STA. = 4078+42.47

PROP. CURVE PRIL59-10
 PI STA. = 4085+36.20
 $\Delta = 13^\circ 23' 27''$ (LT)
 $D = 0^\circ 58' 10''$
 $R = 5,909.58'$
 $T = 693.73'$
 $L = 1,381.14'$
 $E = 40.58'$
 P.C. STA. = 4078+42.47
 P.T. STA. = 4092+23.61

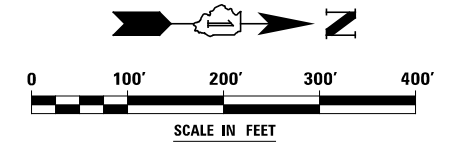

FILE NAME =	USER NAME = *USER*	DESIGNED <i>CEO</i>	REVISED
FILEL		DRAWN <i>KES</i>	REVISED -
	PLOT SCALE = *SCALE*	CHECKED <i>PJO</i>	REVISED -
	PLOT DATE = *DATE*	DATE <i>03-22-2012</i>	REVISED -

STATE OF ILLINOIS
DEPARTMENT OF TRANSPORTATION

ALIGNMENT, TIES, AND BENCHMARKS

SCALE: AS SHOWN SHEET NO. 4 OF 14 SHEETS STA. 4046+00 TO STA. 4092+23.61

F.A.P. RTE.	SECTION	COUNTY	TOTAL SHEETS	SHEET NO.
338	2011-037-DTR	DUPAGE	138	12
CONTRACT NO. 60P43				
ILLINOIS FED. AID PROJECT				