

PROP. CURVE PR-NA-1  
 PI STA. = 400+63.49  
 $\Delta = 10^\circ 53' 54''$  (RT)  
 $D = 2^\circ 29' 59''$   
 $R = 2,292.00'$   
 $T = 218.64'$   
 $L = 435.96'$   
 $E = 10.40'$   
 P.C. STA. = 398+44.84  
 P.T. STA. = 402+80.81

NOTE:  
 SEE ILLINOIS ROUTE 59 SHEETS  
 FOR ALIGNMENT & TIE DATA

ALIGNMENT DATA

|     |                           |
|-----|---------------------------|
| 600 | N 863059.19<br>E 17516.23 |
| 601 | N 863050.51<br>E 18961.05 |
| 602 | N 863006.58<br>E 19394.14 |
| 603 | N 862671.41<br>E 21080.34 |

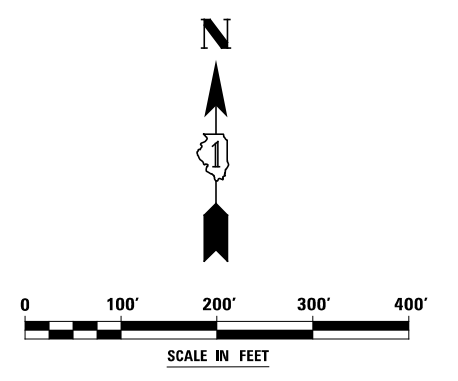
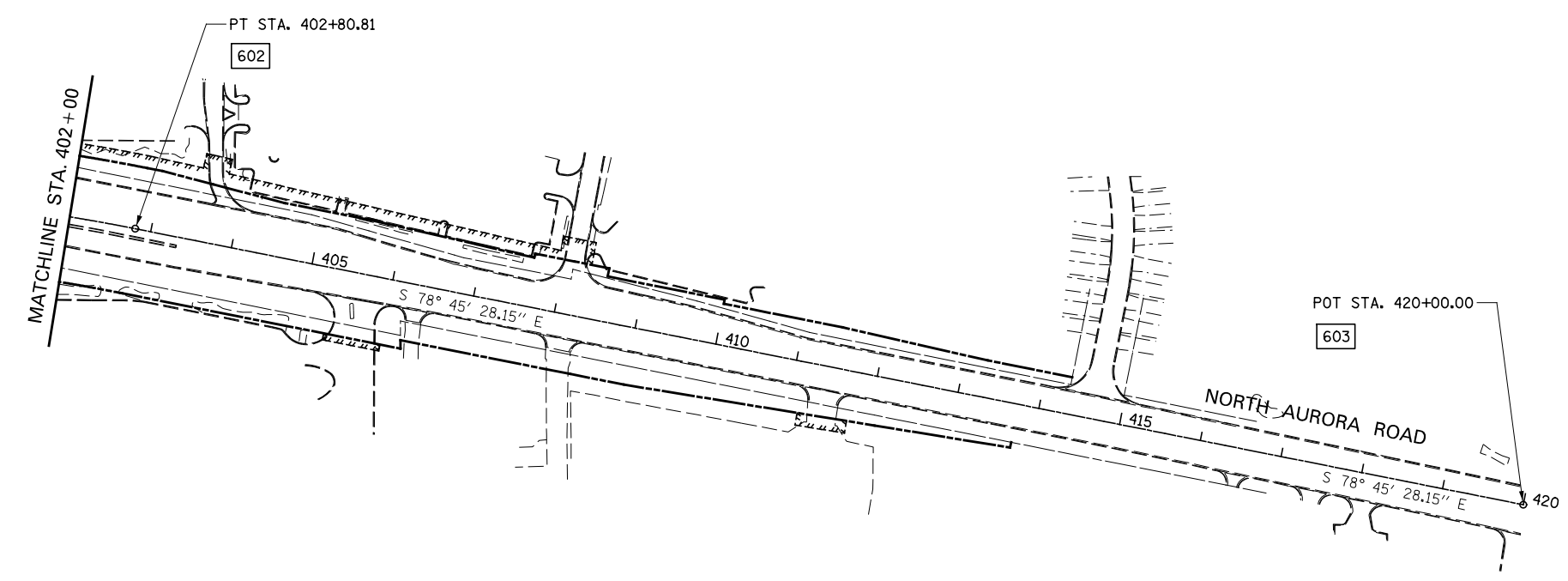

|             |                      |                        |           |
|-------------|----------------------|------------------------|-----------|
| FILE NAME = | USER NAME = *USER*   | DESIGNED <i>CEO</i>    | REVISED   |
| *FILE#      |                      | DRAWN <i>KES</i>       | REVISED - |
|             | PLOT SCALE = *SCALE* | CHECKED <i>PJO</i>     | REVISED - |
|             | PLOT DATE = *DATE*   | DATE <i>03-22-2012</i> | REVISED - |

STATE OF ILLINOIS  
 DEPARTMENT OF TRANSPORTATION

ALIGNMENT, TIES, AND BENCHMARKS

SCALE: AS SHOWN SHEET NO. 7 OF 14 SHEETS STA. 384+00 TO STA. 420+00

| F.A.P. RTE.               | SECTION      | COUNTY | TOTAL SHEETS | SHEET NO. |
|---------------------------|--------------|--------|--------------|-----------|
| 338                       | 2011-037-DTR | DUPAGE | 138          | 15        |
| CONTRACT NO. 60P43        |              |        |              |           |
| ILLINOIS FED. AID PROJECT |              |        |              |           |