

Bench Mark: All elevations are based upon the bridge having an elevation of 526.1 at centerline trunnion as shown on the plans for the existing bridge dated 1931.

Existing Structure: S.N. 099-9903 was originally constructed in 1932 to carry Brandon Road over the Des Plaines River and reconstructed in 1990. The structure is a double leaf Trunnion Bascule Bridge with a moveable span of 151'-0".

An assigned detour route will be utilized to maintain vehicular traffic, but the channel will remain open to river traffic.

No Salvage.

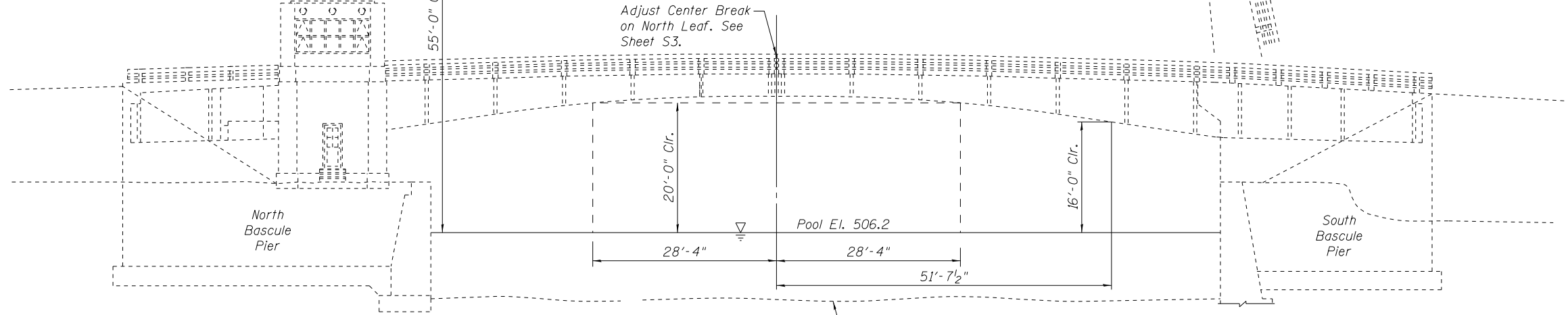
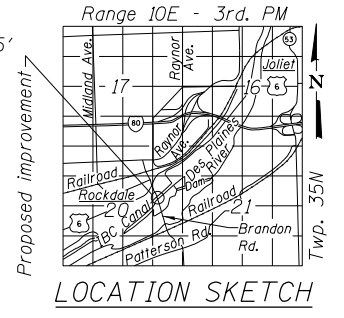
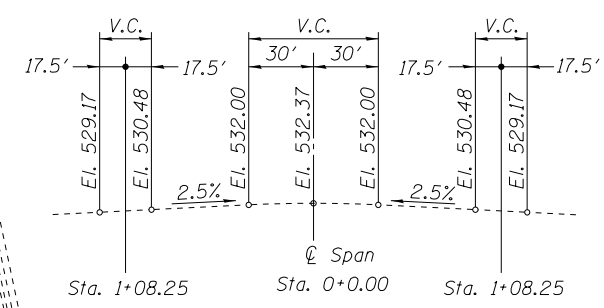
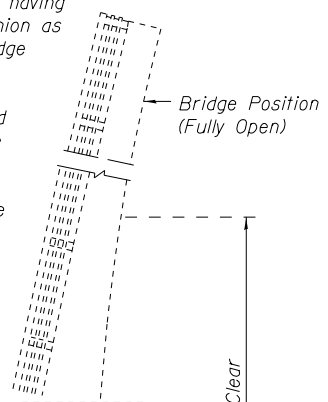

SCOPE OF WORK

1. Adjust center break on North Leaf.

DESIGN SPECIFICATIONS

2002 AASHTO Standard Specifications for Highway Bridges (17th Edition)
 1988 AASHTO Standard Specifications for Movable Bridges (5th Edition)

LOADING HS20-44



COLLINS ENGINEERS, INC.
 JAMES M. HAMELKA
 NO. 81-6116
 EXPIRES 11-30-2012

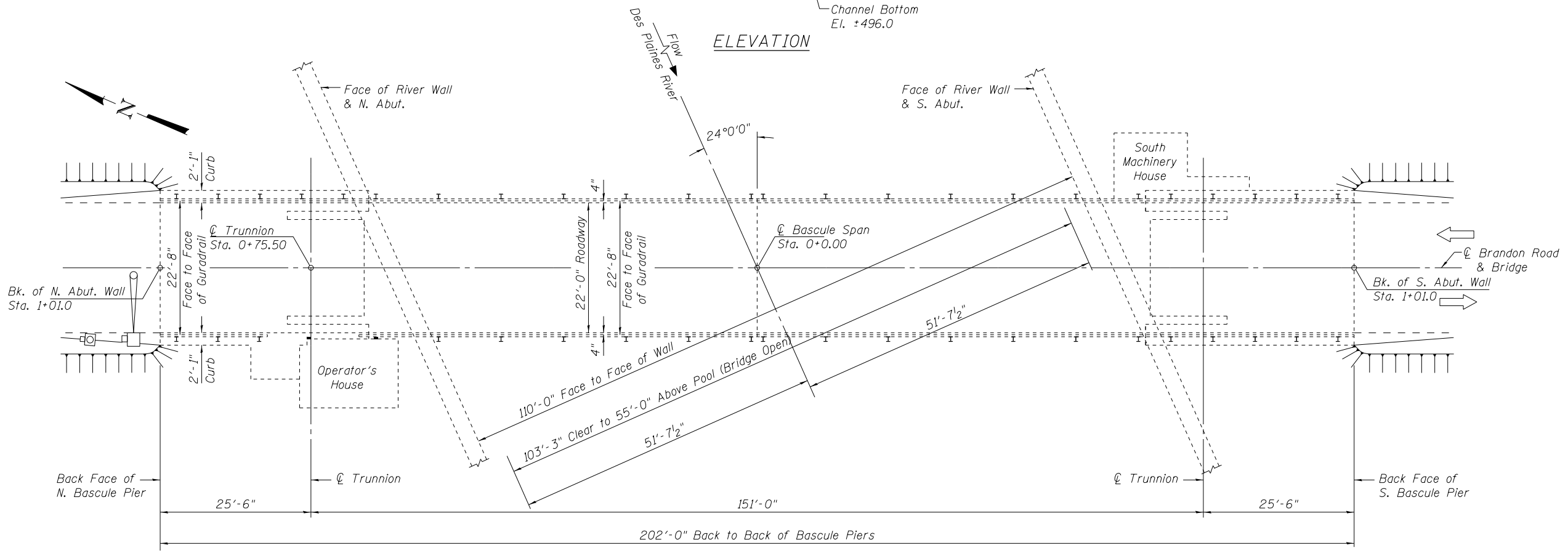

PLAN

FILE NAME =	USER NAME =	DESIGNED - AMS	REVISER -	STATE OF ILLINOIS DEPARTMENT OF TRANSPORTATION	GENERAL PLAN AND ELEVATION BRANDON ROAD OVER DES PLAINES RIVER STRUCTURE NO. 099-9903	F.A.U. RTE.	SECTION	COUNTY	TOTAL SHEETS	SHEET NO.	
		CHECKED - JMH	REVISER -			341	2011-065-BR	WILL	33	28	
		DRAWN - PRH	REVISER -			CONTRACT NO. 60P84					
		CHECKED - AMS	REVISER -			ILLINOIS FED. AID PROJECT					