

**MAINTENANCE OF TRAFFIC GENERAL NOTES**

THE SUGGESTED STAGES OF CONSTRUCTION AND TRAFFIC CONTROL PLANS SHALL SERVE AS A GUIDE FOR SAFE DIVERSION OF TRAFFIC DURING EXECUTION OF THIS CONTRACT. HOWEVER, THE CONTRACTOR MAY IMPROVE OR MODIFY THE TRAFFIC CONTROL PLANS TO MEET CONSTRUCTION NEEDS BUT NOT AT THE EXPENSE OF PUBLIC SAFETY OR CONVENIENCE. ANY CHANGES TO THE TRAFFIC CONTROL PLAN SHALL BE SUBMITTED TO THE ENGINEER FOR APPROVAL.

THE CONTRACTOR SHALL BE REQUIRED TO MAINTAIN TRAFFIC IN ACCORDANCE WITH THE TRAFFIC CONTROL PLANS, SPECIAL PROVISIONS, APPLICABLE STATE STANDARDS, AND AS DIRECTED BY THE ENGINEER.

CONTRACTOR SHALL MAINTAIN A MINIMUM OF ONE THROUGH LANE IN EACH DIRECTION THROUGH OUT THE PROJECT AREA AT ALL TIMES.

THE CONTRACTOR SHALL BE REQUIRED TO MAINTAIN ACCESS TO ALL ENTRANCES, APPROACHES, AND TEMPORARY ROADS WITHIN THE PROJECT LIMITS. THIS WORK IS TO BE PAID FOR AT THE CONTRACT UNIT PRICE PER TON, "AGGREGATE SURFACE COURSE, TYPE B."

THE ENGINEER SHALL BE INFORMED 48 HOURS IN ADVANCE OF ANY CHANGE TO THE SUGGESTED STAGES OF CONSTRUCTION AND TRAFFIC CONTROL PLANS

TYPE II BARRICADES SHALL BE PROVIDED AS SHOWN IN THE PLANS AND SPACED 50 FEET CENTER TO CENTER ON TANGENT, AND 15 FEET CENTER TO CENTER ON TAPERS AND CURVES.

THE CONTRACTOR SHALL PROVIDE ADEQUATE TEMPORARY DRAINAGE AND EROSION CONTROL PROTECTION DURING ALL PHASES OF CONSTRUCTION.

ALL EXISTING SIGNS THAT CONFLICT WITH THE TRAFFIC CONTROL PLAN SHALL BE COVERED OR REMOVED IN ACCORDANCE WITH ARTICLE 107.25 OF THE STANDARD SPECIFICATIONS.

THE CONTRACTOR SHALL PROVIDE, INSTALL, MAINTAIN AND REMOVE ALL SIGNS AND SIGN SUPPORTS REQUIRED FOR TRAFFIC CONTROL AND PROTECTION.

THE CONTRACTOR SHALL PLACE A CHANGEABLE MESSAGE SIGN AT EACH END OF THE PROJECT AND/OR AS DIRECTED BY THE ENGINEER TO INFORM MOTORISTS OF UPCOMING CONSTRUCTION ACTIVITIES. THE MESSAGE SIGNS WITH THE APPROPRIATE INFORMATION SHALL BE IN PLACED TWO WEEKS BEFORE START OF CONSTRUCTION ACTIVITY. THIS WORK IS TO BE PAID FOR AT THE CONTRACT UNIT PRICE PER CALENDAR MONTH, "CHANGEABLE MESSAGE SIGN".

THE CONTRACTOR SHALL PLACE "DRIVEWAY ENTRANCE" SIGNS AT EVERY COMMERCIAL ENTRANCE WITHIN THE PROJECT LIMITS WHERE ENTRANCE IS OBSTRUCTED DUE TO CONSTRUCTION AND/OR AS DIRECTED BY THE ENGINEER. SEE TEMPORARY INFORMATION SIGNS SHEET.

ALL TEMPORARY INFORMATION SIGNS SHALL NOT BE PAID FOR SEPARATELY BUT SHALL BE INCLUDED IN THE CONTRACT UNIT PRICE PER LUMP SUM FOR "TRAFFIC CONTROL AND PROTECTION SPECIAL".

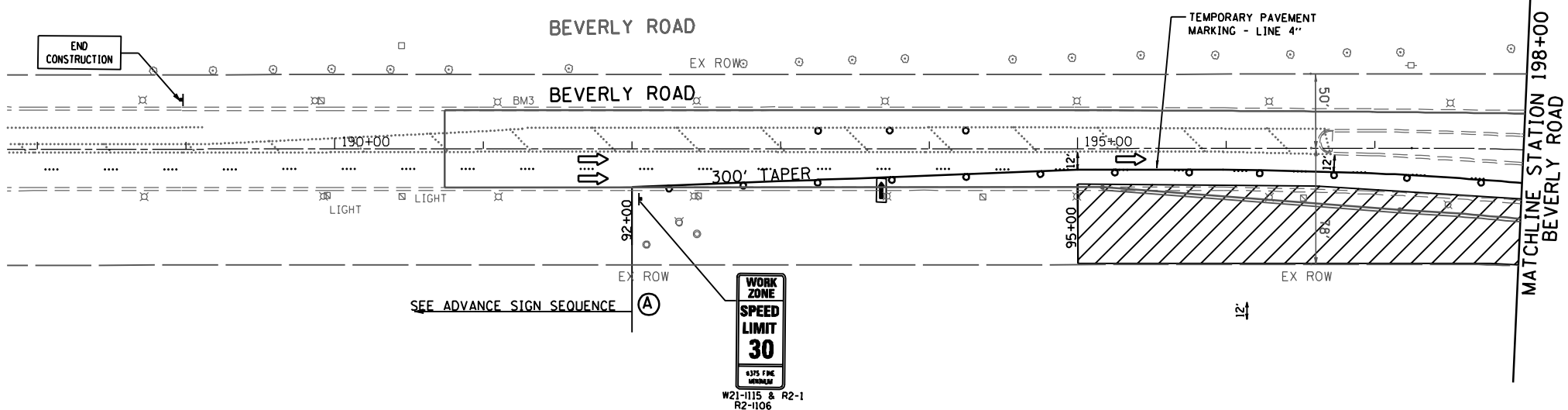
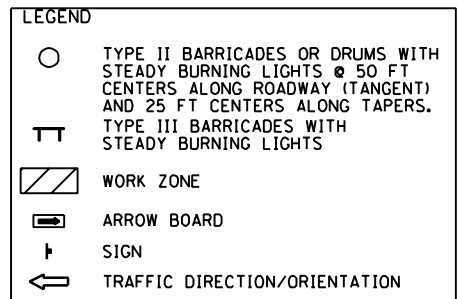

FILE NAME : p:\2009\me09086-ver-ver-ph1\cadd\1038-IL72-Beverly\Shvs\0160P90-sht-Stage1.dgn  
 USER : ME09086  
 MILLENNIA PROFESSIONAL SERVICES

200 22ND Street, Suite 216, Lombard, IL 60148  
 630.705.0110 voice, 630.839.2566 fax  
 www.mps-il.com  
**MILLENNIA PROFESSIONAL SERVICES**

DESIGNED -	CJD	REVISED -	
DRAWN -	CJD	REVISED -	
CHECKED -	TVN	REVISED -	
DATE -	4/3/2012	REVISED -	

**STATE OF ILLINOIS**  
**DEPARTMENT OF TRANSPORTATION**

**IL 72 - HIGGINS RD**  
**AT BEVERLY RD AND AT ROCK ROAD DR**

**SUGGESTED STAGES CONSTRUCTION & TRAFFIC CONTROL PLAN**  
**STAGE-I**

F.A.P. RTE.	SECTION	COUNTY	TOTAL SHEETS	SHEET NO.
341	2011-071-N	COOK/KANE	56	14
CONTRACT NO.			60P90	