

SIGNING FOR "MOT STAGE 2" SHALL REMAIN UNCHANGED FOR "MOT STAGE 2 AFTER COMPLETED WORK" UNLESS OTHERWISE INDICATED ON PLANS.

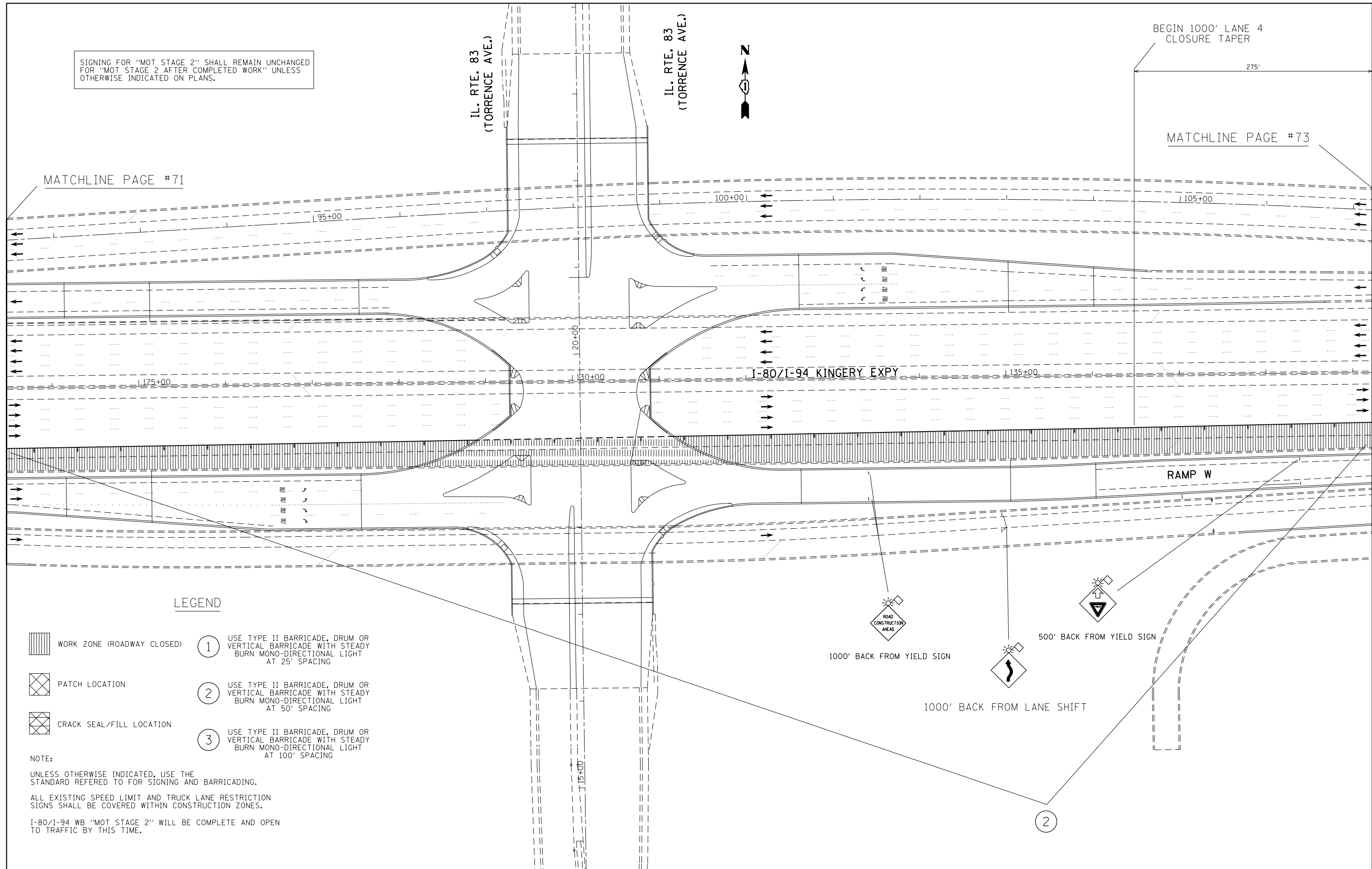



MATCHLINE PAGE #71

BEGIN 1000' LANE 4 CLOSURE TAPER

MATCHLINE PAGE #73

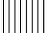
LEGEND

-  WORK ZONE (ROADWAY CLOSED)
-  PATCH LOCATION
-  CRACK SEAL/FILL LOCATION
- ① USE TYPE II BARRICADE, DRUM OR VERTICAL BARRICADE WITH STEADY BURN MONO-DIRECTIONAL LIGHT AT 25' SPACING
- ② USE TYPE II BARRICADE, DRUM OR VERTICAL BARRICADE WITH STEADY BURN MONO-DIRECTIONAL LIGHT AT 50' SPACING
- ③ USE TYPE II BARRICADE, DRUM OR VERTICAL BARRICADE WITH STEADY BURN MONO-DIRECTIONAL LIGHT AT 100' SPACING

NOTE:
UNLESS OTHERWISE INDICATED, USE THE STANDARD REFERRED TO FOR SIGNING AND BARRICADING.

ALL EXISTING SPEED LIMIT AND TRUCK LANE RESTRICTION SIGNS SHALL BE COVERED WITHIN CONSTRUCTION ZONES.

I-80/I-94 WB "MOT STAGE 2" WILL BE COMPLETE AND OPEN TO TRAFFIC BY THIS TIME.

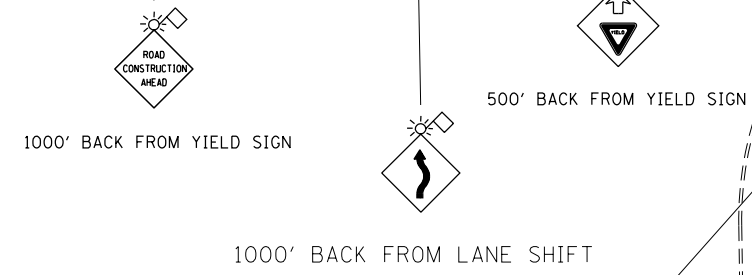

FILE NAME =	USER NAME = 11aydjm	DESIGNED -	REVISED -
es:\pwwork\pwwid\11aydjm\d0298297\013302-2-sh-t-plan.dgn		DRAWN -	REVISED -
	PLOT SCALE = 100.0000' / in.	CHECKED -	REVISED -
	PLOT DATE = 4/4/2012	DATE -	REVISED -

**STATE OF ILLINOIS
DEPARTMENT OF TRANSPORTATION**

**ROADWAY AND SUGGESTED MAINTENANCE OF TRAFFIC
STAGE 2 AFTER COMPLETED WORK**

SCALE: SHEET OF SHEETS STA. TO STA.

F.A.I. RTE. 80/94	SECTION 2012-002CRC-PP	COUNTY COOK	TOTAL SHEETS 91	SHEET NO. 72
CONTRACT NO. 60T34				
ILLINOIS FED. AID PROJECT				