

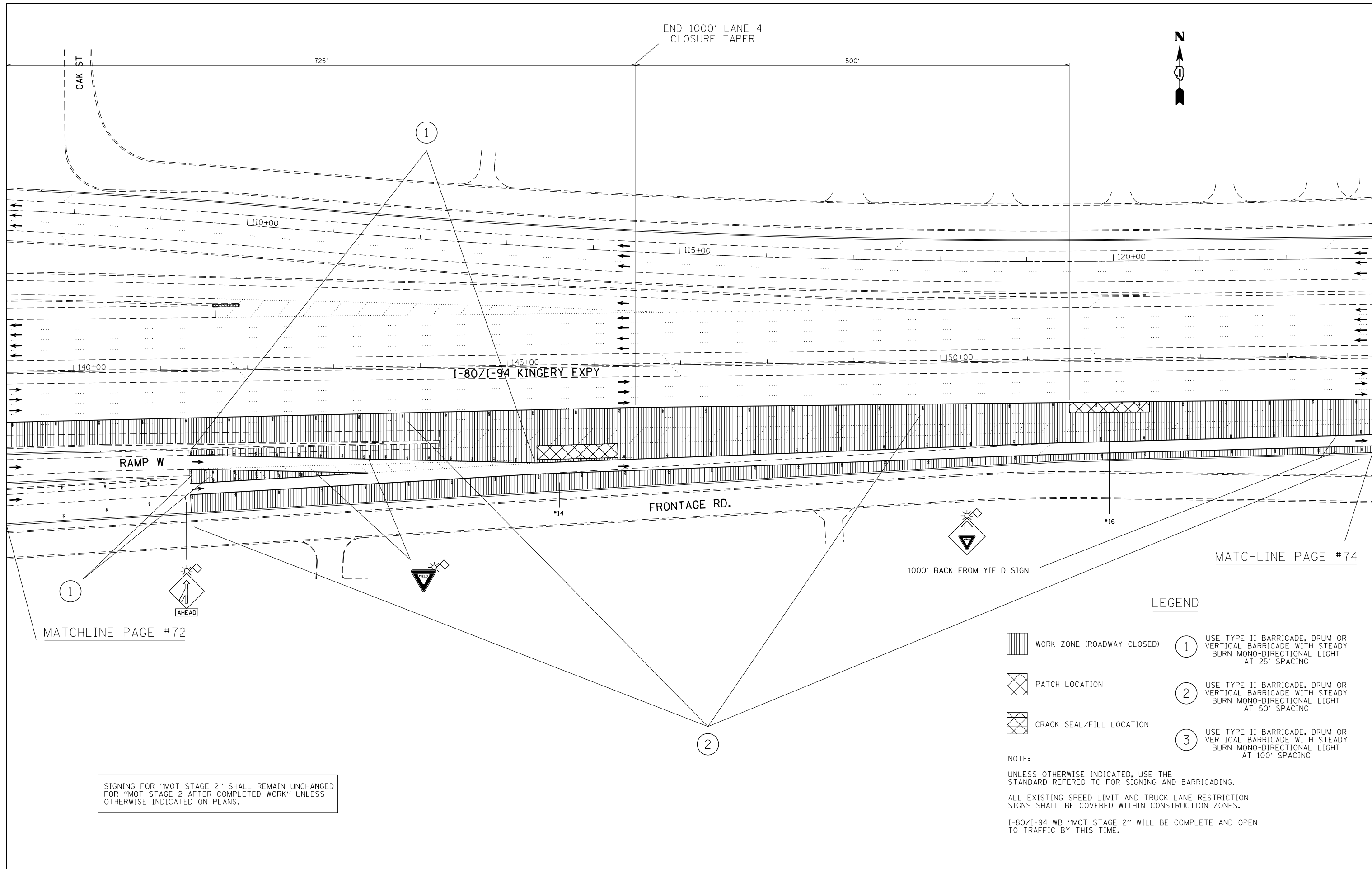

END 1000' LANE 4
CLOSURE TAPER



MATCHLINE PAGE #72

MATCHLINE PAGE #74

LEGEND

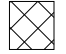
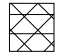
-  WORK ZONE (ROADWAY CLOSED)
-  PATCH LOCATION
-  CRACK SEAL/FILL LOCATION
- 1** USE TYPE II BARRICADE, DRUM OR VERTICAL BARRICADE WITH STEADY BURN MONO-DIRECTIONAL LIGHT AT 25' SPACING
- 2** USE TYPE II BARRICADE, DRUM OR VERTICAL BARRICADE WITH STEADY BURN MONO-DIRECTIONAL LIGHT AT 50' SPACING
- 3** USE TYPE II BARRICADE, DRUM OR VERTICAL BARRICADE WITH STEADY BURN MONO-DIRECTIONAL LIGHT AT 100' SPACING

NOTE:
UNLESS OTHERWISE INDICATED, USE THE STANDARD REFERED TO FOR SIGNING AND BARRICADING.
ALL EXISTING SPEED LIMIT AND TRUCK LANE RESTRICTION SIGNS SHALL BE COVERED WITHIN CONSTRUCTION ZONES.
I-80/I-94 WB "MOT STAGE 2" WILL BE COMPLETE AND OPEN TO TRAFFIC BY THIS TIME.

SIGNING FOR "MOT STAGE 2" SHALL REMAIN UNCHANGED FOR "MOT STAGE 2 AFTER COMPLETED WORK" UNLESS OTHERWISE INDICATED ON PLANS.

FILE NAME =	USER NAME = 11oydjm	DESIGNED -	REVISED -
et:\pw\work\p1dot\11oydjm\d0298297\0133022-sh1-plan.dgn		DRAWN -	REVISED -
	PLOT SCALE = 100.0000' / in.	CHECKED -	REVISED -
	PLOT DATE = 4/4/2012	DATE -	REVISED -

**STATE OF ILLINOIS
DEPARTMENT OF TRANSPORTATION**

**ROADWAY AND SUGGESTED MAINTENANCE OF TRAFFIC
STAGE 2 AFTER COMPLETED WORK**

SCALE:	SHEET	OF	SHEETS	STA.	TO	STA.
--------	-------	----	--------	------	----	------

F.A.I. RTE.	SECTION	COUNTY	TOTAL SHEETS	SHEET NO.
80/94	2012-002CRC-PP	COOK	91	73
CONTRACT NO. 60T34				
ILLINOIS FED. AID PROJECT				