

**AUXILIARY LANE MARKINGS**

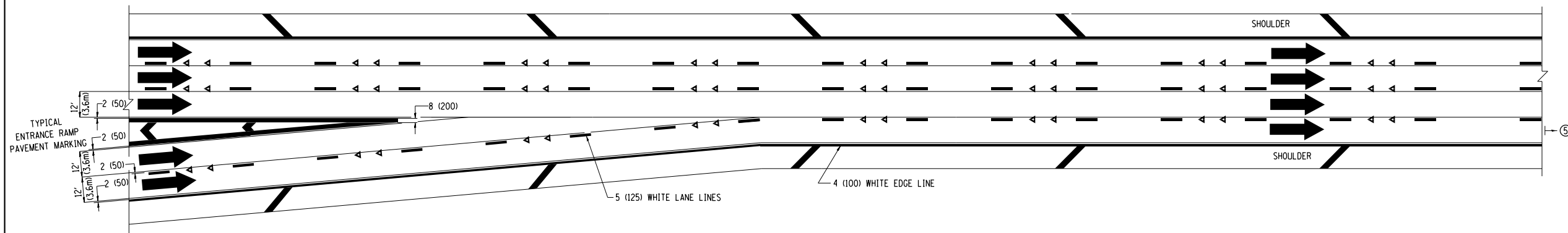

**TWO LANE ENTRANCE RAMP WITH MERGE MARKINGS**

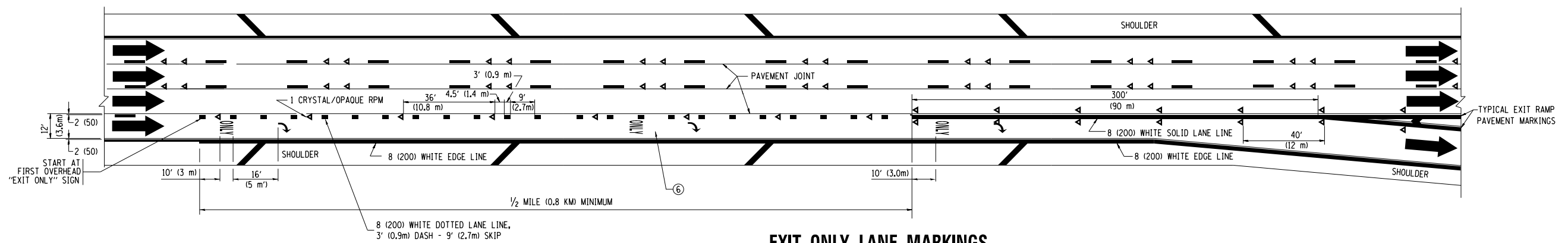

**EXIT ONLY LANE MARKINGS**

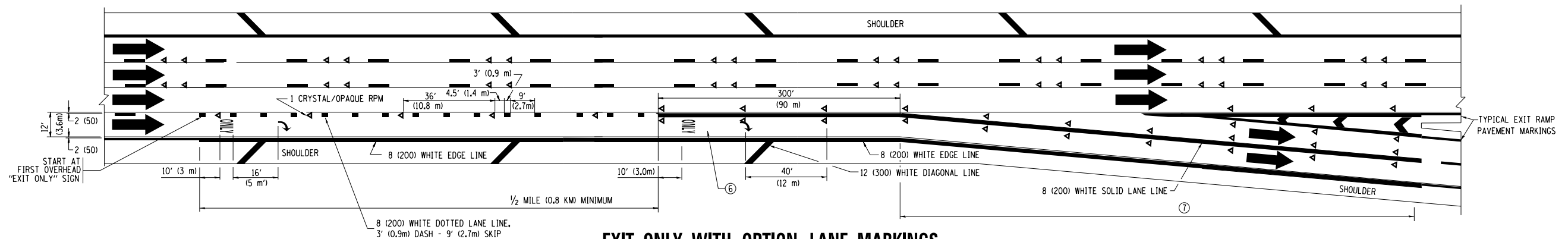

**EXIT ONLY WITH OPTION LANE MARKINGS**

- NOTES**
- ③ OMIT WHEN LENGTH OF AUXILIARY LANE IS LESS THAN 500' (150 m).
  - ④ 8-INCH WIDE DOTTED LANE LINE MARKINGS SHALL BE USED WHEN THE LENGTH OF THE AUXILIARY LANE IS 2 MILES OR LESS.
  - ⑤ FOR TWO-LANE ENTRANCE RAMP, IF RIGHT LANE ENDS, USE TYPICAL ENTRANCE RAMP PAVEMENT MARKINGS.
  - ⑥ ONLY AND ARROWS EQUALLY SPACED, 500' (150 m) MAXIMUM SPACING. FULL SIZE LETTERS AND ARROW SHALL BE USED.
  - ⑦ CONTINUE 8" SOLID LANE LINE THROUGH EXIT TO END OF PAVED GORE.

FILE NAME =	USER NAME = 11aydjm	DESIGNED - D.W.S.	REVISED - D.W.S. 07-96
et:\pwork\p1dot11aydjm\d0298297\DistStd.dgn		DRAWN -	REVISED - J.A.F. 02-06
	PLOT SCALE = 100.0000' / in.	CHECKED -	REVISED - S.P.B. 01-07
	PLOT DATE = 4/4/2012	DATE - 01-90	REVISED - S.P.B. 01-10

**STATE OF ILLINOIS  
DEPARTMENT OF TRANSPORTATION**

<b>MULTI-LANE FREEWAY PAVEMENT MARKING DETAILS</b>			
SCALE: NONE	SHEET NO. 2 OF 2 SHEETS	STA.	TO STA.

F.A.I. RTE. 80/94	SECTION 2012-002CRC-PP	COUNTY COOK	TOTAL SHEETS 91	SHEET NO. 87
<b>TC-12</b>		<b>CONTRACT NO. 60T34</b>		
FED. ROAD DIST. NO. 1 ILLINOIS FED. AID PROJECT				