

REMOVAL LEGEND

- ⊗ TREE REMOVAL (6 TO 15 UNITS DIAMETER)
- / — REMOVAL ITEM
- ✕ REMOVING CATCH BASINS
- ✕ REMOVE SIGN PANEL ASSEMBLY
- ⊗ TREE PRUNING (1 TO 10 INCH DIAMETER)
- ✕ REMOVAL OF PRECAST FLARED END SECTION
- ▨ HOT-MIX ASPHALT SURFACE REMOVAL, 1 1/2" THICK
- ▩ PORTLAND CEMENT CONCRETE SURFACE REMOVAL - BUTT JOINT

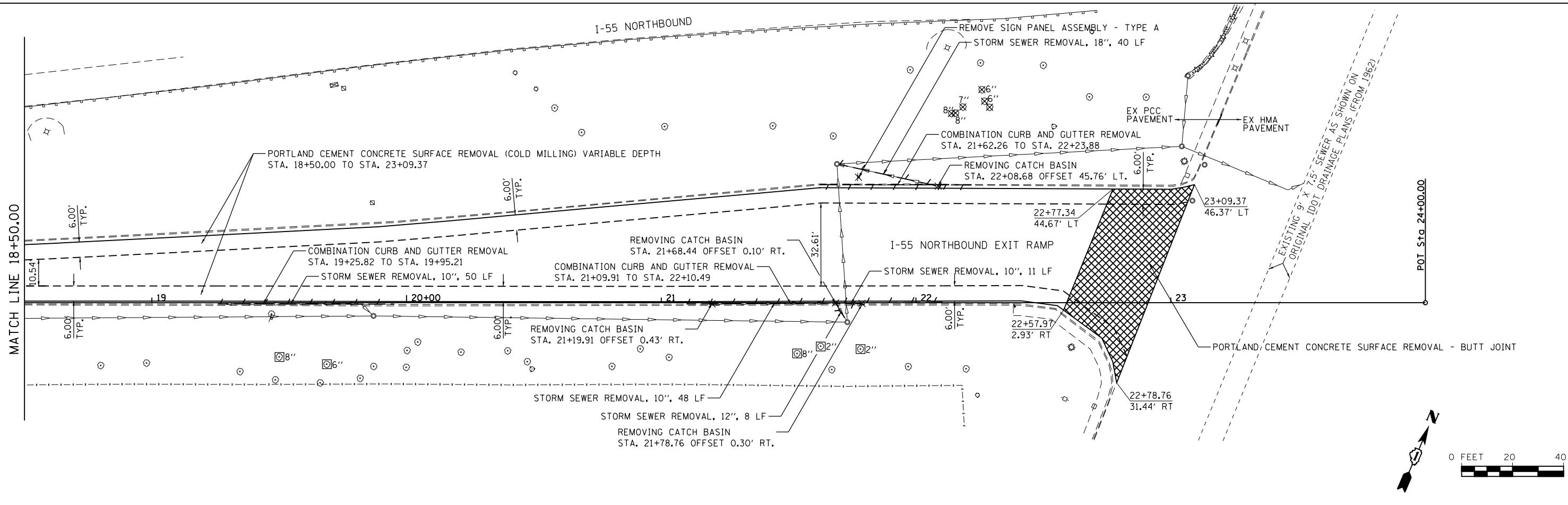
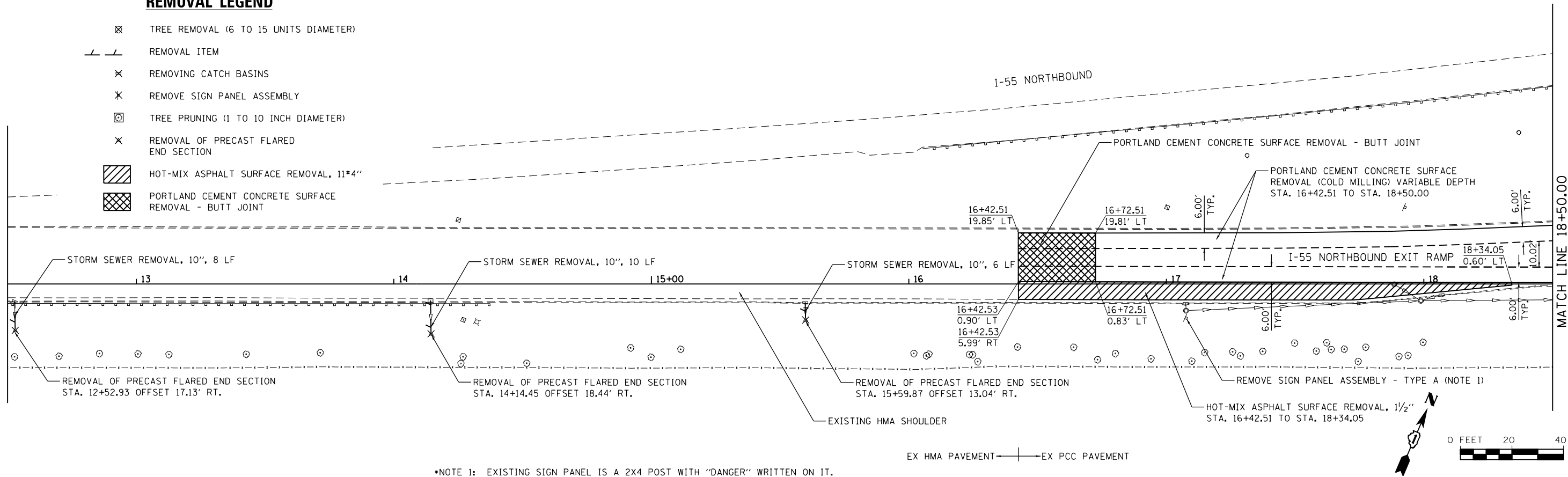

FILE NAME = SA\JUL16300-6399\6346-035\Micros\CADD Sheets\01680391-sht-rem1.dgn

SA STRAND ASSOCIATES
 1170 SOUTH HOUBOLT ROAD
 JOLIET, ILLINOIS 60431
 (815) 744-4200

USER NAME = dennisw	DESIGNED - TJS	REVISED -
PLOT SCALE = 48.0000' / in.	DRAWN - DJW	REVISED -
PLOT DATE = 4/2/2012	CHECKED - MAG	REVISED -
	DATE - 4-2-12	REVISED -

**STATE OF ILLINOIS
 DEPARTMENT OF TRANSPORTATION**

**I-55 NORTHBOUND EXIT RAMP
 REMOVAL PLANS**

SCALE: 1" = 20' SHEET 1 OF 1 SHEETS STA. 13+00.00 TO STA. 24+00.00

F.A.I. RTE. 55	SECTION 112-636T	COUNTY COOK	TOTAL SHEETS 36	SHEET NO. 13
CONTRACT NO. 60T37				
FED. ROAD DIST. NO. 1 ILLINOIS FED. AID PROJECT				