

INDEX OF SHEETS

FOR INDEX OF SHEETS, SEE SHEET NO. 2

PROJECT LOCATED IN VILLAGE OF UNIVERSITY PARK

TRAFFIC DATA:	ADT (2030)	DESIGN SPEED	POSTED SPEED
STUENKEL ROAD*	20,000	45 MPH	40 MPH
FAI 57 I-57	97,000	65 MPH	55 MPH

* STUENKEL ROAD CURRENTLY CLOSED TO THRU TRAFFIC

PROJECT DESCRIPTION

THE PROPOSED STUENKEL ROAD IMPROVEMENT INCLUDES REMOVAL OF EXISTING BRIDGE (S.N. 099-0200) AND REPLACEMENT WITH A NEW BRIDGE (S.N. 099-0526) OVER I-57.

DESIGN DESIGNATION

1130(30) MINOR ARTERIAL

STATE OF ILLINOIS
DEPARTMENT OF TRANSPORTATION
DIVISION OF HIGHWAYS

PROPOSED HIGHWAY PLANS

F.A.I. ROUTE 57 (INTERSTATE-57)
AT STUENKEL ROAD

BRIDGE RECONSTRUCTION
WILL COUNTY

D-91-001-11

SECTION 99-1HB-R

PROJECT

C-91-348-12

PROJECT:
IM-057-7(294)337

F.A.I. RTE.	SECTION	COUNTY	TOTAL SHEETS	SHEET NO.
57	99-1HB-R	WILL	63	1

FED. ROAD DIST. NO. ILLINOIS CONTRACT NO. 60T40
D-91-001-11 *63 + 1 = 64



LOCATION OF SECTION INDICATED THIS: - [Black Box] -

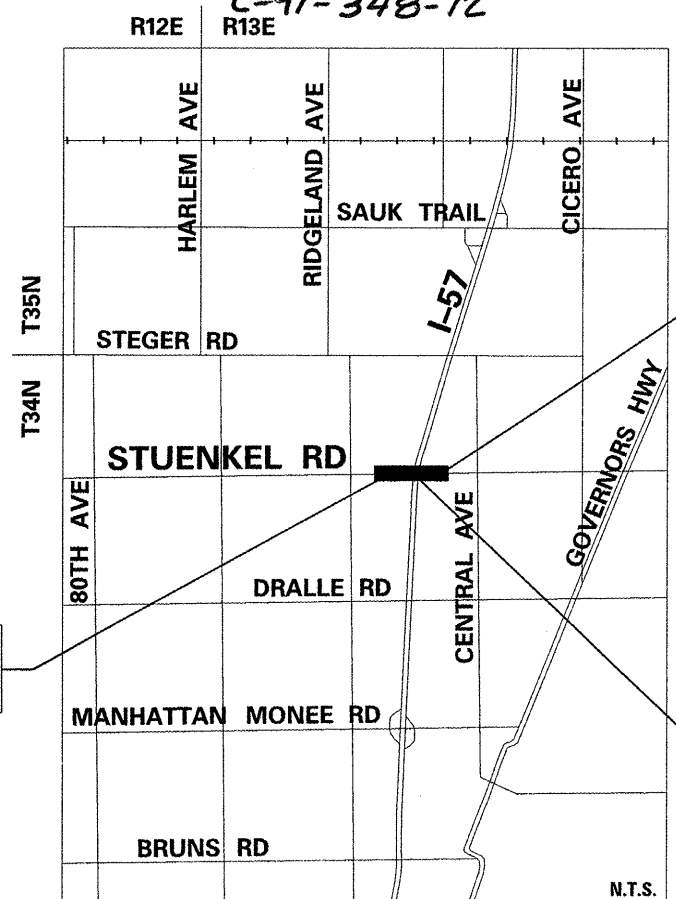

STUENKEL ROAD PROJECT LIMIT STA. 16033+00

John P. Marzouk
John P. Marzouk, P.E. 11- L.I.C. No. 62,054958
Expires 11-30-2013 For drawings thru
Date 3/28/2012

d Po
Spiros Pantazis, S.E. 11- L.I.C. No. 081-006448
Expires 11-30-2012 For drawings thru
Date 3/28/2012

S.N. 099-0526

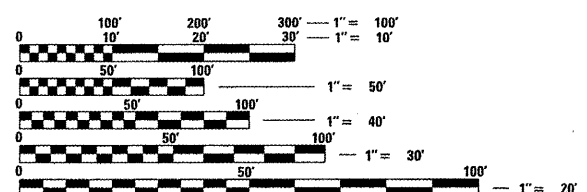

FULL SIZE PLANS HAVE BEEN PREPARED USING STANDARD ENGINEERING SCALES. REDUCED SIZED PLANS WILL NOT CONFORM TO STANDARD SCALES. IN MAKING MEASUREMENTS ON REDUCED PLANS, THE ABOVE SCALES MAY BE USED.

J.U.L.I.E.
JOINT UTILITY LOCATION INFORMATION FOR EXCAVATION
1-800-892-0123

PROJECT MANAGER: HELEN PAZON (847) 705-4523

CONTRACT NO. 60T40

LOCATION MAP
GROSS LENGTH OF PROJECT = 450.00 FT. = 0.08 MI.
NET LENGTH OF PROJECT = 450.00 FT. = 0.08 MI.

TYLIN INTERNATIONAL
200 SOUTH WACKER DRIVE, SUITE 1400
CHICAGO, ILLINOIS 60606
TEL: 312-777-2900 FAX: 312-705-0305

STATE OF ILLINOIS
DEPARTMENT OF TRANSPORTATION
DIVISION OF HIGHWAYS

SUBMITTED APRIL 3 20 12

Diane O'Keefe / ASO
DEPUTY DIRECTOR OF HIGHWAYS, REGION ENGINEER

May 11 20 12
John D. Baranzelli, P.E.
ENGINEER OF DESIGN AND ENVIRONMENT

May 11 20 12
William R. Frey
DIRECTOR OF HIGHWAYS, CHIEF ENGINEER

PRINTED BY THE AUTHORITY OF THE STATE OF ILLINOIS