

STUENKEL RD DATA	I-57 DATA	RIDGELAND AVE DATA
P.O.T. STA. = 924+16.51 N = 1,744,712.5234 E = 1,131,814.9301 P.O.T. STA. = 945+77.49 N = 1,744,756.0716 E = 1,133,975.4738 P.O.T. STA. = 989+99.62 (BK) = Sta 20+00.00 (AH) N = 1,744,832.1982 E = 1,138,396.9498 P.O.T. STA. = 30+00.64 N = 1,744,852.1819 E = 1,139,397.3874 P.O.T. STA. = 48+04.14 (BK) = Sta 16021+50.00 (AH) N = 1,744,886.2104 E = 1,141,200.5730 P.O.T. STA. = 16039+00.00 (BK) = Sta 65+53.78 (AH) N = 1,744,919.2294 E = 1,142,950.2615 P.O.T. STA. = 82+86.09 N = 1,744,951.9146 E = 1,144,682.2614 P.O.T. STA. = 125+75.35 N = 1,745,029.4382 E = 1,148,970.8158	PROP. CURVE EXCL57-1 EXIST. CURVE MA111-1 PI STA. = 1458+10.02 N = 1,745,198.5034 E = 1,142,062.1467 $\Delta = 14^\circ 07' 38''$ (RT) $D = 0^\circ 29' 59''$ $R = 11,467.92'$ $T = 1,421.02'$ $L = 2,827.62'$ $E = 87.71'$ $e = \text{-----}$ $T.R. = \text{-----}$ $S.E. RUN = \text{-----}$ P.C. STA. = 1443+89.00 N = 1,743,778.5775 E = 1,142,006.4196 P.T. STA. = 1472+16.63 N = 1,746,561.8830 E = 1,142,462.7602	P.O.T. STA. = 680+02.45 N = 1,742,854.9219 E = 1,139,431.4980 P.O.T. STA. = 700+00.00 N = 1,744,852.1819 E = 1,139,397.3874 P.O.T. STA. = 720+16.29 N = 1,746,868.1542 E = 1,139,361.8510

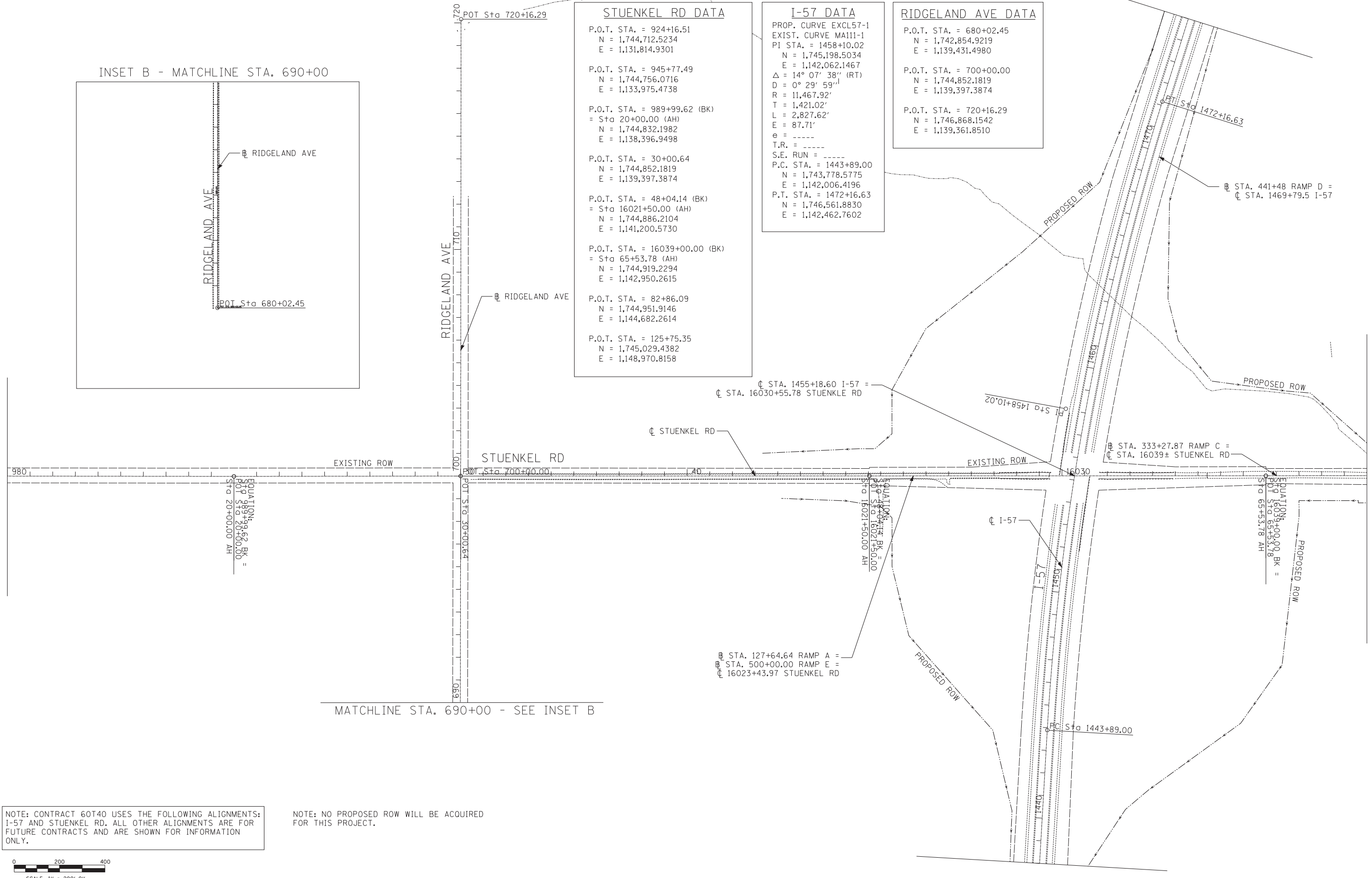

NOTE: CONTRACT 60T40 USES THE FOLLOWING ALIGNMENTS: I-57 AND STUENKEL RD. ALL OTHER ALIGNMENTS ARE FOR FUTURE CONTRACTS AND ARE SHOWN FOR INFORMATION ONLY.

NOTE: NO PROPOSED ROW WILL BE ACQUIRED FOR THIS PROJECT.

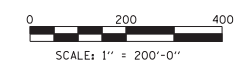

TYLIN INTERNATIONAL USER NAME = *USER* PLOT SCALE = *SCALE* PLOT DATE = 3/29/2012	DESIGNED - BES DRAWN - BES	REVISED - REVISED -	STATE OF ILLINOIS DEPARTMENT OF TRANSPORTATION	STUENKEL ROAD BRIDGE OVER I-57 ALIGNMENT PLAN			F.A. RTE. = 57 SECTION = 99-1HB-R COUNTY = WILL TOTAL SHEETS = 63 SHEET NO. = 9
	CHECKED - JPM DATE = 3/30/2012	REVISED - REVISED -		SCALE: 1"=200' SHEET NO. 1 OF 1 SHEETS STA. TO STA.	CONTRACT NO. 60T40 ILLINOIS FED. AID PROJECT		
	p:\602612(1-57_@_stuenkel)\road\c_1(bridge)\c_1.AL_SHT02.dgn						