

DATE	
BY	
FINAL SURVEY	
PLOTTED	
NOTE BOOK	
AREAS CHECKED	

DATE	
BY	
ORIGINAL SURVEY	
PLOTTED	
NOTE BOOK	
AREAS CHECKED	

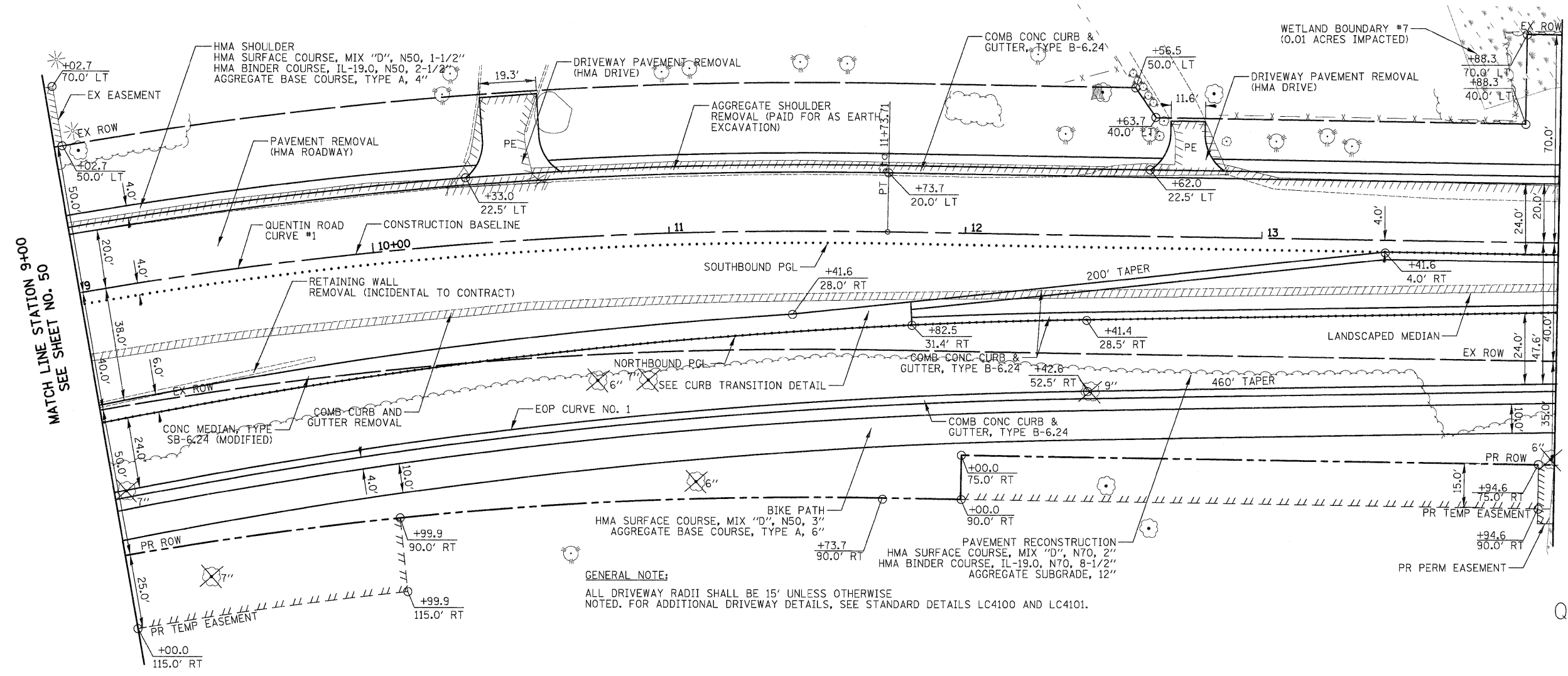

MATCH LINE STATION 14+00  
SEE SHEET NO. 52

QUENTIN ROAD  
CURVE #1  
PI STA = 7+40.52  
 $\Delta = 35^\circ 52' 00''$  (RT)  
D = 3° 59' 57"  
R = 1,432.70'  
T = 463.67'  
L = 896.86'  
E = 73.16'  
PC STA = 2+76.85  
PT STA = 11+73.71

EOP CURVE NO. 1  
 $\Delta = 13^\circ 59' 53''$   
D = 3° 10' 53"  
R = 1,801.00'  
T = 221.10'  
L = 440.01'  
E = 13.52'

GENERAL NOTE:  
ALL DRIVEWAY RADII SHALL BE 15' UNLESS OTHERWISE NOTED. FOR ADDITIONAL DRIVEWAY DETAILS, SEE STANDARD DETAILS LC4100 AND LC4101.

QUENTIN ROAD

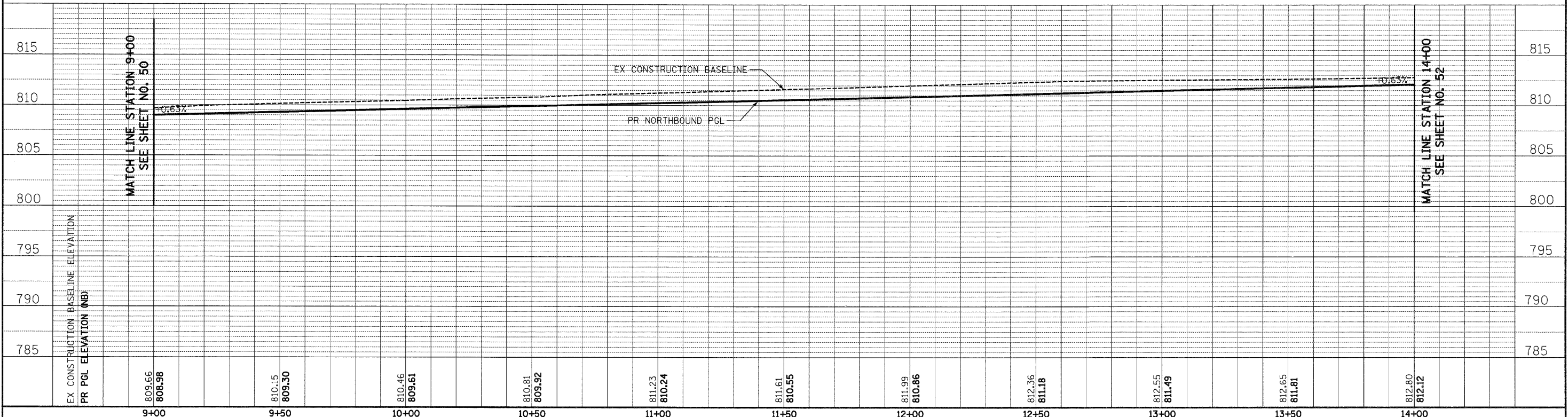

<p>450 E Devon Ave, Suite 300 Itasca, Illinois 60143 Tel: 630.773.3900 Fax: 630.773.3975 www.civiltechinc.com</p>	DESIGNED - JRR DRAWN - JRR CHECKED - RTM DATE - 10/24/2011	REVISED - REVISED - REVISED - REVISED -	<b>STATE OF ILLINOIS DEPARTMENT OF TRANSPORTATION</b>	VERT. 0 5 10 HORIZ. 0 20 40 	<b>PLAN AND PROFILE</b>	F.A.U. 364 SECTION 02-00051-08-WR COUNTY LAKE TOTAL SHEETS 188 SHEET NO. 51	<b>CONTRACT NO. 63649</b>
	SHEET NO. 9 OF 13 SHEETS STA. 9+00 TO STA. 14+00					FED. ROAD DIST. NO. 1 ILLINOIS FED. AID PROJECT	