

DATE	
BY	
ORIGINAL SURVEY	
PLOTTED	
NOTE BOOK	
TEMPLATE	
AREAS CHECKED	
NO.	

DATE	
BY	
ORIGINAL SURVEY	
PLOTTED	
NOTE BOOK	
TEMPLATE	
AREAS CHECKED	
NO.	

- 84 STA 5+25, 29.6' RT
CB 4 DIA T11VF&G
RIM = 806.81
INV = 802.34 (S)
- 85 STA 5+15, 29.5' RT
CB TA 4 DIA T11VF&G
RIM = 806.75
INV = 800.31 (E)
INV = 802.31 (N)
- 86 STA 5+15, 79.4' RT
MAN TA 5 DIA T1F CL
RIM = 806.50
INV = 798.08 (S)
INV = 798.18 (N)
INV = 800.08 (W)
- 87 STA 6+00, 29.7' RT
CB TA 4 DIA T11VF&G
RIM = 807.28
INV = 799.50 (E)
- 88 STA 6+00, 79.3' RT
MAN TA 5 DIA T1F CL
RIM = 806.95
INV = 798.40 (S)
INV = 798.90 (NE)
INV = 799.27 (W)
- 89 STA 6+50, 91.9' RT
MAN TA 5 DIA T1F CL
RIM = 806.94
INV = 799.04 (SW)
INV = 799.54 (N)
INV = 799.29 (E)
- 90 STA 6+78, 128.1' RT
CB TA 4 DIA T24F&G
RIM = 803.35
INV = 799.50 (W)
INV = 799.60 (N)
- 91 STA 7+38, 107.0' RT
CB TC T24F&G
RIM = 805.80
INV = 799.88 (S)
- 92 STA 8+20, 41.4' RT
CB TA 4 DIA T11VF&G
RIM = 808.57
INV = 804.18 (E)
- 93 STA 8+20, 71.6' RT
CB TA 4 DIA T24F&G
RIM = 807.65
INV = 802.04 (W)
INV = 804.04 (E)
- 94 STA 8+20, 82.7' RT
MAN TA 5 DIA T1F CL
RIM = 808.30
INV = 801.91 (NE)
INV = 802.00 (NW)
INV = 800.00 (SW)

- 84A STA 5+10, 40.0' LT
PRC FLAR END SEC 36
W/ GRATING
INV = 801.96
- 95 STA 8+97, 56.1' LT
PRC FLAR END SEC 24
W/ GRATING
INV = 800.00
- 96 STA 8+62, 111.4' RT
PRC FLAR END SEC 24
W/ GRATING
INV = 798.56
- 97 STA 8+90, 40.2' RT
CB TA 4 DIA T11VF&G
RIM = 808.92
INV = 804.45 (E)
INV = 805.45 (N)

- 98 STA 8+90, 70.5' RT
CB TA 4 DIA T24F&G
RIM = 808.08
INV = 804.32 (W)
INV = 803.30 (E)
- 99 STA 8+90, 79.8' RT
MAN TA 5 DIA T1F CL
RIM = 808.72
INV = 802.10 (SW)
INV = 803.10 (NE)
INV = 803.28 (NW)
- 100 STA 9+00, 39.2' RT
INLETS TA T11VF&G
RIM = 808.98
INV = 805.48 (SW)

MATCH LINE STATION 5+00
SEE SHEET NO. 78

MATCH LINE STATION 9+00
SEE SHEET NO. 80

MATCH LINE STATION 5+00
SEE SHEET NO. 78

MATCH LINE STATION 9+00
SEE SHEET NO. 80

806.78
806.48

807.18
806.79

807.54
807.10

807.93
807.42

808.27
807.73

808.63
808.04

809.00
808.36

809.25
808.67

809.66
808.98

5+00

5+50

6+00

6+50

7+00

7+50

8+00

8+50

9+00

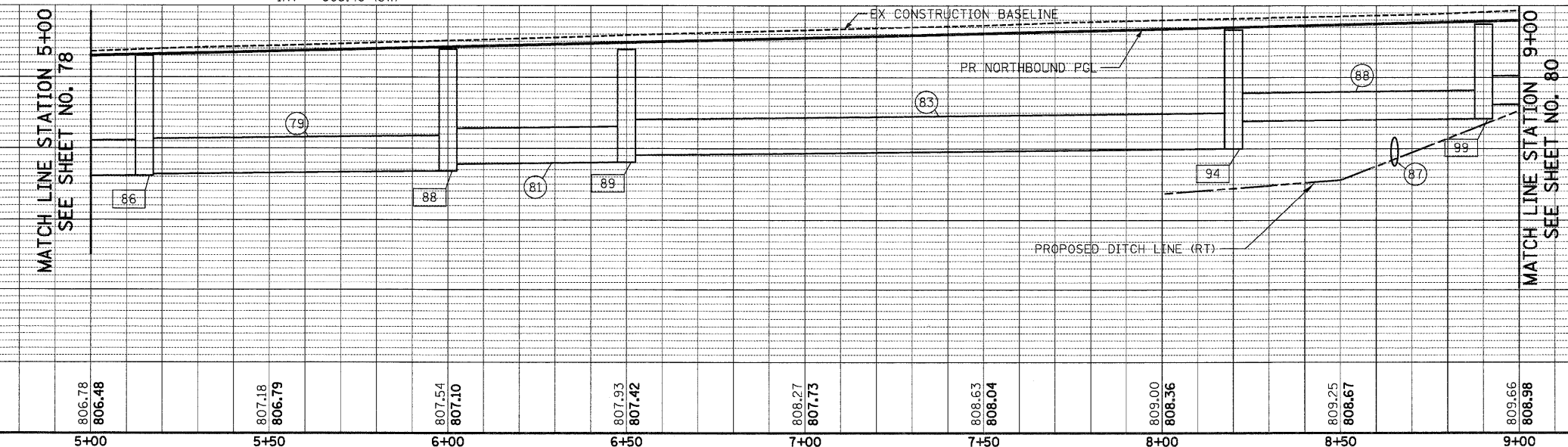

NOTE:
1.) EX WHITE PINE "QUENTIN COLLECTION" SIGN
CONFLICTS WITH ROADWAY IMPROVEMENTS.
SIGN & UTILITIES ARE TO BE RELOCATED BY OTHERS.

- 77 7' - STORM SEW CL A 1, 12" @ 1.30%
TBF = 2 CU YD
- 78 45' - STORM SEW CL A 1, 12" @ 0.50%
TBF = 28 CU YD
- 79 76' - STORM SEW CL A 1, 30" @ 0.30%
- 80 47' - STORM SEW CL A 1, 12" @ 0.50%
TBF = 37 CU YD
- 81 44' - STORM SEW CL A 1, 30" @ 0.30%
- 82 42' - STORM SEW CL A 1, 12" @ 0.50%
TBF = 2 CU YD
- 83 155' - STORM SEW CL A 1, 30" @ 0.30%
TBF = 145 CU YD
- 84 56' - STORM SEW CL A 1, 12" @ 0.50%
TBF = 14 CU YD
- 85 28' - STORM SEW CL A 1, 12" @ 0.50%
TBF = 7 CU YD
- 86 7' - STORM SEW CL A 1, 12" @ 0.50%
TBF = 1 CU YD
- 87 160' - STORM SEW CL A 1, 24" @ 0.90%
TBF = 133 CU YD
- 88 62' - STORM SEW CL A 1, 24" @ 0.30%
TBF = 55 CU YD
- 89 26' - STORM SEW CL A 1, 12" @ 0.50%
TBF = 4 CU YD
- 90 7' - STORM SEW CL A 1, 12" @ 0.50%
TBF = 1 CU YD
- 91 5' - STORM SEW CL A 1, 12" @ 0.50%
TBF = 1 CU YD