

BY: _____ DATE: _____
 SURVEYED _____
 PLOTTED _____
 NOTE BOOK _____
 AREAS CHECKED _____

BY: _____ DATE: _____
 ORIGINAL SURVEY _____
 PLOTTED _____
 NOTE BOOK _____
 AREAS CHECKED _____

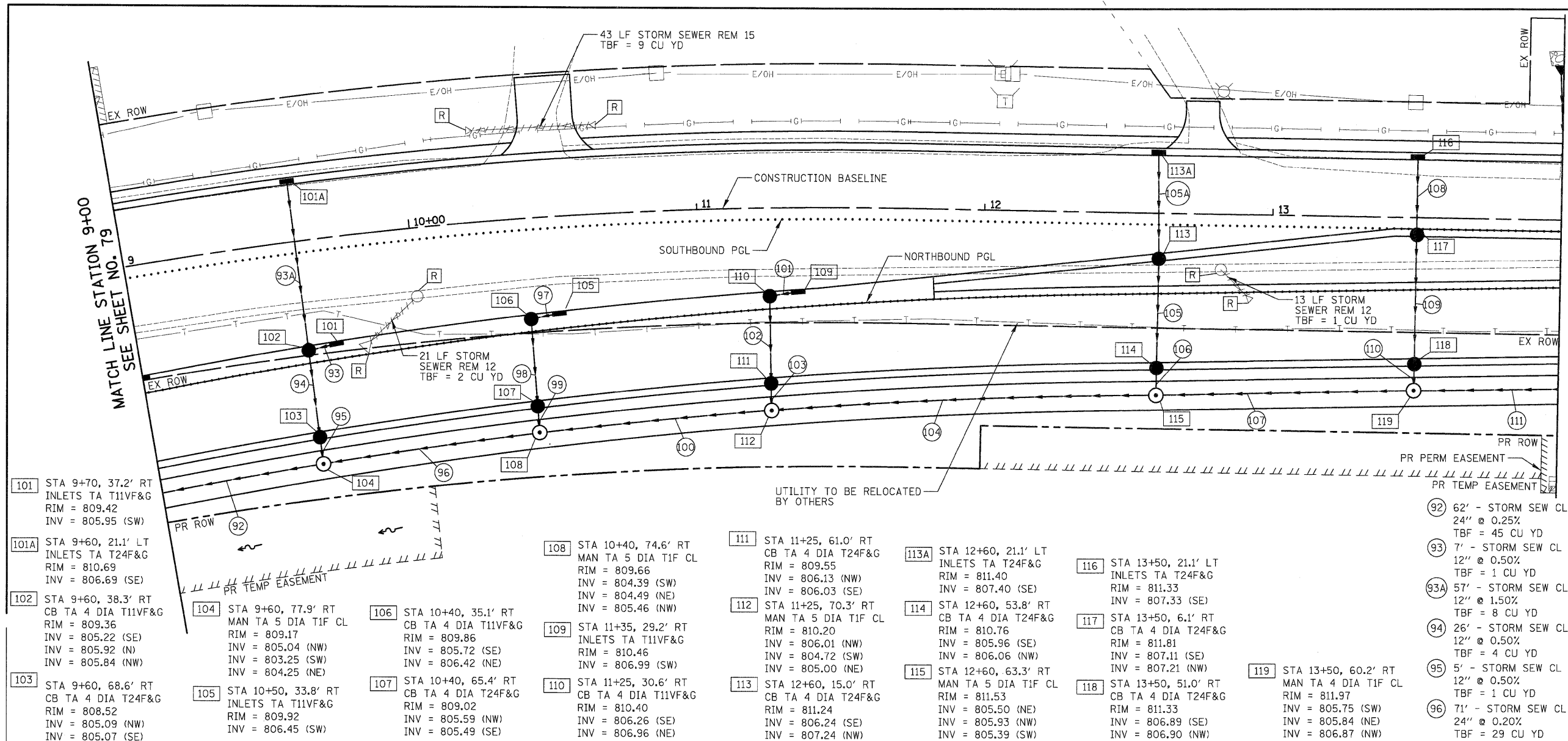

- 97 7' - STORM SEW CL A 1, 12" @ 0.50% TBF = 1 CU YD
- 98 26' - STORM SEW CL A 1, 12" @ 0.50% TBF = 4 CU YD
- 99 5' - STORM SEW CL A 1, 12" @ 0.50% TBF = 1 CU YD
- 100 76' - STORM SEW CL A 1, 24" @ 0.30% TBF = 49 CU YD
- 101 7' - STORM SEW CL A 1, 12" @ 0.50% TBF = 1 CU YD
- 102 26' - STORM SEW CL A 1, 12" @ 0.50% TBF = 4 CU YD
- 103 5' - STORM SEW CL A 1, 12" @ 0.50% TBF = 1 CU YD
- 104 129' - STORM SEW CL A 1, 18" @ 0.30% TBF = 91 CU YD
- 105 36' - STORM SEW CL A 1, 12" @ 0.50% TBF = 9 CU YD
- 105A 33' - STORM SEW CL A 1, 12" @ 0.50% TBF = 5 CU YD
- 106 5' - STORM SEW CL A 1, 12" @ 0.40% TBF = 1 CU YD
- 107 85' - STORM SEW CL A 1, 18" @ 0.30% TBF = 66 CU YD
- 108 25' - STORM SEW CL A 1, 12" @ 0.50% TBF = 5 CU YD
- 109 41' - STORM SEW CL A 1, 12" @ 0.50% TBF = 9 CU YD
- 110 6' - STORM SEW CL A 1, 15" @ 0.40% TBF = 1 CU YD
- 111 347' - STORM SEW CL A 1, 12" @ 0.50% TBF = 220 CU YD
- 92 62' - STORM SEW CL A 1, 24" @ 0.25% TBF = 45 CU YD
- 93 7' - STORM SEW CL A 1, 12" @ 0.50% TBF = 1 CU YD
- 93A 57' - STORM SEW CL A 1, 12" @ 1.50% TBF = 8 CU YD
- 94 26' - STORM SEW CL A 1, 12" @ 0.50% TBF = 4 CU YD
- 95 5' - STORM SEW CL A 1, 12" @ 0.50% TBF = 1 CU YD
- 96 71' - STORM SEW CL A 1, 24" @ 0.20% TBF = 29 CU YD
- 111A STA 12+60, 21.1' LT INLETS TA T24F&G RIM = 811.40 INV = 807.40 (SE)
- 113A STA 12+60, 53.8' RT CB TA 4 DIA T24F&G RIM = 810.76 INV = 805.96 (SE) INV = 806.06 (NW)
- 114 STA 12+60, 63.3' RT MAN TA 5 DIA T1F CL RIM = 811.53 INV = 805.50 (NE) INV = 805.93 (NW) INV = 805.39 (SW)
- 115 STA 13+50, 51.0' RT CB TA 4 DIA T24F&G RIM = 811.33 INV = 806.89 (SE) INV = 806.90 (NW)
- 116 STA 13+50, 21.1' LT INLETS TA T24F&G RIM = 811.33 INV = 807.33 (SE)
- 117 STA 13+50, 6.1' RT CB TA 4 DIA T24F&G RIM = 811.81 INV = 807.11 (SE) INV = 807.21 (NW)
- 118 STA 13+50, 51.0' RT CB TA 4 DIA T24F&G RIM = 811.33 INV = 806.89 (SE) INV = 806.87 (NW)
- 119 STA 13+50, 60.2' RT MAN TA 4 DIA T1F CL RIM = 811.97 INV = 805.75 (SW) INV = 805.84 (NE) INV = 806.87 (NW)

- 101 STA 9+70, 37.2' RT INLETS TA T11VF&G RIM = 809.42 INV = 805.95 (SW)
- 101A STA 9+60, 21.1' LT INLETS TA T24F&G RIM = 810.69 INV = 806.69 (SE)
- 102 STA 9+60, 38.3' RT CB TA 4 DIA T11VF&G RIM = 809.36 INV = 805.22 (SE) INV = 805.92 (N) INV = 805.84 (NW)
- 103 STA 9+60, 68.6' RT CB TA 4 DIA T24F&G RIM = 808.52 INV = 805.09 (NW) INV = 805.07 (SE)
- 104 STA 9+60, 77.9' RT MAN TA 5 DIA T1F CL RIM = 809.17 INV = 805.04 (NW) INV = 803.25 (SW) INV = 804.25 (NE)
- 105 STA 10+50, 33.8' RT INLETS TA T11VF&G RIM = 809.92 INV = 805.59 (NW) INV = 806.45 (SW)
- 106 STA 10+40, 35.1' RT CB TA 4 DIA T11VF&G RIM = 809.86 INV = 805.72 (SE) INV = 806.42 (NE)
- 107 STA 10+40, 65.4' RT CB TA 4 DIA T24F&G RIM = 809.02 INV = 805.59 (NW) INV = 805.49 (SE)
- 108 STA 10+40, 74.6' RT MAN TA 5 DIA T1F CL RIM = 809.66 INV = 804.39 (SW) INV = 804.49 (NE) INV = 805.46 (NW)
- 109 STA 11+35, 29.2' RT INLETS TA T11VF&G RIM = 810.46 INV = 806.99 (SW)
- 110 STA 11+25, 30.6' RT CB TA 4 DIA T11VF&G RIM = 810.40 INV = 806.26 (SE) INV = 806.96 (NE)
- 111 STA 11+25, 61.0' RT CB TA 4 DIA T24F&G RIM = 809.55 INV = 806.13 (NW) INV = 806.03 (SE)
- 112 STA 11+25, 70.3' RT MAN TA 5 DIA T1F CL RIM = 810.20 INV = 806.01 (NW) INV = 804.72 (SW) INV = 805.00 (NE)
- 113 STA 12+60, 15.0' RT CB TA 4 DIA T24F&G RIM = 811.24 INV = 806.24 (SE) INV = 807.24 (NW)
- 113A STA 12+60, 21.1' LT INLETS TA T24F&G RIM = 811.40 INV = 807.40 (SE)
- 114 STA 12+60, 53.8' RT CB TA 4 DIA T24F&G RIM = 810.76 INV = 805.96 (SE) INV = 806.06 (NW)
- 115 STA 12+60, 63.3' RT MAN TA 5 DIA T1F CL RIM = 811.53 INV = 805.50 (NE) INV = 805.93 (NW) INV = 805.39 (SW)
- 116 STA 13+50, 21.1' LT INLETS TA T24F&G RIM = 811.33 INV = 807.33 (SE)
- 117 STA 13+50, 6.1' RT CB TA 4 DIA T24F&G RIM = 811.81 INV = 807.11 (SE) INV = 807.21 (NW)
- 118 STA 13+50, 51.0' RT CB TA 4 DIA T24F&G RIM = 811.33 INV = 806.89 (SE) INV = 806.90 (NW)
- 119 STA 13+50, 60.2' RT MAN TA 4 DIA T1F CL RIM = 811.97 INV = 805.75 (SW) INV = 805.84 (NE) INV = 806.87 (NW)

