

DATE \_\_\_\_\_  
 BY \_\_\_\_\_  
 SURVEYED \_\_\_\_\_  
 NO. 1/L BOOK \_\_\_\_\_  
 NO. \_\_\_\_\_  
 SURVEY \_\_\_\_\_  
 NO. 1/L BOOK \_\_\_\_\_  
 NO. \_\_\_\_\_  
 TEMPLATE \_\_\_\_\_  
 AREAS CHECKED \_\_\_\_\_

DATE \_\_\_\_\_  
 BY \_\_\_\_\_  
 SURVEYED \_\_\_\_\_  
 NO. 1/L BOOK \_\_\_\_\_  
 NO. \_\_\_\_\_  
 SURVEY \_\_\_\_\_  
 NO. 1/L BOOK \_\_\_\_\_  
 NO. \_\_\_\_\_  
 TEMPLATE \_\_\_\_\_  
 AREAS CHECKED \_\_\_\_\_

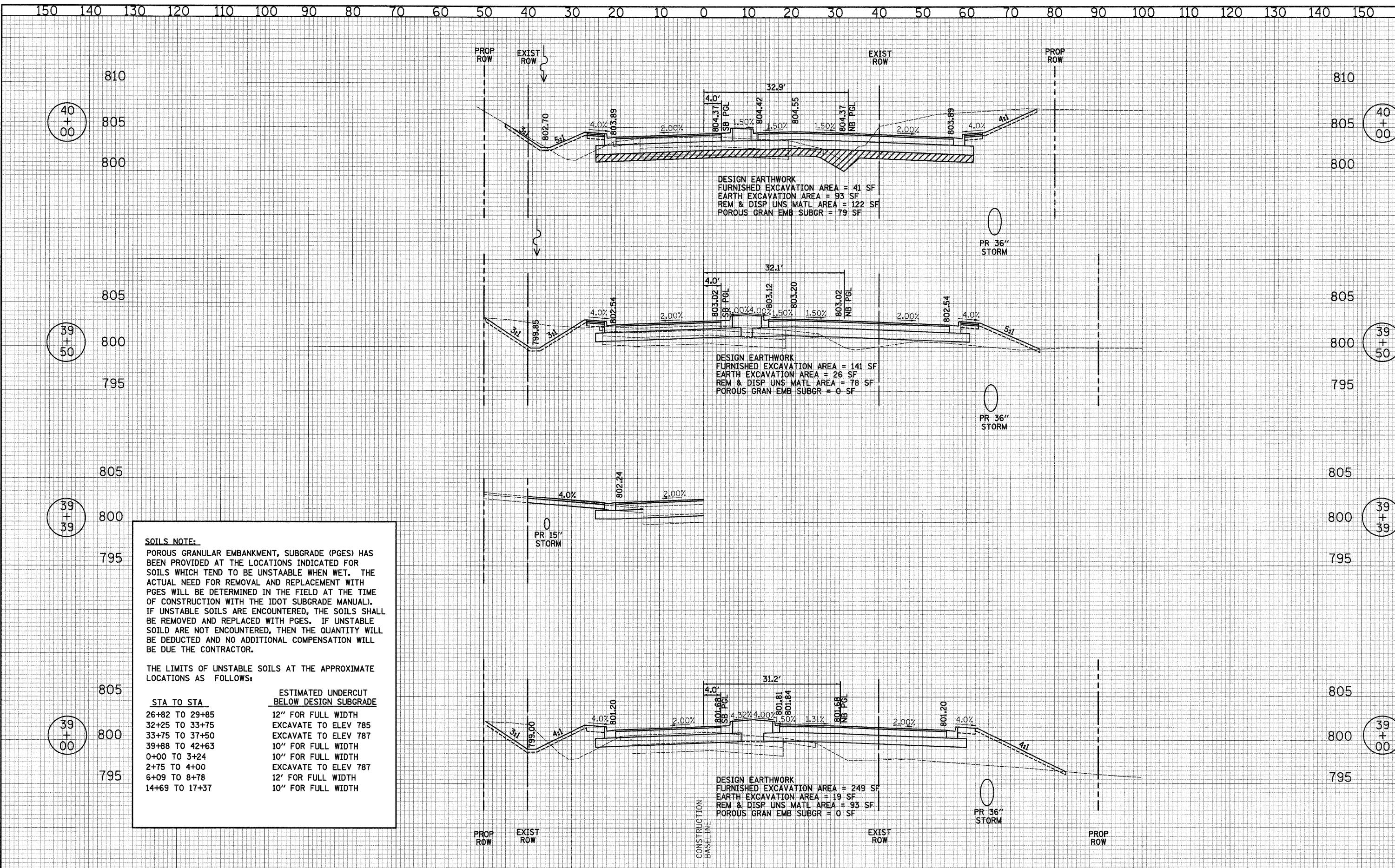

**SOILS NOTE:**  
 POROUS GRANULAR EMBANKMENT, SUBGRADE (PGES) HAS BEEN PROVIDED AT THE LOCATIONS INDICATED FOR SOILS WHICH TEND TO BE UNSTABLE WHEN WET. THE ACTUAL NEED FOR REMOVAL AND REPLACEMENT WITH PGES WILL BE DETERMINED IN THE FIELD AT THE TIME OF CONSTRUCTION WITH THE IDOT SUBGRADE MANUAL. IF UNSTABLE SOILS ARE ENCOUNTERED, THE SOILS SHALL BE REMOVED AND REPLACED WITH PGES. IF UNSTABLE SOILS ARE NOT ENCOUNTERED, THEN THE QUANTITY WILL BE DEDUCTED AND NO ADDITIONAL COMPENSATION WILL BE DUE THE CONTRACTOR.

THE LIMITS OF UNSTABLE SOILS AT THE APPROXIMATE LOCATIONS AS FOLLOWS:

STA TO STA	ESTIMATED UNDERCUT BELOW DESIGN SUBGRADE
26+82 TO 29+85	12" FOR FULL WIDTH
32+25 TO 33+75	EXCAVATE TO ELEV 785
33+75 TO 37+50	EXCAVATE TO ELEV 787
39+88 TO 42+63	10" FOR FULL WIDTH
0+00 TO 3+24	10" FOR FULL WIDTH
2+75 TO 4+00	EXCAVATE TO ELEV 787
6+09 TO 8+78	12" FOR FULL WIDTH
14+69 TO 17+37	10" FOR FULL WIDTH

40  
+  
00

40  
+  
00

39  
+  
50

39  
+  
50

39  
+  
39

39  
+  
39

39  
+  
00

39  
+  
00

150 140 130 120 110 100 90 80 70 60 50 40 30 20 10 0 10 20 30 40 50 60 70 80 90 100 110 120 130 140 150

**CIVILTECH**  
 450 E Devon Ave, Suite 300  
 Itasca, Illinois 60143  
 Tel: 630.773.3900 Fax: 630.773.3975  
 www.civiltechinc.com

DESIGNED - JRR	REVISED -
DRAWN - JRR	REVISED -
CHECKED - RTM	REVISED -
DATE - 10/24/2011	REVISED -

**STATE OF ILLINOIS**  
**DEPARTMENT OF TRANSPORTATION**

VERT. 0 5 10  
 HORIZ. 0 10 20

SCALES

**CROSS SECTIONS - QUENTIN ROAD**

SHEET NO. 11 OF 36 SHEETS STA. 39+00 TO STA. 40+00

F.A.U. RTE.	SECTION	COUNTY	TOTAL SHEETS	SHEET NO.
364	02-00051-08-WR	LAKE	188	154
FED. ROAD DIST. NO. 1 ILLINOIS FED. AID PROJECT			CONTRACT NO. 63649	