

NOTES

- SOME LOCATIONS HAVE MULTIPLE TREE PLANTINGS. SEE STREET TREE PLANTING LEGEND FOR DETAIL.
- CONTRACTOR SHALL WORK DIRECTLY WITH CITY OF EVANSTON STAFF TO FIELD LOCATE ALL TREE PLANTINGS PRIOR TO INSTALLATION.

STREET TREE PLANTING LEGEND

LOCATION ID NO.	SUB ID NO.	ADJACENT ADDRESS	SITE LOCATION	SCIENTIFIC NAME	SIZE	REMARKS
2-001	A	2600 RIDGE AVE	A3	GINKGO BILOBA 'AUTUMN GOLD'	2-1/2"	ON CENTRAL
	B	2600 RIDGE AVE	A4	ULMUS CARPINIFOLIA MORTON	2-1/2"	ON CENTRAL
	C	2600 RIDGE AVE	A5	AESCLUSUS FLAVA	2-1/2"	ON CENTRAL
	D	2600 RIDGE AVE	A6	ULMUS CARPINIFOLIA MORTON	2-1/2"	ON CENTRAL
	E	2600 RIDGE AVE	A7	AESCLUSUS FLAVA	2-1/2"	ON CENTRAL
	F	2600 RIDGE AVE	A8	GINKGO BILOBA	2-1/2"	ON CENTRAL
2-002		2300 GREEN BAY RD	A6	AESCLUSUS FLAVA	2-1/2"	ON McCORMICK NEAR PRAIRIE
2-003		2213 RIDGE AVE	F3	AESCLUSUS GLABRA	2-1/2"	BETWEEN 2213 AND 2223 RIDGE AVE
2-004		2201 RIDGE AVE	F1	ULMUS CARPINIFOLIA MORTON	2-1/2"	
2-005		2033 SHERMAN AVE	F1	GINKGO BILOBA 'AUTUMN GOLD'	2-1/2"	
2-006	A	GREEN BAY RD	M1	GINKGO BILOBA	2-1/2"	GREEN BAY AND RIDGE, S OF EMERSON, IN MEDIAN, AT N END
	B	GREEN BAY RD	M1	GINKGO BILOBA 'AUTUMN GOLD'	2-1/2"	
	C	GREEN BAY RD	M1	GINKGO BILOBA	2-1/2"	
2-007		1133 EMERSON ST	A1	CELTIS OCCIDENTALIS	2-1/2"	ON RIDGE
2-008	A	1890 MAPLE AVE	T2	ULMUS CARPINIFOLIA MORTON	2-1/2"	ON EMERSON
	B	1890 MAPLE AVE	T4	ULMUS CARPINIFOLIA MORTON	2-1/2"	ON EMERSON
2-009	A	1629 CHURCH ST	F1	GINKGO BILOBA 'AUTUMN GOLD'	2-1/2"	
	B	1629 CHURCH ST	F2	AESCLUSUS FLAVA	2-1/2"	
2-010		1738 CHICAGO AVE	F3	CELTIS OCCIDENTALIS	2-1/2"	
2-011	A	1715 CHICAGO AVE	F8	ULMUS CARPINIFOLIA MORTON	2-1/2"	
	B	1715 CHICAGO AVE	F10	AESCLUSUS GLABRA	2-1/2"	
2-012	A	2750 SHERIDAN RD	F1	PLATANUS ACERIFOLIA 'BLOODGOOD'	2-1/2"	
	B	2750 SHERIDAN RD	F2	CELTIS OCCIDENTALIS	2-1/2"	
	C	2750 SHERIDAN RD	F3	AESCLUSUS FLAVA	2-1/2"	
2-013		2668 SHERIDAN RD	F1	CORNUS MAS	2"	
2-014		2603 SHERIDAN RD	F1	PLATANUS ACERIFOLIA 'BLOODGOOD'	2-1/2"	N OF ENTRANCE DRIVE
2-015		2133 SHERIDAN RD	F4	CELTIS OCCIDENTALIS	2-1/2"	
2-016	A	2121 SHERIDAN RD	F1	PLATANUS ACERIFOLIA 'BLOODGOOD'	2-1/2"	
	B	2121 SHERIDAN RD	F2	AESCLUSUS GLABRA	2-1/2"	
2-017	A	1701 SHERIDAN RD	F17	PLATANUS ACERIFOLIA 'BLOODGOOD'	2-1/2"	CENTENNIAL PARK, JUST S OF CHURCH STREET
	B	1701 SHERIDAN RD	F18	CELTIS OCCIDENTALIS	2-1/2"	CENTENNIAL PARK, JUST S OF CHURCH STREET
	C	1701 SHERIDAN RD	F19	AESCLUSUS GLABRA	2-1/2"	CENTENNIAL PARK, JUST S OF CHURCH STREET
	D	1701 SHERIDAN RD	F20	PLATANUS ACERIFOLIA 'BLOODGOOD'	2-1/2"	CENTENNIAL PARK, JUST S OF CHURCH STREET
	E	1701 SHERIDAN RD	F24	ULMUS CARPINIFOLIA MORTON	2-1/2"	CENTENNIAL PARK, JUST S OF CHURCH STREET
	F	1701 SHERIDAN RD	F7	AESCLUSUS FLAVA	2-1/2"	CENTENNIAL PARK, JUST N OF CHURCH STREET

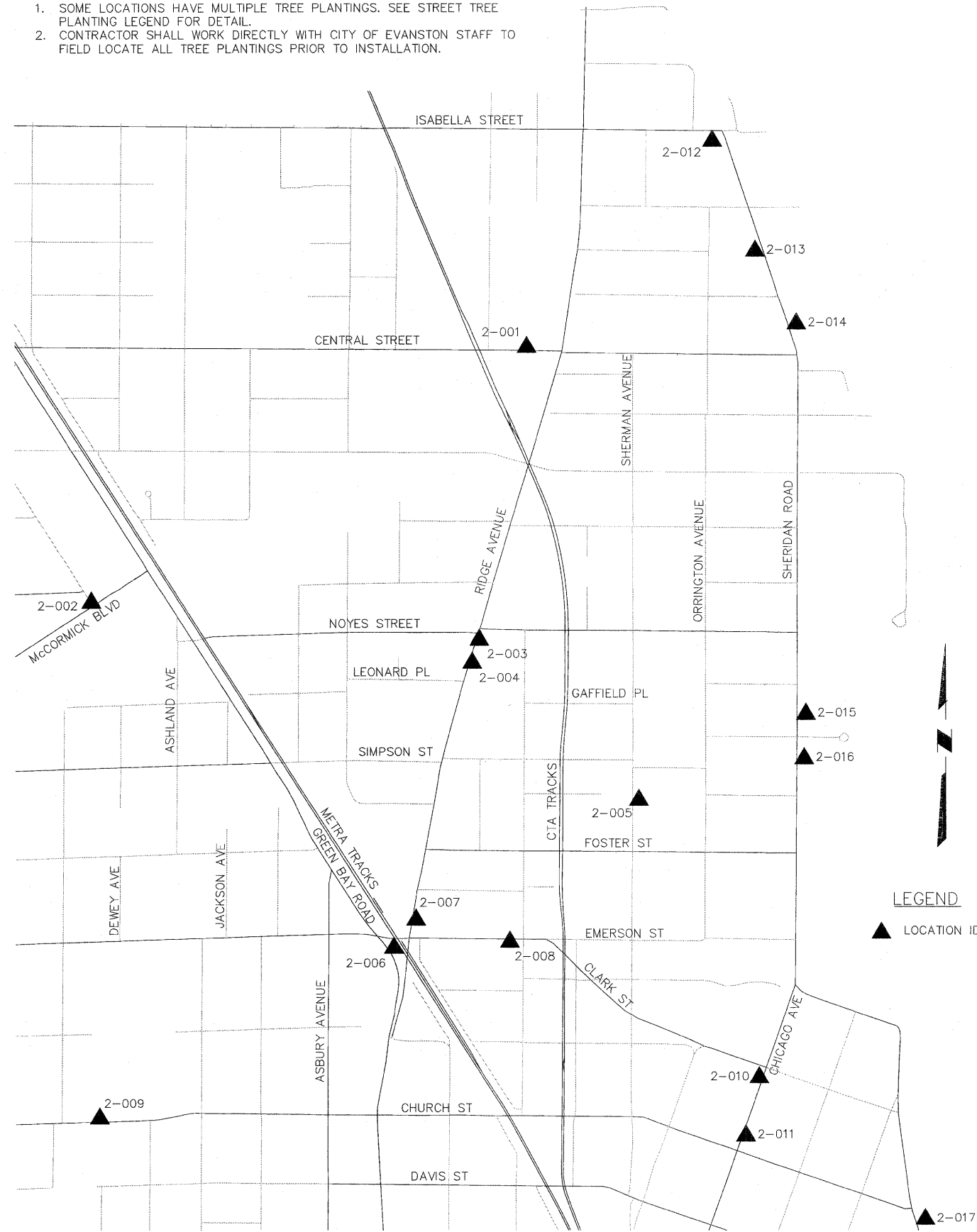

LEGEND
 ▲ LOCATION IDENTIFICATION NUMBER

PLANS PREPARED BY:  CITY OF EVANSTON
 DEPARTMENT OF PARKS, RECREATION AND COMMUNITY SERVICES
 PHONE: (847) 448-8043

DESIGNED -- SDL	REVISED 03 / 26 / 2012
DRAWN -- SDL	REVISED 04 / 03 / 2012
CHECKED -- PD	REVISED --
DATE -- 01 / 10 / 2012	REVISED --

STATE OF ILLINOIS
 DEPARTMENT OF TRANSPORTATION

PROPOSED PLAN - AREA 2
 EVANSTON ITEP TREE REPLACEMENTS

SCALE: 1"= 500' SHEET NO. OF 8 SHEETS STA. N.A. TO STA. N.A.

F.A.U. RTE.	SECTION	COUNTY	TOTAL SHEETS	SHEET NO.
N/A	10-00257-00-LS	COOK	8	6
CONTRACT NO. 63702			ILLINOIS FED. AID PROJECT	