

STATE OF ILLINOIS

DEPARTMENT OF TRANSPORTATION

DIVISION OF HIGHWAYS

PLANS FOR PROPOSED
FEDERAL AID HIGHWAY

F.A.U. ROUTE 204 (HIGHLAND ROAD)
LAKE STREET TO IL ROUTE 83 (BARRON BLVD)
ROADWAY REHABILITATION
VILLAGE SECTION 12-00060-00-WR
PROJECT NO. M-9003(949)
JOB NO. C-91-232-12
VILLAGE OF GRAYSLAKE
LAKE COUNTY

F.A.U. RTE.	SECTION	COUNTY	TOTAL SHEETS	SHEET NO.
204	12-00060-00-WR	LAKE	50	1
		ILLINOIS	CONTRACT NO. 63712	

INDEX OF SHEETS

SHEET No.	DESCRIPTION
1	COVER SHEET
2	GENERAL NOTES
3	SUMMARY OF QUANTITIES
4	EARTHWORK SCHEDULE
5	TYPICAL SECTIONS
6	ALIGNMENT TIES AND BENCHMARKS
7	MAINTENANCE OF TRAFFIC AND DETOUR PLAN
8-10	EXISTING CONDITIONS AND REMOVAL PLAN
11-15	ROADWAY PLAN AND PROFILE
16-20	DRAINAGE PLAN AND PROFILE AND UTILITIES
21-23	EROSION AND SEDIMENT CONTROL PLANS AND NOTES
24	SOIL BORING LOGS
25	CONSTRUCTION DETAILS
26-44	CROSS SECTIONS
45	BD400-04 - PAVEMENT PATCHING FOR HMA SURFACED PAVEMENT
46	BD400-05 - BUTT JOINT AND HMA TAPER DETAILS
47	BD600-04 - MANHOLE WITH RESTRICTOR PLATE
48	BD-36 - FIRE HYDRANT TO BE MOVED
49	TC-10 - TRAFFIC CONTROL AND PROTECTION FOR SIDE ROADS, INTERSECTIONS, AND DRIVEWAYS
50	TC-13 - DISTRICT 1 TYPICAL PAVEMENT MARKINGS

STATE STANDARDS

STANDARD SYMBOLS, ABBREVIATIONS AND PATTERNS	
000001-06	STANDARD SYMBOLS, ABBREVIATIONS AND PATTERNS
424011	CORNER PARALLEL CURB RAMPS FOR SIDEWALKS
424021	DEPRESSED CORNER FOR SIDEWALKS
442201-03	CLASS C AND D PATCHES
602001-02	CATCH BASIN TYPE A
602011-02	CATCH BASIN TYPE C
602301-03	INLET TYPE A
602401-03	MANHOLE TYPE A
602601-02	PRECAST REINFORCED CONCRETE FLAT SLAB TOP
602701-02	MANHOLE STEPS
604001-03	FRAME AND LIDS TYPE 1
606001-04	CONCRETE CURB TYPE B AND COMBINATION CONCRETE CURB AND GUTTER
701301-04	LANE CLOSURE, 2L, 2W, SHORT TIME OPERATIONS
701311-03	LANE CLOSURE, 2L, 2W, MOVING OPERATIONS - DAY ONLY
701501-06	URBAN LANE CLOSURE, 2L, 2W, UNDIVIDED
701901-02	TRAFFIC CONTROL DEVICES
780001-03	TYPICAL PAVEMENT MARKINGS

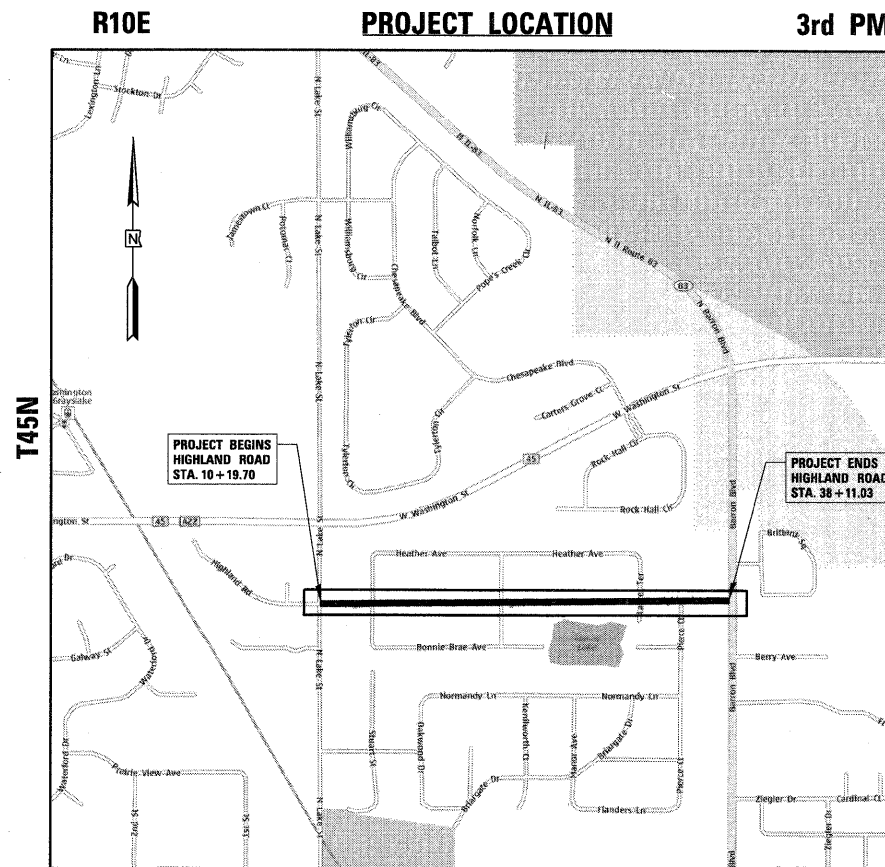

TRAFFIC DATA:
2009 ADT = 1105 (WEST) AND 2270 (EAST)
2040 ADT = 2,000-4,000 VEHICLES
POSTED SPEED LIMIT = 25 MPH
FUNCTIONAL CLASSIFICATION = COLLECTOR

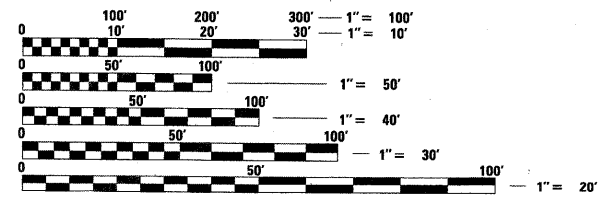

FULL SIZE PLANS HAVE BEEN PREPARED USING STANDARD ENGINEERING SCALES. REDUCED SIZED PLANS WILL NOT CONFORM TO STANDARD SCALES. IN MAKING MEASUREMENTS ON REDUCED PLANS, THE ABOVE SCALES MAY BE USED.

J.U.L.I.E.
JOINT UTILITY LOCATION INFORMATION FOR EXCAVATION
1-800-892-0123
OR 811

SCALE 1" = APPROX 650 FT
GROSS LENGTH = 2792 FT. = 0.53 MILE
NET LENGTH = 2792 FT. = 0.53 MILE

STATE OF ILLINOIS
DEPARTMENT OF TRANSPORTATION
DIVISION OF HIGHWAYS

APPROVED March 23, 2012
William Fleming
DIRECTOR OF PUBLIC WORKS, VILLAGE OF GRAYSLAKE

PASSED APRIL 4, 2012
Cheryl C. Holt
DISTRICT 1 ENGINEER OF LOCAL ROADS AND STREETS

RELEASING FOR BID BASED ON LIMITED REVIEW APRIL 4, 2012
Diane M. O'Keefe
DEPUTY DIRECTOR OF HIGHWAYS, REGION ONE ENGINEER



March 23, 2012
Stephen N. Sugg
STEPHEN N. SUGG
ILLINOIS REGISTRATION No. 062-044117
EXPIRATION DATE: 11/30/13

PRINTED BY THE AUTHORITY
OF THE STATE OF ILLINOIS

CHRISTOPHER B. BURKE ENGINEERING LTD.
8576 West Higgins Road, Suite 600
Rosemont, Illinois 60018
(631) 823-0900

PROGRAM AND OFFICE ENGINEER: CHARLES F. RIDDLE, P.E. (847) 705-4406 SCHAUMBURG, IL

CONTRACT NO. 63712

N:\graylake\110235\Civil\CVR_HIGHLAND.sht