

IL ROUTE 2  
STA. 262+94.74 - STA. 270+24.34

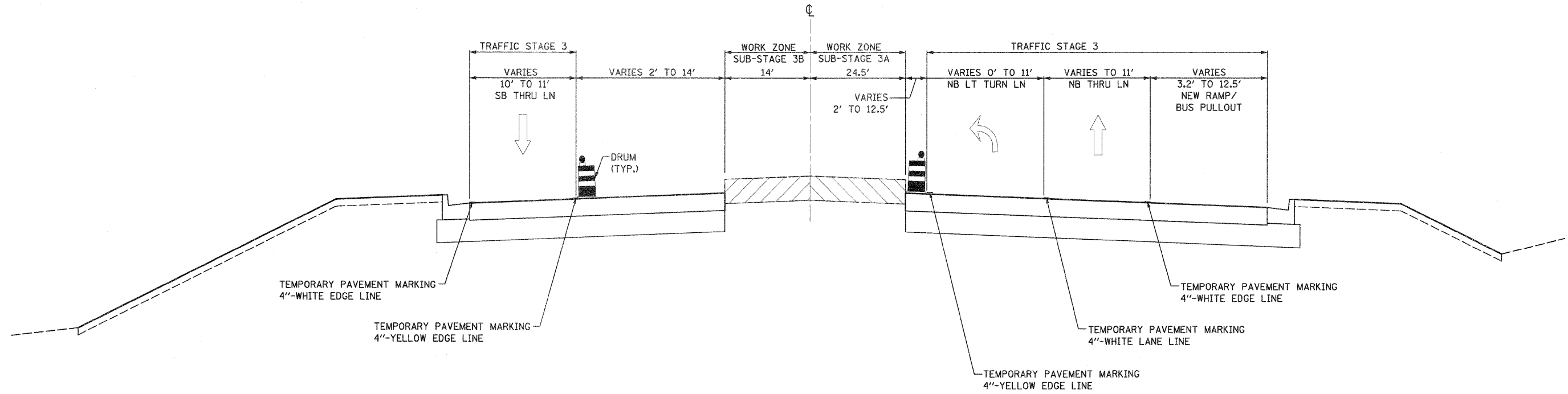

IL ROUTE 2  
STA. 277+50.00 - STA. 282+26.26

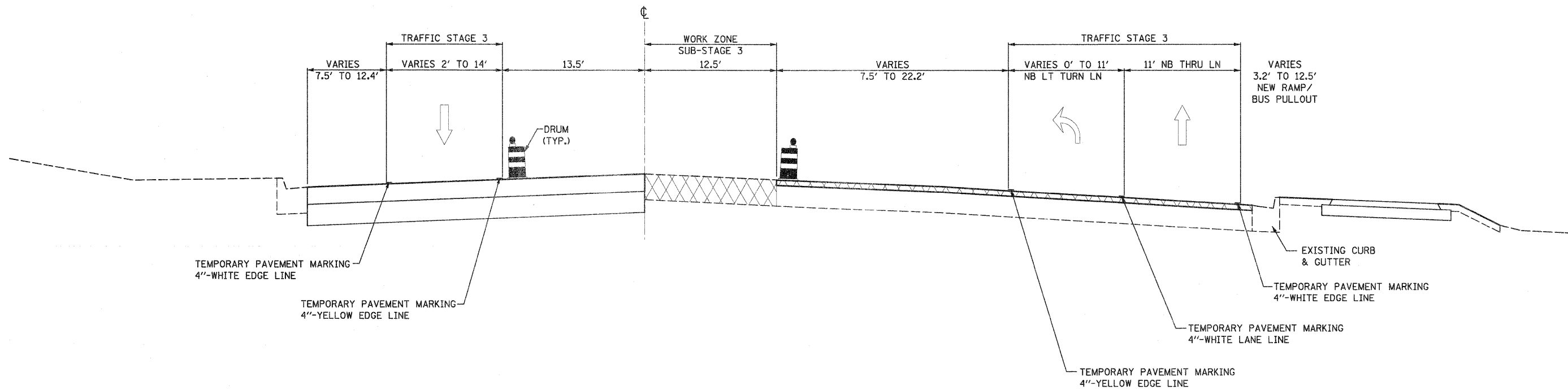

FILE NAME = D201500-eh-t-staging22_typical17.dgn	USER NAME = TERRA	DESIGNED - BCB	REVISÉD -	<b>STATE OF ILLINOIS DEPARTMENT OF TRANSPORTATION</b>	<b>MAINTENANCE OF TRAFFIC STAGE III TYPICAL SECTIONS</b>			F.A. RTE. 742	SECTION 34R	COUNTY WINNEBAGO	TOTAL SHEETS 491	SHEET NO. 107
	PLOT SCALE = 10.0000' / 1" IN.	DRAWN - CVM	REVISÉD -		SCALE:	SHEET NO.	OF	SHEETS	STA.	TO STA.	ILLINOIS FED. AID PROJECT CONTRACT NO. 64515	
	PLOT DATE = 1/16/2012	CHECKED - DPA	REVISÉD -									
		DATE - 01/17/12	REVISÉD -									