

THE STAGE 1A2 LANE CLOSURE OF SPRINGFIELD AVENUE WEST OF IL 2 SHALL BE PAID AS A COMPONENT OF THE LUMP SUM FOR TRAFFIC CONTROL AND PROTECTION, STANDARD 701606.

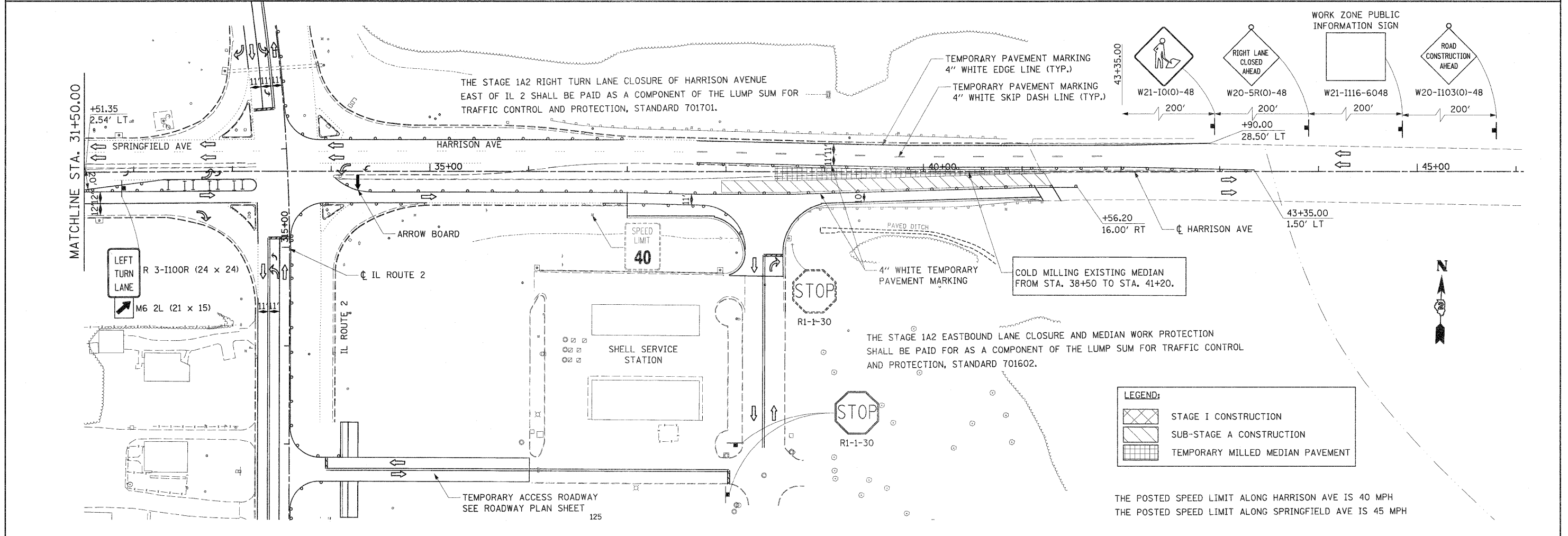
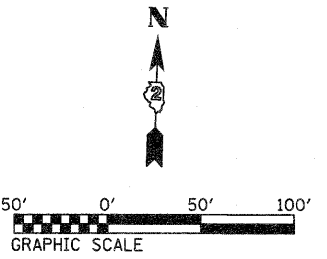

THE STAGE 1A2 RIGHT TURN LANE CLOSURE OF HARRISON AVENUE EAST OF IL 2 SHALL BE PAID AS A COMPONENT OF THE LUMP SUM FOR TRAFFIC CONTROL AND PROTECTION, STANDARD 701701.

THE STAGE 1A2 EASTBOUND LANE CLOSURE AND MEDIAN WORK PROTECTION SHALL BE PAID FOR AS A COMPONENT OF THE LUMP SUM FOR TRAFFIC CONTROL AND PROTECTION, STANDARD 701602.

LEGEND:

	STAGE I CONSTRUCTION
	SUB-STAGE A CONSTRUCTION
	TEMPORARY MILLED MEDIAN PAVEMENT

THE POSTED SPEED LIMIT ALONG HARRISON AVE IS 40 MPH
THE POSTED SPEED LIMIT ALONG SPRINGFIELD AVE IS 45 MPH

FILE NAME = D201508-shr-staging@0.dgn	USER NAME = TERRA	DESIGNED - BCB	REVISED -	STATE OF ILLINOIS DEPARTMENT OF TRANSPORTATION	MAINTENANCE OF TRAFFIC PLAN STAGE I AND SUB-STAGE A2			F.A. RTE. 742	SECTION 34R	COUNTY WINNEBAGO	TOTAL SHEETS 491	SHEET NO. 120
	PLOT SCALE = 50.0000' / IN.	DRAWN - CBC	REVISED -		SCALE: 1" = 50'	SHEET NO. 10 OF 10 SHEETS	STA.	TO STA.	CONTRACT NO. 64515			
	PLOT DATE = 1/16/2012	CHECKED - DPA	REVISED -		ILLINOIS FED. AID PROJECT							
		DATE - 01/17/12	REVISED -									