

NOTE:
THE NORTHBOUND AND SOUTHBOUND IL RTE 2 LANE CLOSURES FROM THE SOUTH PROJECT LIMIT TO STA. 263+00 SHALL BE PAID FOR ON A LUMP SUM BASIS AS TRAFFIC CONTROL AND PROTECTION, STANDARD 701422, INCLUDING THE MODIFIED APPROACH SIGNAGE AND SIGN SPACING.

NOTE:
PLACE MESSAGE BOARD FROM BEGINNING OF STAGE 2 AND KEEP IN PLACE FOR 2 WEEKS

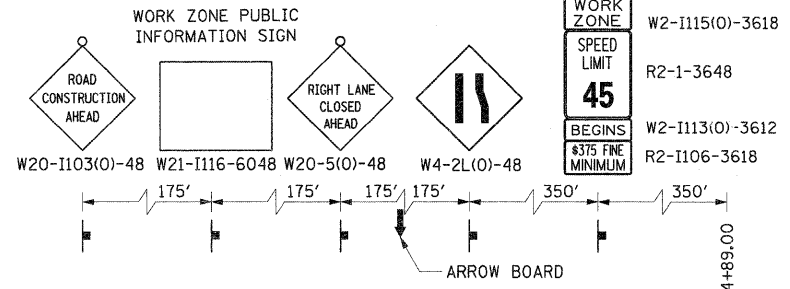

WORK ZONE
W2-I115(O)-3618
SPEED LIMIT
R2-1-3648
BEGINS
W2-I113(O)-3612
R2-I106-3618

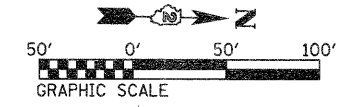
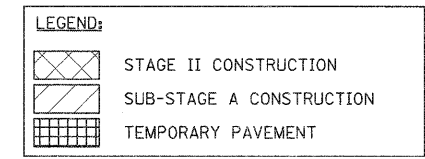
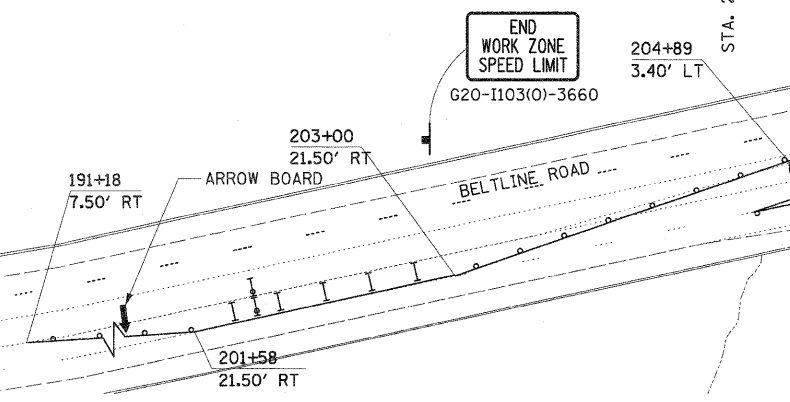
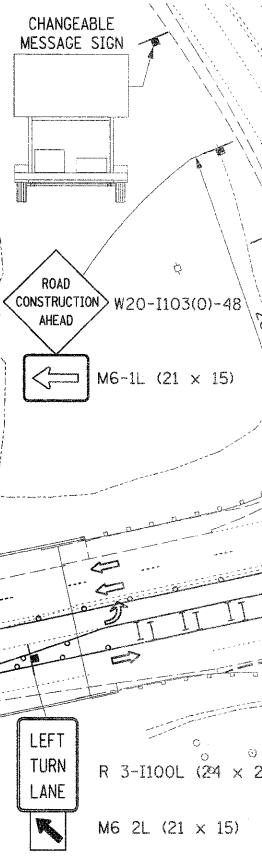

SEE SHEET 138

NOTE:
1. TRAFFIC CONTROL AND PROTECTION FOR PAVEMENT WIDENING ALONG THE WEST LEG OF PELLEY ROAD SHALL BE PAID FOR AS TRAFFIC CONTROL AND PROTECTION, STANDARD 701326.

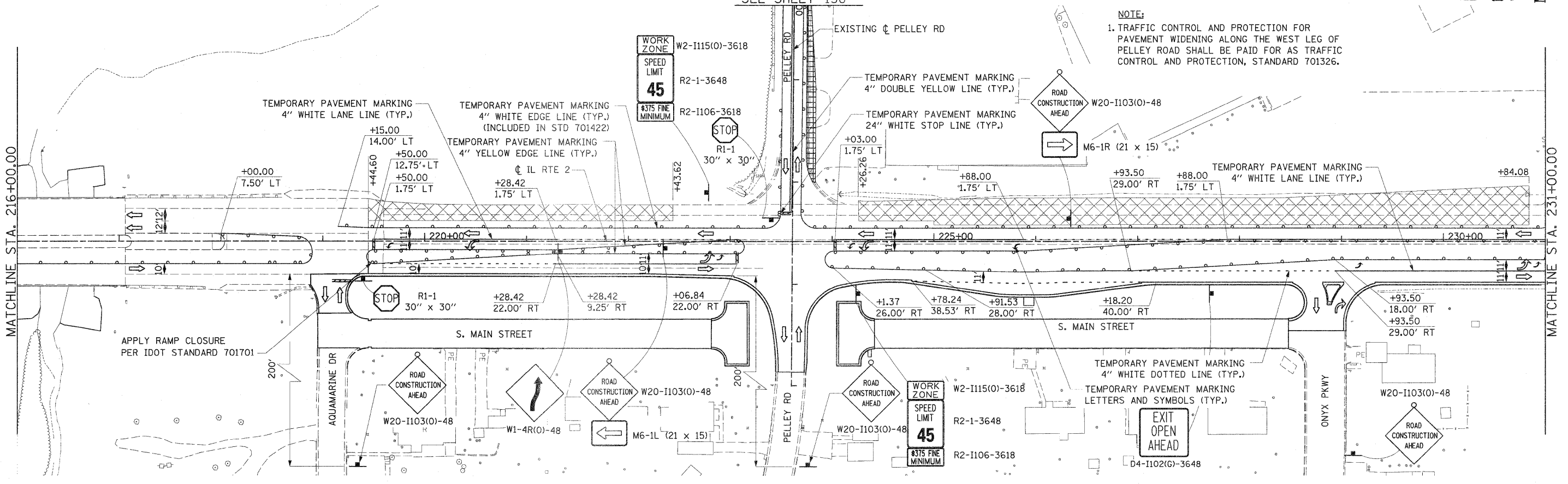

FILE NAME = 02201500-sh1-staging19.dgn
USER NAME = TERRA

DESIGNED - KJC
DRAWN - CBC
CHECKED - DPA
DATE - 01/17/12

REVISER -
REVISION -
REVISION -
REVISION -

**STATE OF ILLINOIS
DEPARTMENT OF TRANSPORTATION**

**MAINTENANCE OF TRAFFIC PLAN
STAGE II AND SUB-STAGE A**

SCALE: 1" = 50' SHEET NO. 1 OF 9 SHEETS STA. TO STA. 231+00.00

F.A. RTE. 742	SECTION 34R	COUNTY WINNEBAGO	TOTAL SHEETS 491	SHEET NO. 130
ILLINOIS FED. AID PROJECT			CONTRACT NO. 64515	