

APPLY IDOT STANDARD 701411, APPLICATION NO. 4 FOR THE MODIFIED EXIT RAMP FOR OUTSIDE LANE CLOSURE. THIS WORK SHALL BE PAID FOR AS TRAFFIC CONTROL AND PROTECTION, STANDARD 701411.

APPLY IDOT STANDARD 701411, APPLICATION NO. 2 FOR THE MODIFIED ENTRANCE RAMP FOR OUTSIDE LANE CLOSURE. THIS WORK SHALL BE PAID FOR AS TRAFFIC CONTROL AND PROTECTION, STANDARD 701411.

APPLY IDOT STANDARD 701411, APPLICATION NO. 1 FOR THE MODIFIED ENTRANCE RAMP. THIS WORK SHALL BE PAID FOR AS TRAFFIC CONTROL AND PROTECTION, STANDARD 701411.

APPLY IDOT STANDARD 701411, APPLICATION NO. 3 FOR THE MODIFIED EXIT RAMP. THIS WORK SHALL BE PAID FOR AS TRAFFIC CONTROL AND PROTECTION, STANDARD 701411.

APPLY IDOT STANDARD 701411, APPLICATION NO. 2 FOR THE MODIFIED ENTRANCE RAMP E. THIS WORK SHALL BE PAID FOR AS TRAFFIC CONTROL AND PROTECTION, STANDARD 701411.

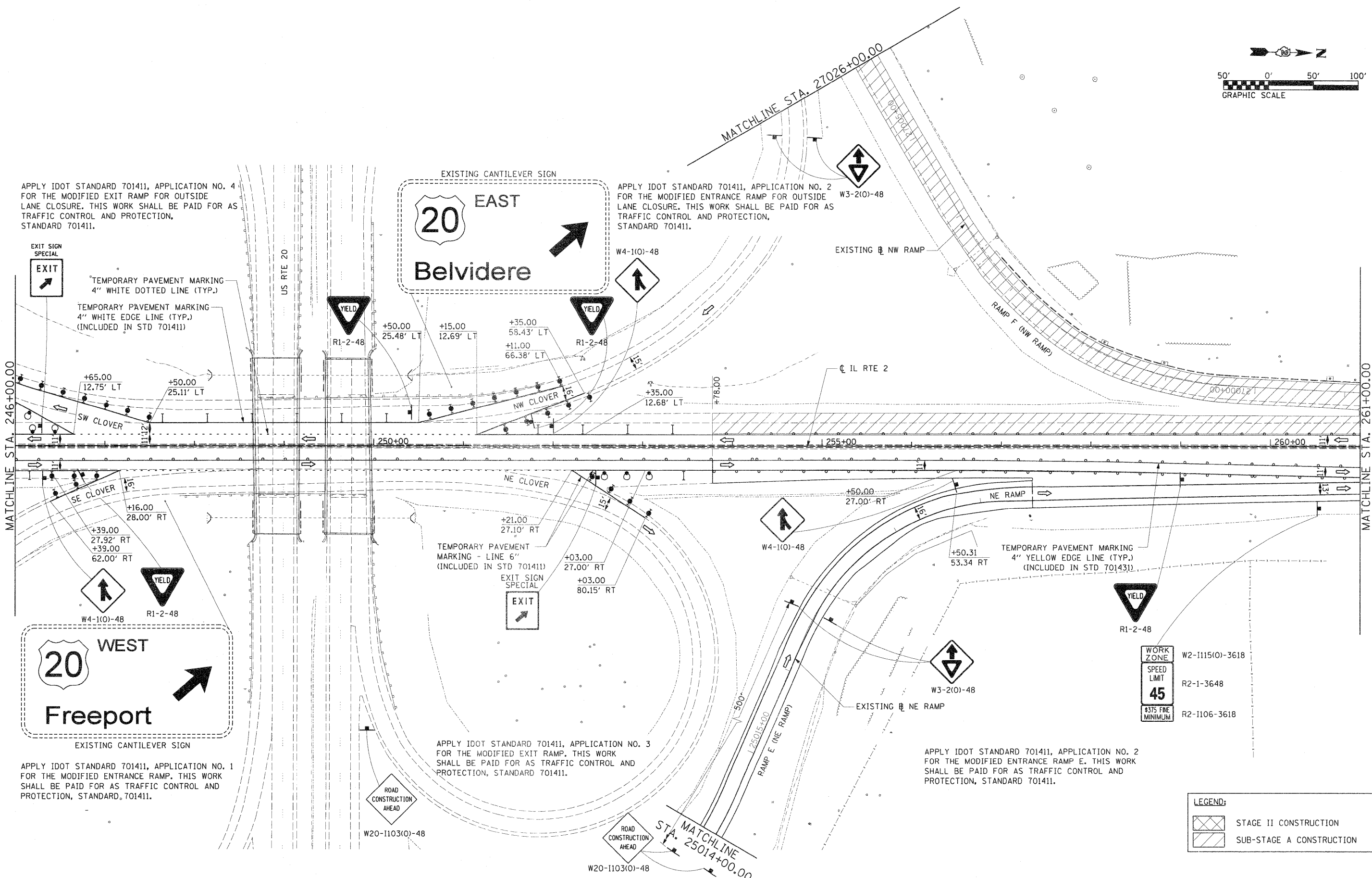
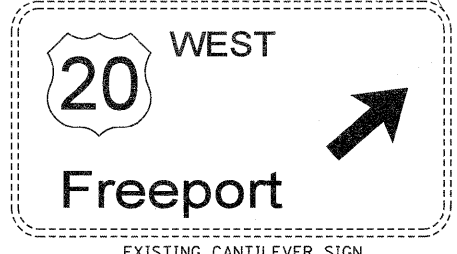
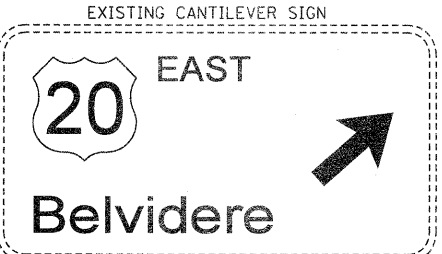

WORK ZONE	W2-1115(0)-3618
SPEED LIMIT	R2-1-3648
45	
#375 FINE MINIMUM	R2-1106-3618

LEGEND:	
	STAGE II CONSTRUCTION
	SUB-STAGE A CONSTRUCTION

FILE NAME = 0201502-sht-staging21.dgn	USER NAME = TERRA	DESIGNED - KJC	REVISED -	STATE OF ILLINOIS DEPARTMENT OF TRANSPORTATION	MAINTENANCE OF TRAFFIC PLAN STAGE II AND SUB-STAGE A	F.A. RTE. 742	SECTION 34R	COUNTY WINNEBAGO	TOTAL SHEETS 491	SHEET NO. 132	
PLOT SCALE = 50.0000' / IN.	CHECKED - DPA	REVISOR -	REVISOR -			SCALE: 1" = 50'		SHEET NO. 3 OF 9 SHEETS		STA. 246+00.00 TO STA. 261+00.00	
PLOT DATE = 1/16/2012	DATE - 01/17/12	REVISOR -	REVISOR -			CONTRACT NO. 64515					
						ILLINOIS FED. AID PROJECT					