

- NOTES:
1. APPLY EASTBOUND SPRINGFIELD AVENUE LEFT LANE CLOSURE APPROACHING THE PRAIRIE ROAD INTERSECTION PER IDOT STD 701602.
  2. APPLY ADVANCE ROAD CLOSURE SIGNING ALONG EASTBOUND SPRINGFIELD AVENUE FOR THE CLOSURE OF SPRINGFIELD AVENUE PER DISTRICT 2 STD 40.1.
  3. APPLY WESTBOUND HARRISON AVENUE LEFT LANE CLOSURE PER IDOT STD 701601.
  4. APPLY ADVANCE ROAD CLOSURE SIGNING ALONG WESTBOUND HARRISON AVENUE PER DISTRICT STD 40.1.
  5. SEE STAGE 2A SPRINGFIELD AVENUE CLOSURE DETAIL PLAN FOR DETOUR SIGNING.
  6. THE INSTALLATION AND MAINTENANCE OF ALL ROAD CLOSURE, ASSOCIATED LANE CLOSURE, AND DETOUR SIGNING FOR THE SPRINGFIELD AVENUE CLOSURE SHALL BE PAID AS TRAFFIC CONTROL AND PROTECTION (SPECIAL), LOCATION 3.

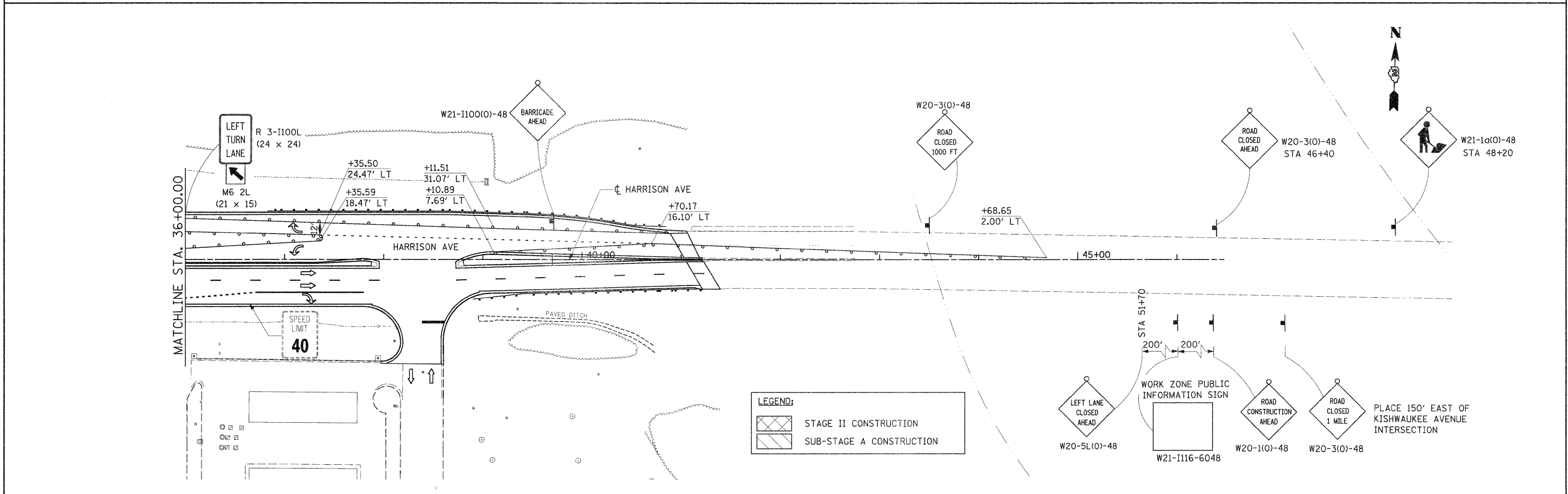

LEGEND:

	STAGE II CONSTRUCTION
	SUB-STAGE A CONSTRUCTION

FILE NAME = D201520-sh-t-staging26.dgn	USER NAME = TERRA	DESIGNED - KJC	REVISED -	<b>STATE OF ILLINOIS DEPARTMENT OF TRANSPORTATION</b>	<b>MAINTENANCE OF TRAFFIC PLAN STAGE II AND SUB-STAGE A</b>	F.A. RTE. 742	SECTION 34R	COUNTY WINNEBAGO	TOTAL SHEETS 491	SHEET NO. 137	
PLOT SCALE = 50.0000' / 1" IN.	CHECKED - DPA	REVISED -	SCALE: 1" = 50'			SHEET NO. 8 OF 9 SHEETS	STA. TO STA.	CONTRACT NO. 64515		ILLINOIS FED. AID PROJECT	
PLOT DATE = 11/17/2012	DATE - 01/17/12	REVISED -									