

NOTE:

1. CONTRACTOR SHALL HAVE OPTION OF PLACING STANDARD MANHOLES IN LIEU OF FLAT SLAB TOPS WHERE CONDITIONS PERMIT.
2. RIM ELEVATIONS & OFFSETS FOR DRAINAGE STRUCTURES CONSTRUCTED IN CONJUNCTION WITH GUTTER OR CURB & GUTTER ARE CALLED OUT TO THE EDGE OF PAVEMENT. ALL OTHER DRAINAGE STRUCTURES ARE CALLED OUT TO THE CENTER OF STRUCTURE.
3. WHERE PROPOSED DRAINAGE STRUCTURES ARE TO BE CONNECTED TO EXISTING STORM SEWERS AND PIPE CULVERTS, THE COST FOR PROVIDING THE CONNECTION SHALL BE INCLUDED IN THE COST OF THE ASSOCIATED DRAINAGE STRUCTURE PAY ITEMS.

PLAN	SURVEYED	DATE
	ALIGNED	
	CHECKED	
	RT. OF WAY	
	CHECKED	
	NO.	
	ADD FILE NAME	

PROFILE	SURVEYED	DATE
	PLotted	
	CHECKED	
	SA. NOTED	
	STRUCTURE	
	NOTATIONS	
	CHKD	

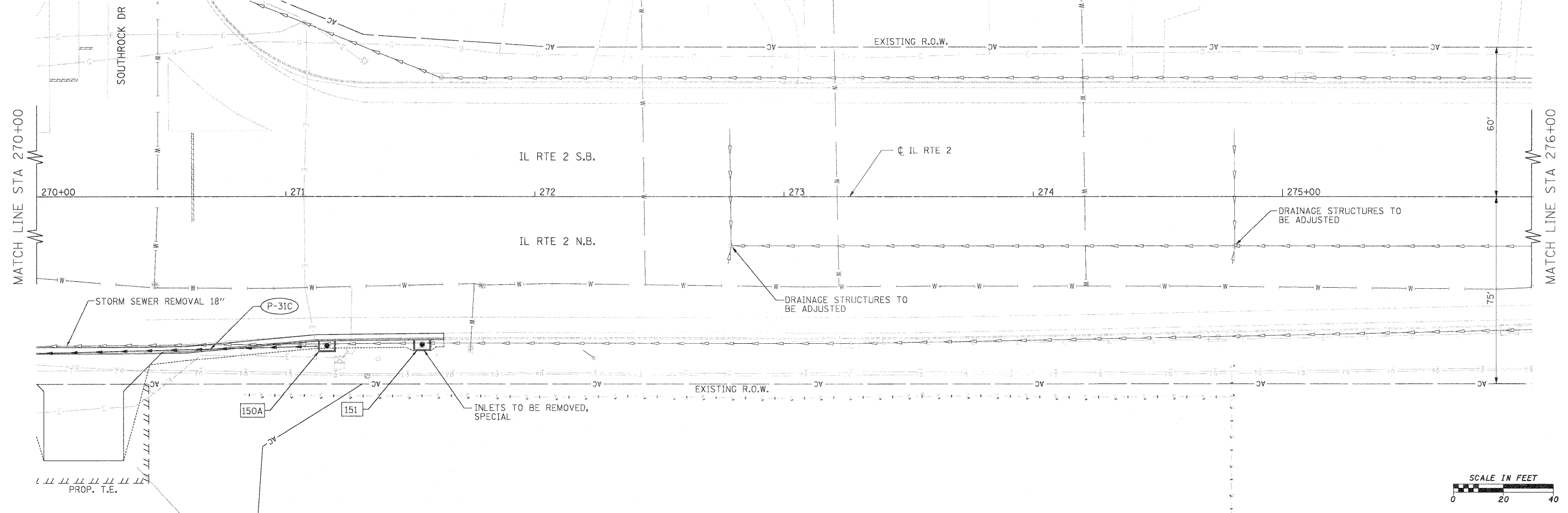

735		735
730		730
725		725
720		720
715		715
710		710

FILE NAME =	USER NAME = #USER*	DESIGNED - GE	REVISED -	STATE OF ILLINOIS DEPARTMENT OF TRANSPORTATION	FAP 742 (IL 2) PROPOSED DRAINAGE PLAN AND PROFILE			F.A.P. RTE. 742	SECTION 34R	COUNTY WINNEBAGO	TOTAL SHEETS 491	SHEET NO. 203
#FILE#	PLOT SCALE = #SCALE*	DRAWN - GE	REVISED -		SCALE: 1" = 20'	SHEET NO. 10 OF 30 SHEETS	STA. 270+00	TO STA. 276+00	CONTRACT NO. 64515			
	PLOT DATE = #DATE*	CHECKED - SL	REVISED -		[ILLINOIS] FED. AID PROJECT							
		DATE - 05/2011	REVISED -									