

EAST RETAINING WALL  
STA. 327+52.04 - STA. 329+87.97

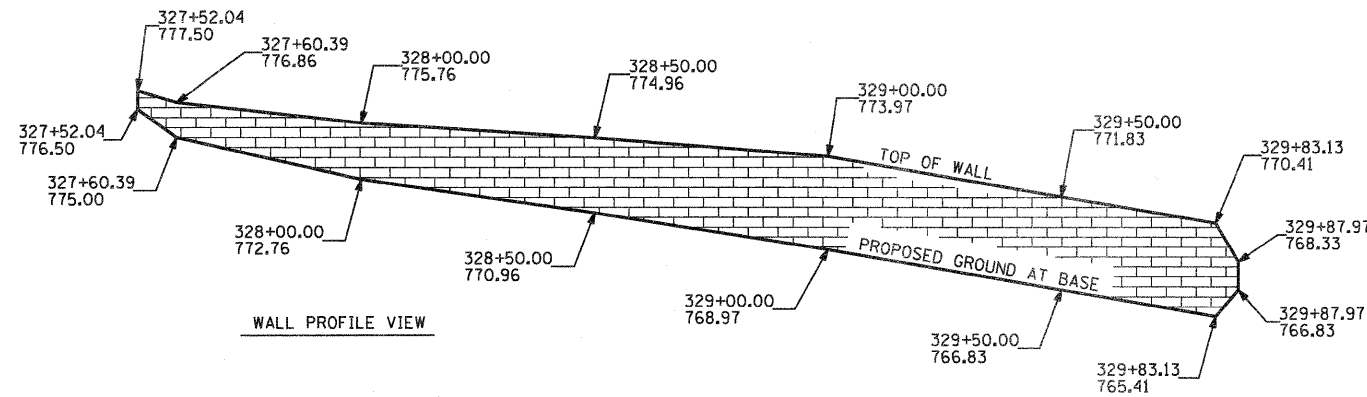

WALL PROFILE VIEW



WEST RETAINING WALL  
STA. 331+02.94 - STA. 332+19.88

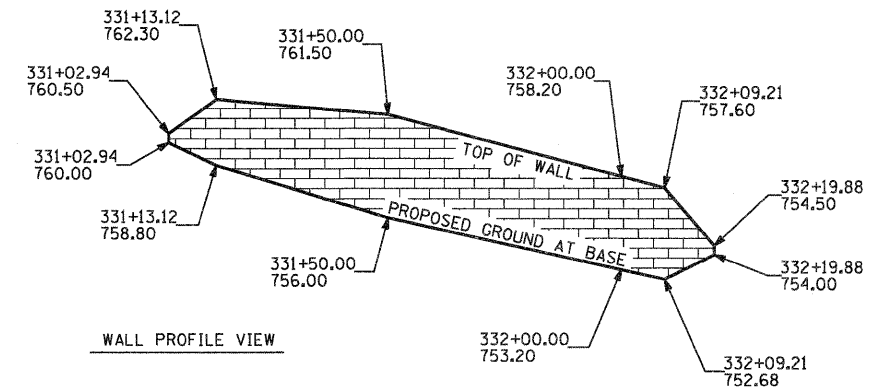

WALL PROFILE VIEW

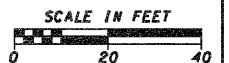
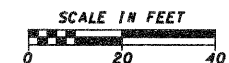
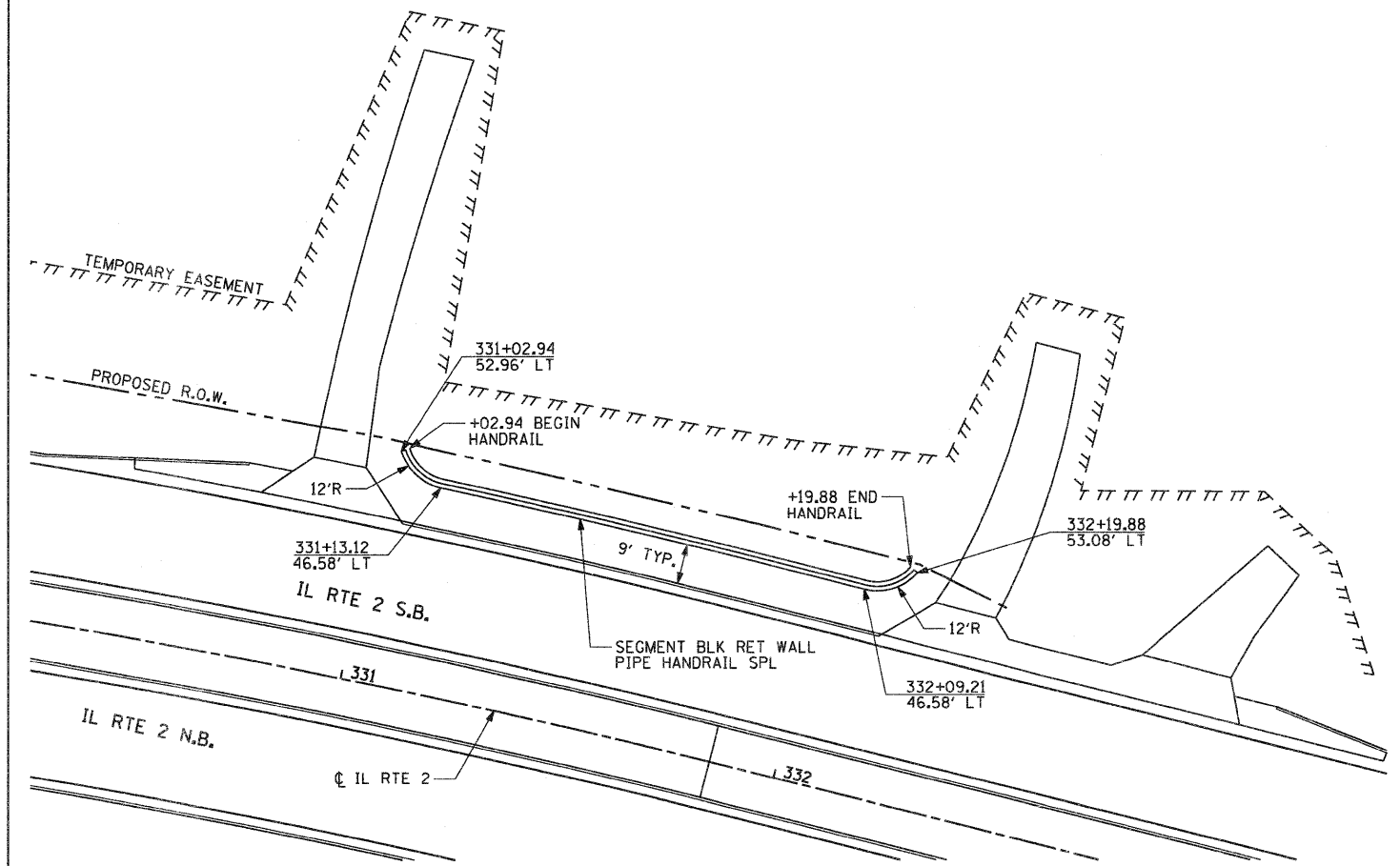
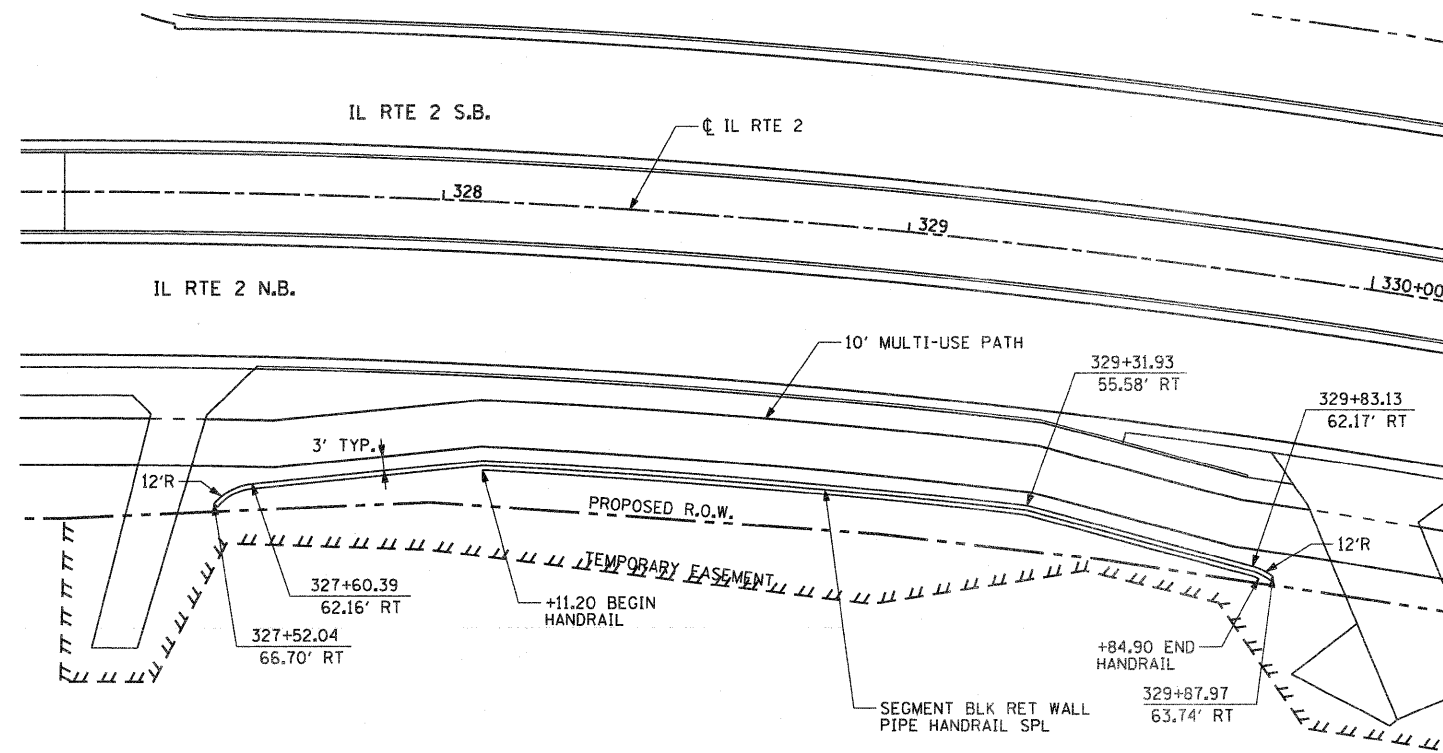

- NOTE:
1. WALL OFFSETS ARE TO THE FACE OF WALL AT PROPOSED GROUND
  2. USE DISTRICT STANDARD 64.2 FOR PIPE HANDRAIL, SPECIAL
  3. DESIGN COMPUTATIONS AND SHOP PLANS MUST BE SUBMITTED AND APPROVED BY THE ENGINEER PRIOR TO CONSTRUCTION
  4. CAP BLOCKS ARE REQUIRED ON THE TOP COURSE OF STANDARD BLOCK
  5. WALL QUANTITIES WERE ESTIMATED ASSUMING 2 FEET BELOW PROPOSED GROUND AT BASE, PAYMENT WILL BE MADE USING ACTUAL MEASURED QUANTITIES
  6. REFER TO SPECIAL PROVISIONS

FILE NAME =	USER NAME = petp	DESIGNED -	REVISED -	<b>STATE OF ILLINOIS DEPARTMENT OF TRANSPORTATION</b>	<b>FAP 742 (IL 2) SEGMENTAL BLOCK RETAINING WALL DETAIL</b>	F.A.P. RTE. =	SECTION	COUNTY	TOTAL SHEETS	SHEET NO.
g:\2010\trans\bl\001\dgn\Details\RETAINING WALL DETAIL.dgn		DRAWN -	REVISED -			742	34R	WINNEBAGO	491	333
PLOT SCALE = 20,0000' / IN.		CHECKED -	REVISED -			CONTRACT NO. 64515				
PLOT DATE = 1/17/2012		DATE -	REVISED -			[ILLINOIS] FED. AID PROJECT				