

TRAFFIC CONTROL FOR TRANSITION AREAS

CASE 3

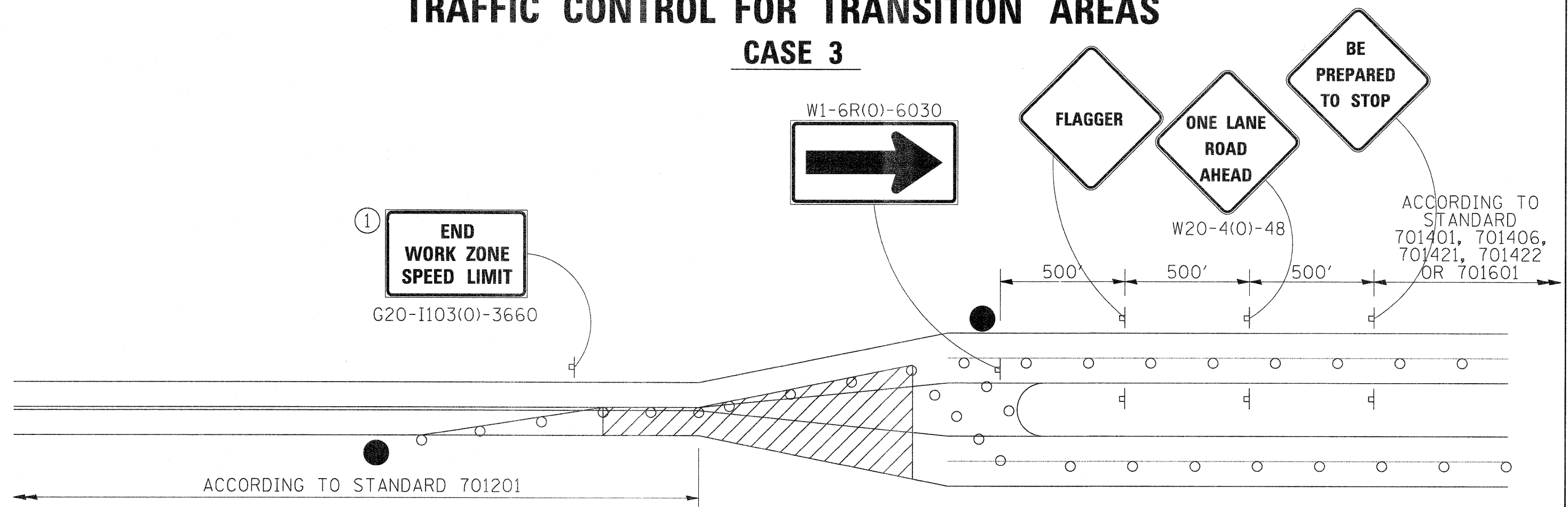

GENERAL NOTES

THIS DETAIL IS TO BE USED IN CONJUNCTION WITH THE APPLICABLE MULTILANE TRAFFIC CONTROL AND PROTECTION STANDARD.

1. If applicable, Use speed limit as shown on applicable multilane Traffic Control and Protection Standard.
2. If the work is within 2500 feet of the transition when the speed is > 40 mph, or 1500 feet for all other speeds, the detail shall be used.
3. WORK ZONE SPEED LIMIT 55 BEGINS shall be replaced with WORK ZONE SPEED LIMIT 45 BEGINS where the workers are within 500 feet of the transition.

THIS TRAFFIC CONTROL DETAIL SHALL BE INCLUDED IN THE COST OF SPECIFIED TRAFFIC CONTROL STANDARDS OR ITEMS.

- FLAGGER WITH TRAFFIC CONTROL SIGN
- DRUMS OR BARRICADES
- WORK AREA

NOTE: STANDARDS 701301 AND 701306 SHALL NOT BE USED WITHIN 500 FEET OF THE TRANSITION.

| | | | | | | | | | | |
|---|-----------------------------|------------|------------------|---|---------------------------------------|--------------------|---------|---------------------------|--------------|-----------|
| FILE NAME = | USER NAME = petp | DESIGNED - | REVISED - 4-4-11 | STATE OF ILLINOIS DEPARTMENT OF TRANSPORTATION | REGION 2 / DISTRICT 2 STANDARD | F.A. RTE. | SECTION | COUNTY | TOTAL SHEETS | SHEET NO. |
| Gr\2010\TRANS\BIB\T00\INDGN\District Standards\District Standards.dgn | PLOT SCALE = 50.0000' / IN. | DRAWN - | REVISED - | | | 742 | 34R | WINNEGAGO | 491 | 348c |
| PLOT DATE = 1/17/2012 | DATE - | CHECKED - | REVISED - | | | CONTRACT NO. 64515 | | ILLINOIS FED. AID PROJECT | | |